

## **FENCE REGULATIONS**

**INSPECTIONS:** An initial inspection is required after the fence layout is completed on the property and before any holes have been dug. This inspection is to verify the layout as it was approved on the fence permit application.

A second inspection will be conducted after the fence holes have been dug. Please call twenty-four (24) hours in advance for your fence inspections.

Verification of property line location is the sole responsibility of the property owner. Buena Vista Charter Township does not purport to know the precise boundaries of any property, nor is any implication made that said property lines will be verified. For this reason, we strongly recommend a professional survey to verify the location of property lines.

**CORNER LOT FENCE REGULATIONS:** A fence, wall, or hedge planting, cannot exceed a height of three feet on the street side without an application for such variance.

**SPECIFICATIONS AND REGULATIONS:** Prior to construction or establishment of a fence, wall, or screen a permit must be obtained from the Community Development Department if the height is to exceed six feet.

Fence, walls or hedge plantings are limited to a maximum height of three feet in the front yard of any residential zoning district. No fence or wall can exceed a height of six feet in a residential zoned district.

Under no circumstances shall barbed wire or similar fencing types that are likely to cause injury to persons, be used in any residential districts.

The issuance or granting of a permit shall not be construed to be a permit for, or an approval of, any violation of the provisions of the fence ordinance. No permit presuming to give authority to violate the provisions of the ordinance shall be valid.

EXAMPLE

Fence Heights:

For a distance of 20 feet from the **front** property line, a **side** and **front** fence cannot exceed three feet; otherwise a fence can be installed to the height of six feet.

NOTE: This illustration is based on a sixty-six (66) foot road right-of-way.

Example 1

Example 2 – Corner Lot

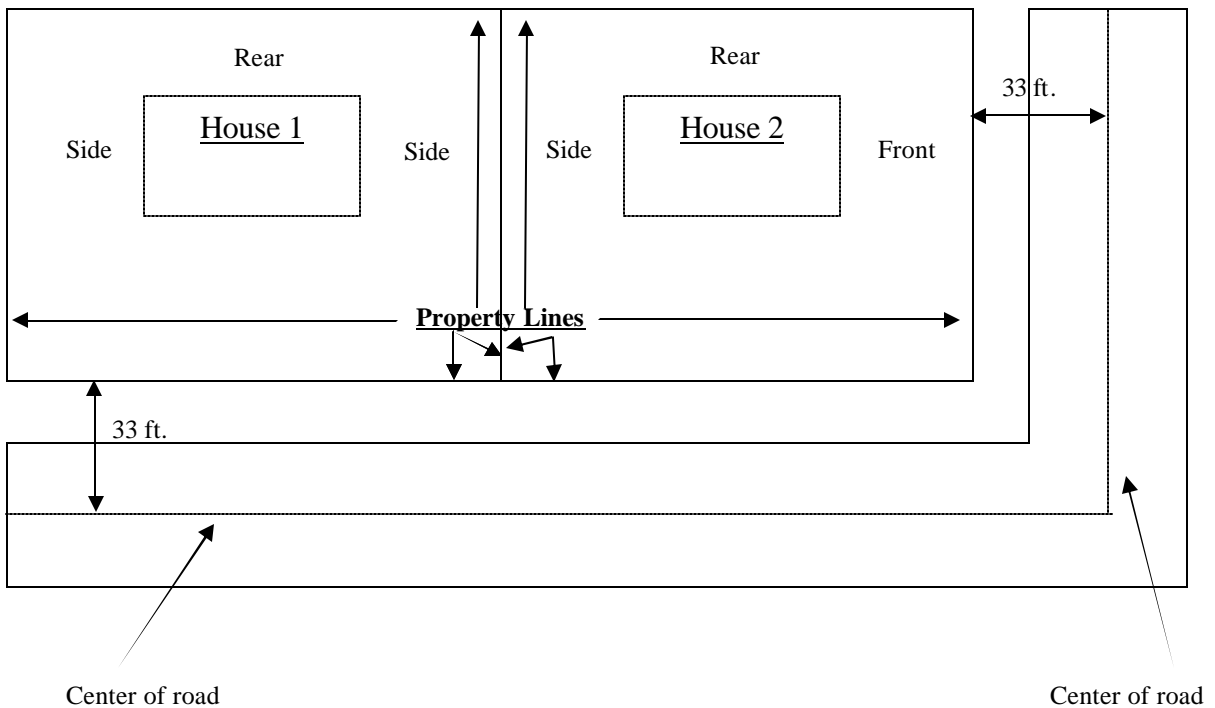

Any questions can be addressed to the Buena Vista Charter Township by calling 989-754-6536.