

PUBLIC NOTICE

PUBLIC SERVICES COMMITTEE MEETING

March 30, 2017 at 8:00 a.m

Harry Hodges Room, 745 Center Street

AGENDA

- 2017 Sanitary Sewer Lining Bids
- Mill and Water Street Intersection Design Services
- Public Works Facility Update
- Tree Rebate Program

BID QUANTITY SHEET

CONTRACT NO. S-2017-1 2017 MILFORD PIPELINE RECONSTRUCTION

BIDDER agrees to perform all the work described in the CONTRACT DOCUMENTS for the following unit prices or lump sum. BIDS shall include all applicable taxes and fees. The BIDDER shall quote each work area individually as areas may be deleted at the discretion of the City due to budgetary limitations.

Area 1

Item No.	Description	Quantity	Unit	Note	Unit Cost	Total Cost
MH 2 - MH 5- MH 5A -MH 6-MH 6A ,MH 6-MH 9-- MH 9E = Mill St through Laurel Cleveland Alley						
1	PVC Expanded-in-place / Cured-in-Place Pipeline Reconstruction	2,826	LF	8"Pipe	26.00	73,476.00
2a	Lateral Cutouts	62	EACH		120.00	7,440.00
2b	Trim Existing Lateral	1	EACH	CONTINGENCY	250.00	-----
3a	Point Repair Excavation	1	CY	CONTINGENCY	16.00	-----
3b	Point Repair	1	LS	CONTINGENCY	1600.00	-----
4	Pavement Restoration	1	SY	CONTINGENCY	675.00	-----
5	Test "coupon" Specimen	1	EACH	CONTINGENCY	450.00	-----
	Mill St through Laurel Cleveland Alley			Sub-Total		80,916.00

Area 2

Item No.	Description	Quantity	Unit	Note	Unit Cost	Total Cost
MH 3- MH 3A-MH 3B , MH 4- MH 4A- MH 4F, MH 4C- MH 4C2 = Mound Ave and Mound Cleveland Alley						
1	PVC Expanded-in-Place / Cured-in-Place Pipeline Reconstruction	2,383	LF	8" Pipe	26.00	61,958.00
2a	Lateral Cutouts	46	EACH		120.00	5,520.00
2b	Trim Existing Lateral	1	EACH	CONTINGENCY	250.00	-----
3a	Point Repair Excavation	1	CY	CONTINGENCY	16.00	-----
3b	Point Repair	1	LS	CONTINGENCY	1,600.00	-----
4	Pavement Restoration	1	SY	CONTINGENCY	675.00	-----
5	Test "coupon" Specimen	1	EACH	CONTINGENCY	450.00	-----
	Mound Ave and Mound Cleveland Alley			Sub-Total		67,478.00

BID QUANTITY SHEET

CONTRACT NO. S-2017-1 2017 MILFORD PIPELINE RECONSTRUCTION

BIDDER agrees to perform all the work described in the CONTRACT DOCUMENTS for the following unit prices or lump sum. BIDS shall include all applicable taxes and fees. The BIDDER shall quote each work area individually as areas may be deleted at the discretion of the City due to budgetary limitations.

Area 3

Item No.	Description	Quantity	Unit	Note	Unit Cost	Total Cost
MH 9- MH 17, MH 11-MH 11B Oak Street to Gatch Ave						
1	PVC Expanded-in-Place / Cured-in-Place Pipeline Reconstruction	2270	LF	8" Pipe	26.00	59,020.00
2a	Lateral Cutouts	45	EACH		120.00	5,400.00
2b	Trim Existing Lateral	1	EACH	CONTINGENCY	250.00	
3a	Point Repair Excavation	1	CY	CONTINGENCY	16.00	
3b	Point Repair	1	LS	CONTINGENCY	1,600.00	
4	Pavement Restoration	1	SY	CONTINGENCY	6,750.00	
5	Test "coupon" Specimen	1	EACH	CONTINGENCY	450.00	
Oak Street to Gatch						64,420.00
Sub-Total						

TOTAL BID FOR CONTRACT NO. S-2017-1 (Inclusive) \$ 212,814.00

BASE BID TOTAL

Respectfully Submitted:

March 14, 2017

Date

Layne/Inliner, LLC

Company Name

Branch Manager

Signature & Title

4143 Weaver Court

Address

Hilliard, OH 43026

(Seal - If bid is by Corporation)

AREA 1: MH 2-MH 5,5A-MH 6-MH 6A, MH6-MH9--MH 9E



AREA 2: MH 3, MH 3A-MH 3B, MH 4, MH 4A-MH 4F, MH 4C,
MH 4C1-MH 4C2



AREA 3: MH 9-MH17, MH11-MH11B



CONTRACT BID FORM

Proposal of Miller Pipeline (hereinafter called Bidder), organized and existing under the laws of the State of IN doing business as a _____ (underline "Corporation", "Partnership", or "Individual", as applicable).

To the City of Milford, Ohio (hereinafter called Owner):

In compliance with the Advertisement for Bids, Bidder hereby proposes to perform all work for the construction of:

**MILFORD PIPELINE RECONSTRUCTION
CONTRACT NO. S-2017-1**

in strict accordance with the contract documents, within the time set forth therein, and at the prices stated herein.

By submission of this bid, each Bidder certifies, and in the case of joint bid; each party thereto certifies as to its own organization, that this bid has been arrived at independently, without consultation, communication, or Agreement as to any matter relating to the bid with any other Bidder or with any competitor.

The Bidder hereby agrees to commence work under this Contract on or before a date to be specified in the Notice to Proceed and to fully complete the Project within sixty (60) consecutive calendar days thereafter. The Bidder further agrees to pay, as liquidated damages, the sum of \$100.00 for each consecutive calendar day thereafter as provided in the Contract.

The Bidder acknowledges receipt of the following Addendum:

addendum # 1, 2/28/17

Bids shall include all applicable taxes and fees.



Signature Kevin Miller

President - 3/14/17

Title and Date

BID QUANTITY SHEET

CONTRACT NO. S-2017-1 2017 MILFORD PIPELINE RECONSTRUCTION

BIDDER agrees to perform all the work described in the CONTRACT DOCUMENTS for the following unit prices or lump sum. BIDS shall include all applicable taxes and fees. The BIDDER shall quote each work area individually as areas may be deleted at the discretion of the City due to budgetary limitations.

Area 1

Item No.	Description	Quantity	Unit	Note	Unit Cost	Total Cost
MH 2 - MH 5- MH 6A -MH 6-MH 6A ,MH 6-MH 9-- MH 9E = Mill St through Laurel Cleveland Alley						
1	PVC Expanded-in-place / Cured-in-Place Pipeline Reconstruction	2,826	LF	8"Pipe	\$22.00	\$62,172.00
2a	Lateral Cutouts	62	EACH		\$100.00	\$6,200.00
2b	Trim Existing Lateral	1	EACH	CONTINGENCY	\$165.00	-----
3a	Point Repair Excavation	1	CY	CONTINGENCY	\$456.50	-----
3b	Point Repair	1	LS	CONTINGENCY	\$1,089.00	-----
4	Pavement Restoration	1	SY	CONTINGENCY	\$324.50	-----
5	Test "coupon" Specimen	1	EACH	CONTINGENCY	\$1.00	-----
	Mill St through Laurel Cleveland Alley			Sub-Total	\$2,158.00	\$68,372.00

Area 2

Item No.	Description	Quantity	Unit	Note	Unit Cost	Total Cost
MH 3- MH 3A-MH 3B , MH 4- MH 4A- MH 4F, MH 4C- MH 4C2 = Mound Ave and Mound Cleveland Alley						
1	PVC Expanded-in-Place / Cured-in-Place Pipeline Reconstruction	2,383	LF	8" Pipe	\$23.00	\$54,809.00
2a	Lateral Cutouts	46	EACH		\$100.00	\$4,600.00
2b	Trim Existing Lateral	1	EACH	CONTINGENCY	\$165.00	-----
3a	Point Repair Excavation	1	CY	CONTINGENCY	\$456.50	-----
3b	Point Repair	1	LS	CONTINGENCY	\$1,089.00	-----
4	Pavement Restoration	1	SY	CONTINGENCY	\$324.50	-----
5	Test "coupon" Specimen	1	EACH	CONTINGENCY	\$1.00	-----
	Mound Ave and Mound Cleveland Alley			Sub-Total	\$2,159.00	\$59,409.00

BID QUANTITY SHEET

CONTRACT NO. S-2017-1 2017 MILFORD PIPELINE RECONSTRUCTION

BIDDER agrees to perform all the work described in the CONTRACT DOCUMENTS for the following unit prices or lump sum. BIDS shall include all applicable taxes and fees. The BIDDER shall quote each work area individually as areas may be deleted at the discretion of the City due to budgetary limitations.

Area 3

Item No.	Description	Quantity	Unit	Note	Unit Cost	Total Cost
MH 9- MH 17, MH 11-MH 11B Oak Street to Gatch Ave						
1	PVC Expanded-in-Place / Cured-in-Place Pipeline Reconstruction	2270	LF	8" Pipe	\$23.00	\$52,210.00
2a	Lateral Cutouts	45	EACH		\$100.00	\$4,500.00
2b	Trim Existing Lateral	1	EACH	CONTIGENCY	\$165.00	
3a	Point Repair Excavation	1	CY	CONTIGENCY	\$456.50	
3b	Point Repair	1	LS	CONTIGENCY	\$1,089.00	
4	Pavement Restoration	1	SY	CONTIGENCY	\$324.50	
5	Test "coupon" Specimen	1	EACH	CONTIGENCY	\$1.00	
Oak Street to Gatch					Sub-Total	\$2,159.00
						\$56,710.00

TOTAL BID FOR CONTRACT NO. S-2017-1 (Inclusive) \$ 184,491.00

BASE BID TOTAL

Respectfully Submitted:

3/14/17

Date

Miller Pipeline

Company Name

President

Attest

Signature & Title

8850 Crawfordsville Rd.

Address

Indianapolis, IN 46234

(Seal - If bid is by Corporation)



March 23, 2017

Mr. Nate Clayton, P.E.
Public Works Director
City of Milford
745 Center Street
Milford, OH 45150

Dear Nate,

**Subject: Mill Street at Water Street
Intersection Improvements
Proposal for Engineering Design Services**

Thank you for requesting a proposal from Roberts Engineering, Inc. (REI) for the subject project. We have reviewed your email request dated March 8, 2017 and the documents attached to that request. In addition, we have visited the site for a closer inspection of the existing conditions. Based on the information provided by you, collected by REI and our knowledge of the intersection, we propose utilizing the professional services of G.J.Berding Surveying and The Kleingers Group for our design team to provide the following:

1. Upon receipt of authorization to proceed, schedule a project kick-off meeting with the city to review the proposed design schedule prepared by the project team and discuss any modifications to the project scope that should be considered.
2. Obtain a detailed topographic survey from G.J. Berding Surveying, Inc. of the area along Water Street/US 50 just west of the east bridge abutment to approximately 75' north of the curbed island on Water Street and along Mill Street/US 50 to the west side of the driveway at 220 Mill Street. This survey would include, but not be limited to, the location of the underground utilities as identified by OUPS and the Milford Utility Department, the location, size and inverts of the storm and sanitary sewers and associated structures, the location of the right-of-way and spot elevations of the roadway, curb and gutter, sidewalks, and back of walks to the face of existing buildings.
3. Utilizing the detailed information from the survey, prepare a concept design plan for the suggested improvements in accordance with the recommendations contained in the traffic study by The Kleingers Group. The concept plan would include a general layout with horizontal geometry for the roadway and sidewalk modifications, striping, and suggested traffic signal modifications. The plan would also identify any additional right-of-way required and any other improvements that should be considered. This concept plan would be submitted, along with a preliminary probable construction cost estimate, to your office for review, comment and discussion at the 50% complete progress meeting.

4. Modify the concept design in accordance with the decisions made at the progress meeting and prepare the detailed construction plans which would include the following:
 - The horizontal and vertical design of the roadway improvements, including necessary modifications to sidewalks, access drives and storm drainage.
 - Detailed modifications and additions to the traffic signal system, including pedestrian signals, signal timing and profile views of the traffic signals.
 - The traffic control plan which would include signing and pavement marking.
 - The maintenance of traffic plan.
 - Preparation of the construction quantities and update the estimate of probable construction cost.
5. Submit the detailed plans, notes, construction quantity estimate, specifications and updated probable construction cost to the city for the 90% completion review.
6. Upon receipt of any review comments from the city, finalize the plans and the estimate of the probable construction costs, prepare the construction bid documents using the city's bid proposal forms, general conditions, and construction specifications for bidding by the city.
7. Assist the city with answers to questions that may arise during the bidding process.
8. Prepare temporary right-of-way or temporary easement plats if required.
9. Post Design Services as requested - Provide construction observation services during construction to reduce the risk of problems arising that could affect the implementation of the intent of the plans, specifications and recommendations that have been developed and approved. These services would include answering construction related questions and periodic site visits at appropriate stages of construction to observe the progress and quality of the work to determine, in general, if the work is proceeding in accordance with the contract documents, and provide verification of the contractor's pay request relative to the work completed.

We propose to provide the professional engineering services indicated above for a lump sum fee of \$28,700 (Twenty Eight Thousand Seven Hundred Dollars). If additional right-of-way is required, the cost per plat would be between \$500 and \$800 depending on the complexity of the take.

REI's services shall be limited to those expressly set forth above, and REI shall have no other obligations or responsibilities for the project except as agreed to in writing or as provided in this Agreement. Additional services may be provided on an hourly rate basis only upon advance authorization by you. REI will invoice the city every four weeks for the amounts due for the professional services rendered and expenses incurred. Full payment for the amount invoiced is due within twenty-five (25) calendar days of receipt of invoice.

Mr. Nate Clayton, P.E.
March 23, 2017
Page 3 of 3

Furthermore, to the fullest extent permitted by law, REI's total liability to the City of Milford for any and all injuries, claims, losses, expenses and damages arising out of this agreement from any cause or causes shall not exceed the lesser amount of \$50,000 or the amount of REI's fee.

This Agreement may be terminated by either party upon seven (7) calendar days written notice. In the event of termination, REI shall be paid by the City of Milford for all services performed up to the date of termination. All original documents and drawings developed by REI on behalf of the City of Milford shall remain the property of REI. However, copies of all documents, including reproduces and electronic media, shall be furnished to the City of Milford at cost.

Please advise us if we have misinterpreted the scope of the services required, if you have any questions regarding this proposal, or if you need additional information. If this proposal is acceptable, please acknowledge by signing below and returning the signed copy to us.

Again, we thank you for this opportunity. Please call if you have any questions.

Very truly yours,

ROBERTS ENGINEERING, INC.



Ronald W. Roberts, P.E.
President

Accepted

Date



Strand Associates, Inc.®

615 Elsinore Place, Suite 320

Cincinnati, OH 45202

(P) 513-861-5600

(F) 513-861-5601

March 24, 2017

Mr. Nathaniel Clayton
Public Works Director
City of Milford
745 Center Street
Milford, Ohio 45150

Re: Proposal for Mill Street and Water Street Intersection Improvement

Dear Mr. Clayton:

On behalf of Strand Associates, Inc.® (Strand), thank you for the opportunity to provide our proposal for engineering services to the City of Milford (City) to prepare construction documents for the Mill Street and Water Street Intersection Improvement. This letter discusses our *Project Understanding*, *Scope of Services*, *Project Schedule*, and *Proposed Fees*.

Project Understanding

It is our understanding that the City intends to reconstruct the Mill Street and Water Street intersection to provide eastbound and westbound left turn lanes and incorporate the proposed site driveway for the Little Miami Brewing Company in to the existing signalized intersection. Our understanding of the project is based on the information provided by the City in an email sent on March 8, 2017, including a concept plan from a previously completed Traffic Impact Study.

Scope of Services – Project Administration and Coordination

The following tasks are included in this Scope item:

- Prepare for and attend a kickoff meeting with the City to finalize the project scope and schedule, and define deliverables.
- Prepare for and attend three milestone meetings with the City, one after the Conceptual Design Phase (50% design), one after the Detailed Design Phase (90% design), and one after the Final Design Phase (100% design).
- Prepare a project design schedule. The schedule will be updated after each phase of design as needed.

Scope of Services – Utility, Right-of-Way, and Property Documentation and Research

To establish the baseline conditions for the Mill Street and Water Street Intersection Improvement, we have prepared the following Scope of Services for field investigation:

- Conduct topographic survey of the intersection. The anticipated limits of survey are approximately 80 feet on the west approach, approximately 50 feet along the north approach,

and approximately 150 feet on the east approach, for a total area of approximately 0.7 acres. The survey will extend approximately 10 feet behind the back of existing walk on the north side and approximately 20 feet behind the back of existing walk on the south side. It is anticipated the City will send out property owner notification letters prior to the start of the survey, if necessary.

- Map existing utilities within the project limits based on existing surface features, field markings provided by the Ohio Utilities Protection Service (OUPS), and facility maps provided by the utilities. Subsurface utility engineering is not anticipated.
- Depict right-of-way based on research of record deeds and existing field monumentation.
- Prepare a plat and legal description for additional right-of-way on the south side Mill Street near the intersection with Water Street. This Scope of Services anticipates the City will record the documents with Clermont County.

The following tasks can be provided as a part of the conceptual design phase if desired by the City and therefore are included as If Authorized tasks in this proposal letter.

- Conduct topographic survey along the south side of Mill Street from 220 Mill Street to the intersection of Mill Street and Main Street.

Scope of Services - Conceptual Design (50 Percent Design)

The conceptual design phase includes the following tasks:

- Communicate with Roberts Engineering to determine the exact location of the proposed site driveway. This Scope of Services anticipates an AutoCAD file showing the proposed site development features will be available to Strand.
- Perform geometric design of intersection improvements.
- Prepare a plan and profile drawing of the proposed intersection improvements.
- Prepare a maintenance of traffic plan describing sequence of operations and proposed typical sections.
- Prepare a pavement marking and signage drawing.
- Perform an analysis to provide lighting at the intersection that meets applicable standards.
- Prepare a lighting plan drawing. This Scope of Services anticipates the street lighting will be routed to the existing controller.
- Perform traffic signal design, including determining location of poles, location of signal heads, location of vehicle detectors, size of poles and foundations, and size of conduit.
- Prepare traffic signal drawings to modify the existing traffic signal installation to accommodate the improved intersection. New traffic signal poles, mast arms, signal heads, and vehicle detection will be included. The existing controller is anticipated to remain.
- Prepare an engineer's opinion of probable construction cost for the improvements detailed in the conceptual design drawings.
- Submit five sets of 11x17 conceptual design drawings to the City for review. This Scope of Services anticipates the City will compile all comments and provide Strand with one comprehensive set of comments.
- Send conceptual design drawings to utility companies with facilities in the project area.

The following tasks can be provided as a part of the conceptual design phase if desired by the City and therefore are included as If Authorized tasks in this proposal letter.

- Design an extension of the existing bike lane on Water Street to connect to the bottom of the Mill Street hill. This will include modifications to the existing concrete sidewalk along the south side of Mill Street.
- Perform an analysis to determine AM and PM peak hour timing plans to accommodate the proposed phasing at the intersection. The timing plans will be developed utilizing traffic count information available in the previously completed Traffic Impact Study.

Scope of Services - Detailed Design (90 Percent Design)

The detailed design phase includes the following tasks:

- Address comments on the conceptual design drawings provided by the City.
- Prepare maintenance of traffic construction drawings showing temporary traffic control devices.
- Prepare an intersection detail sheet showing pavement elevations and curb elevations.
- Prepare material schedules for lighting and traffic signal improvements.
- Prepare an engineer's opinion of probable construction cost for the improvements detailed in the detailed design drawings.
- Prepare technical specifications as needed for the project. This Scope of Services anticipates the City of Milford Standard Specifications and Ohio Department of Transportation Construction and Materials Specifications will be used or modified for all bid items.
- Prepare project bidding documents including bidding requirements such as advertisement, instructions, and bid forms, and project contract documents including standard forms for agreement, addenda, notice to proceed, bond requirements, standard general conditions, and project supplementary conditions.
- Submit five sets of 11x17 detailed design drawings and three full sets of specifications to the City for review. This Scope of Services anticipates the City will compile all comments and provide Strand with one comprehensive set of comments.
- Send detailed design drawings to utility companies with facilities in the project area.

Scope of Services - Final Design (100 Percent Design)

The final design phase includes the following tasks:

- Address comments on the detailed design drawings provided by the City.
- Submit three sets of 11x17 construction drawings and three full sets of specifications to the City for a screening review. This Scope of Services anticipates the City will compile all comments and provide Strand with one comprehensive set of comments.
- Address comments from the City screening review.
- Submit one set of final construction drawings on mylar.
- Submit five sets of construction drawings and specifications for bidding.
- Submit drawings in AutoCAD format and specifications in Microsoft Word format.

Mr. Nathaniel Clayton
City of Milford
Page 4
March 24, 2017

Project Schedule

The construction documents for the Mill Street and Water Street Intersection Improvement project can be completed within 180 days of executing an Engineering Services Agreement.

Proposed Fees

Based on the scope of services defined above, to complete the Mill Street and Water Street Intersection Improvement project we estimate the following fees:

1. Project Administration and Coordination: \$6,400
2. Utility, Right-of-Way, and Property Documentation and Research: \$6,300
3. Conceptual Design (50 Percent Design): \$12,600
4. Detailed Design (90 Percent Design): \$12,400
5. Final Design (100 Percent Design): \$3,900

The total lump sum fee for all proposed services is \$41,600. Our services will be billed on a percent complete basis. The lump sum will not be exceeded without prior approval.

The total lump sum fee for If Authorized Services is an additional \$3,500.

This letter is not to be considered an agreement between Strand Associates, Inc.[®] and the City of Milford, but, rather as a general discussion of the type of tasks and magnitude of costs the City of Milford may expect for a project of this nature. Upon your direction, we will prepare an Engineering Services Agreement and submit to the City for review and signature. Once the Engineering Services Agreement is executed, work on the project will begin immediately.

We sincerely thank you for the opportunity to submit this proposal. We look forward to working with you. If you have any questions, comments, or need additional information, please call me at (513) 861-5600.

Sincerely,

STRAND ASSOCIATES, INC.[®]



Michael Ellerbrock, P.E.

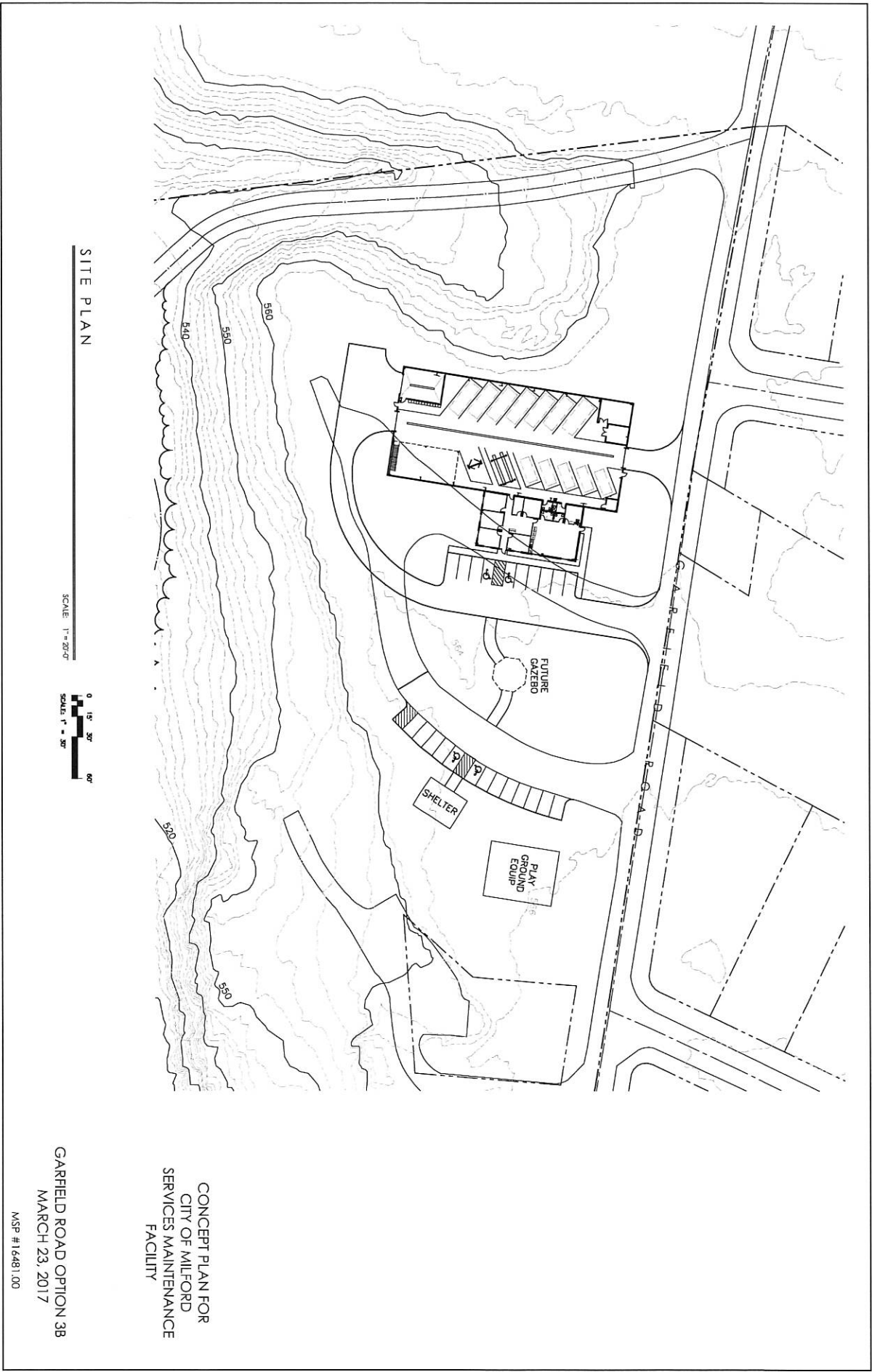

CITY OF MILFORD TREE REBATE PROGRAM

PROGRAM DETAILS

- Open to City of Milford residents
- 50% rebate payable to eligible participants up to \$250.00 (see approved tree list)
- Limit of 1 rebate for newly planted trees per residential parcel, per calendar year
- 1.5 – 3 inch diameter planted tree size
- Available May 1 – November 30
- Funding from the City of Milford Stormwater is limited, distributed on a first-come/first served basis
- Permit must be submitted to, and approved by the City of Milford **before** tree is planted to be eligible for reimbursement

BENEFITS OF TREES IN THE CITY

- Every tree planted in the City of Milford contributes to a healthy river and watershed
- Trees intercept rainwater reducing stormwater runoff
- Trees shade homes, keeping them cooler and saving energy

APPROVED TREE LIST

- | | |
|-------------------------|-----------------------|
| - Serviceberry | - American Basswood |
| - American Redbud | - Beech |
| - Paw Paw | - American Holly |
| - Blackhaw Viburnum | - American Yellowwood |
| - Kentucky Coffeetree | - Tulip Tree |
| - Bur Oak | - Baldcypress |
| - Thornless Honeylocust | |

FOR ELIGIBILITY REQUIREMENTS CONTACT:

Bruce Molett
513-576-5462
bmolett@milfordohio.org

