



City of Burlingame Community Center Conceptual Design

Citizens Advisory Committee Meeting

03.25.2015

6:30 pm - 8:00 pm





AGENDA

1. Project and Schedule Updates

- Work Plan
- Participation and Outreach Schedule
- Process and Outcome Goals

2. Program and Building Bubble Diagram Options

3. Design Values Exercise

4. Next Steps



AGENDA

1. Project and Schedule Updates

- Work Plan
- Participation and Outreach Schedule
- Process and Outcome Goals

2. Program and Building Bubble Diagram Options

3. Design Values Exercise

4. Next Steps



BURLINGAME COMMUNITY CENTER

CONCEPTUAL DESIGN AND INITIAL STUDY, TECHNICAL REPORTS & MND

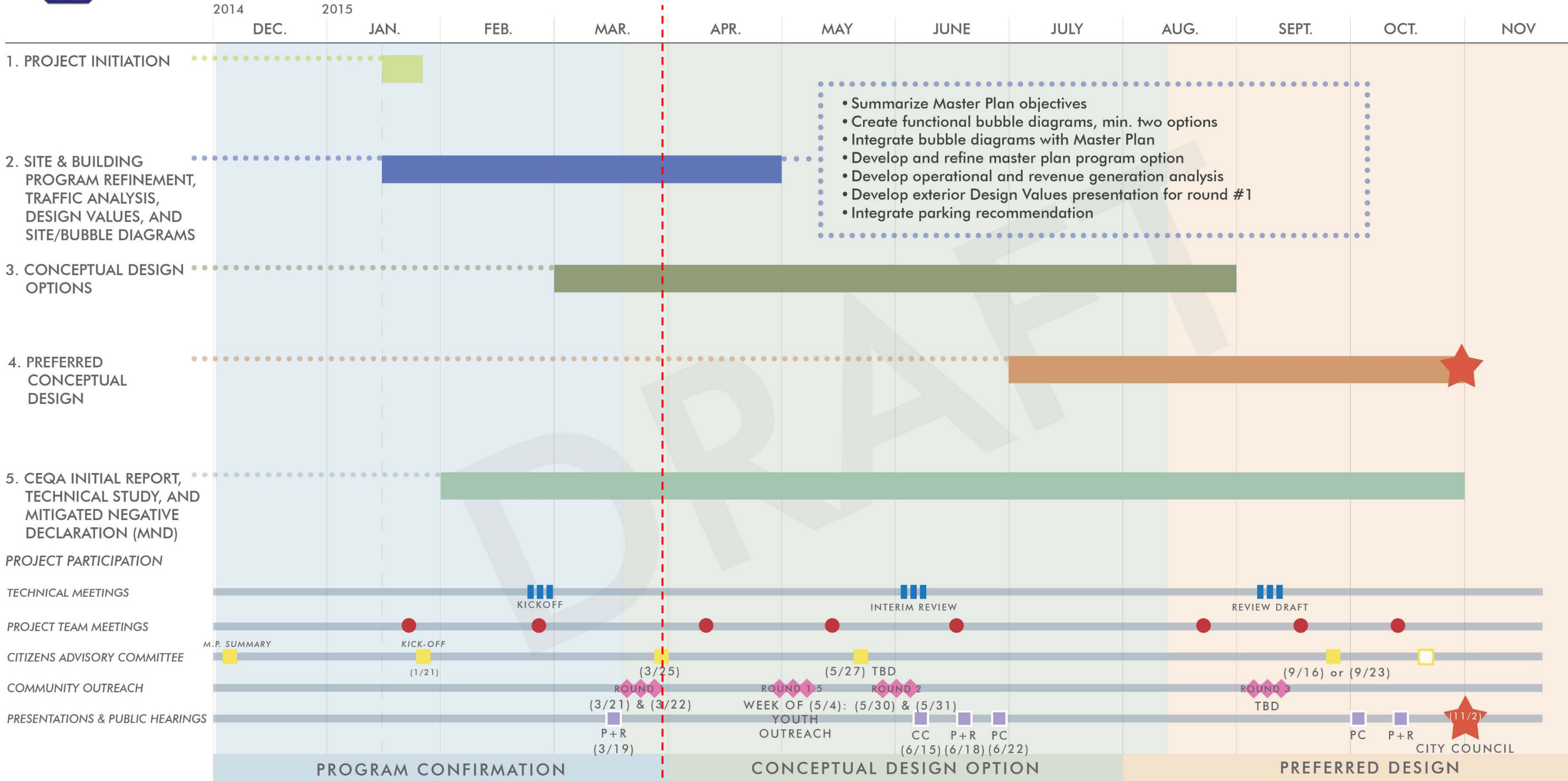

GROUP 4

03.25.15

4

BURLINGAME COMMUNITY CENTER

PARTICIPATION OPPORTUNITIES OVERVIEW

■ Community Outreach (*subject to change*)

■ ROUND 1

- ✓ MARCH 19th: Parks & Recreation Commission Meeting, 7pm
- ✓ MARCH 21st: Community Open House @ Washington Park, 10am-2pm
- ✓ MARCH 22nd: Community Kiosk @ Farmers Market, 9am-1:30pm

■ ROUND 2

- MAY 30th: Community Open House @ Washington Park, 10am-2pm
- MAY 31st: Community Kiosk @ Farmers Market, 9am-1:30pm
- JUNE 18th: Parks & Recreation Commission – Public Hearing/Meeting, 7pm

□ Teen/Youth Specific Outreach

- Week of May 4th – Lunchtime Kiosks at Burlingame High School and Burlingame Intermediate School

PARTICIPATION OPPORTUNITIES OVERVIEW

- **Community Outreach (*subject to change*)**
 - **ROUND 3**
 - ☐ ***TO BE SCHEDULED***
 - **Other - *TO BE SCHEDULED***
 - ☐ **Community Open House – Downtown Merchants Association**
 - ☐ **Rotary Club Meetings**
 - ☐ **Burlingame Mother's Club**
 - ☐ **Traffic and Safety Commission**
 - ☐ **?**
- **Presentations and Public Hearings**
 - ☐ **(2) Planning Commission**
 - ☐ **Study Session – June 22nd**
 - ☐ **Fall 2015**
 - ☐ **(2) City Council Meetings**
 - ☐ **City Council Check-in (Study Session) – June 15th**
 - ☐ **City Council Final Presentation – November 2nd**

PROCESS GOALS

- ❑ Community engagement that is transparent and signified by the collaboration of a wide range of stakeholders and community members
- ❑ Broad community input resulting in local pride and ownership in the plan recommendations
- ❑ Plan recommendations that address the needs of a wide cross-section of residents, and bring the community together to focus on a common goal
- ❑ Burlingame's values are reflected in the process and development of the plan; participants' feedback is listened to and affirmed by the plan recommendations
- ❑ The recommended plan captures the goals, needs, and vision of all Burlingame residents, and successfully translates those into the end product: the new community center

PROJECT OUTCOME GOALS

- ❑ Creating a community center that becomes a pillar of community life and civic pride for Burlingame
- ❑ A facility that is operationally, environmentally, and socially sustainable
- ❑ The creation of a multigenerational community center that becomes a central meeting and gathering place for residents
- ❑ Honoring the history and heritage of the Gunst Estate, Washington Park, Burlingame, and respecting the mature trees
- ❑ Building a facility that meets the needs of today's community, and has the flexibility to evolve to meet future needs
- ❑ A community center that provides the opportunity for people to enrich themselves intellectually, emotionally, spiritually, and physically



AGENDA

1. Project and Schedule Updates

- Work Plan
- Participation and Outreach Schedule
- Process and Outcome Goals

2. Program and Building Bubble Diagram Options

3. Design Values Exercise

4. Next Steps

BUILDING PROGRAM OPTION

Proposed Spaces: Compare to (E) Spaces:

1	Lobby and Reception Social Lounge and Gallery	Lounge 2
2	Community Hall Multipurpose Room @ 4,000 sf Raised Platform Catering Kitchen Flex Space/Green Room	Auditorium @ 3,500 sf
3	Enrichment and Personal Development Enrichment Center Classroom Teen Scene Kids Town Musical Arts	Teen Room Studio B
4	Social & Assembly Large Meeting Room Adult Active Lounge	Social Hall Lounge 1
5	Tinker Lab Maker Space	Computer Room
6	Visual & Fine Arts Fine Arts Creative Arts & Ceramics Kiln Room	Art Room Craft room
7	Performing Arts, Dance, & Fitness Dance & Stretch Studio Fitness & Wellness Studio	Dance Studio
8	Staff Spaces	
9	Support Spaces	

ADDITIONAL & IMPROVED PROGRAMMING SPACES:

- + Attractive Community Hall with raised platform
- + Teen Scene classroom
- + Kids Town classroom
- + Maker Space
- + Dance & Stretch Studio
- + Fitness & Wellness Studio

Total Program ~35,830 sf



BUILDING BUBBLE DIAGRAM

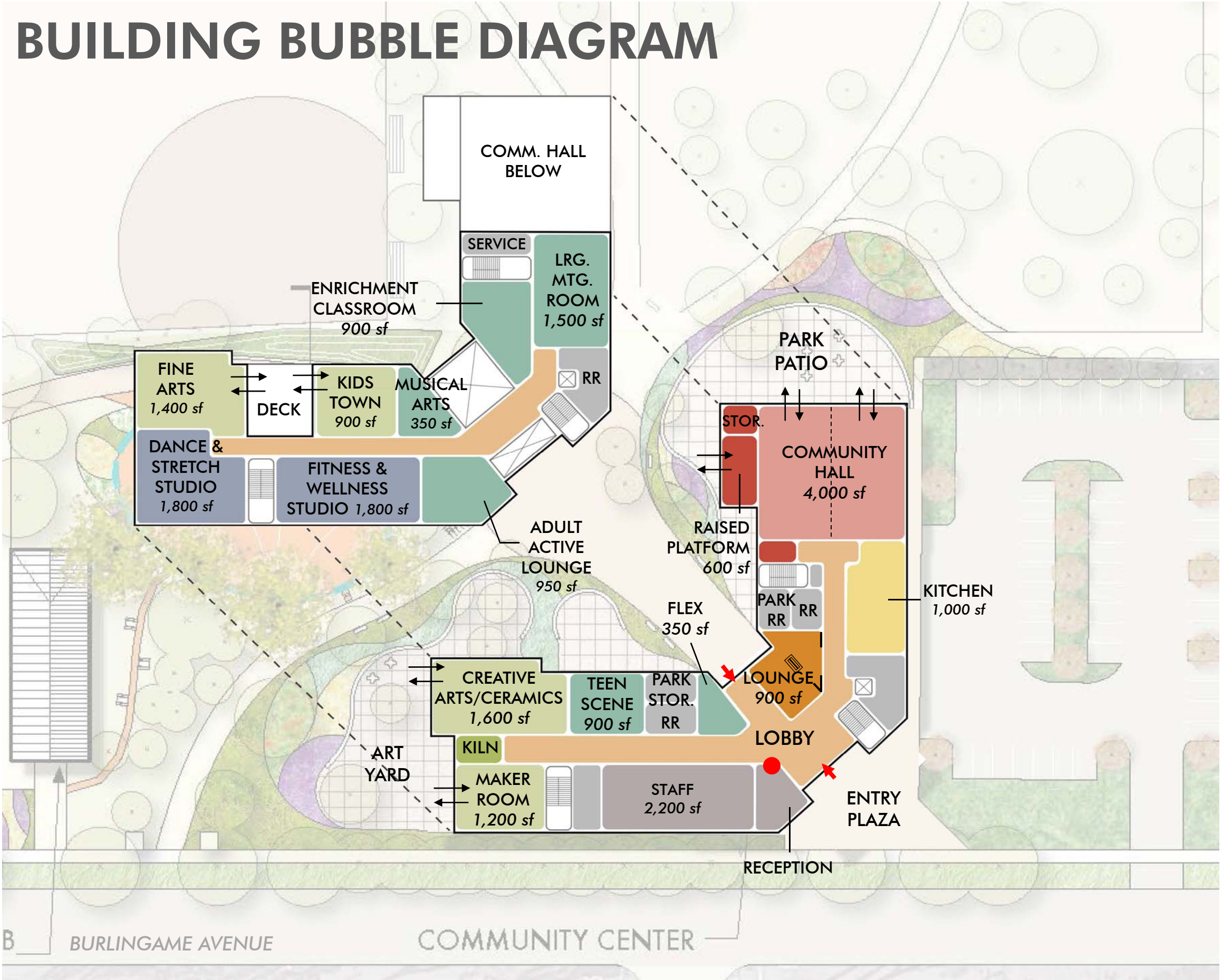

COMMUNITY HALL: OPTION A

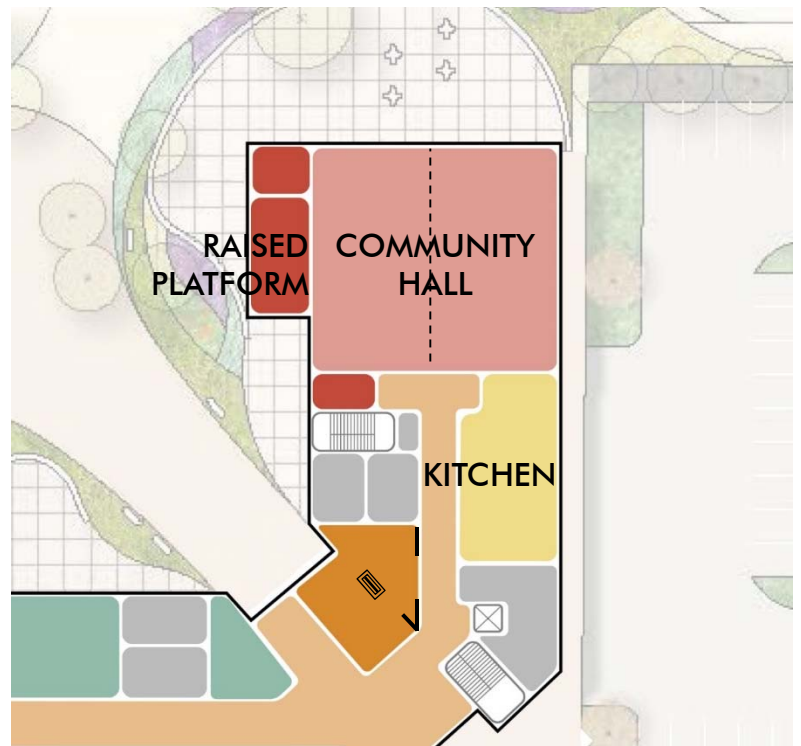

COMMUNITY HALL: OPTION B

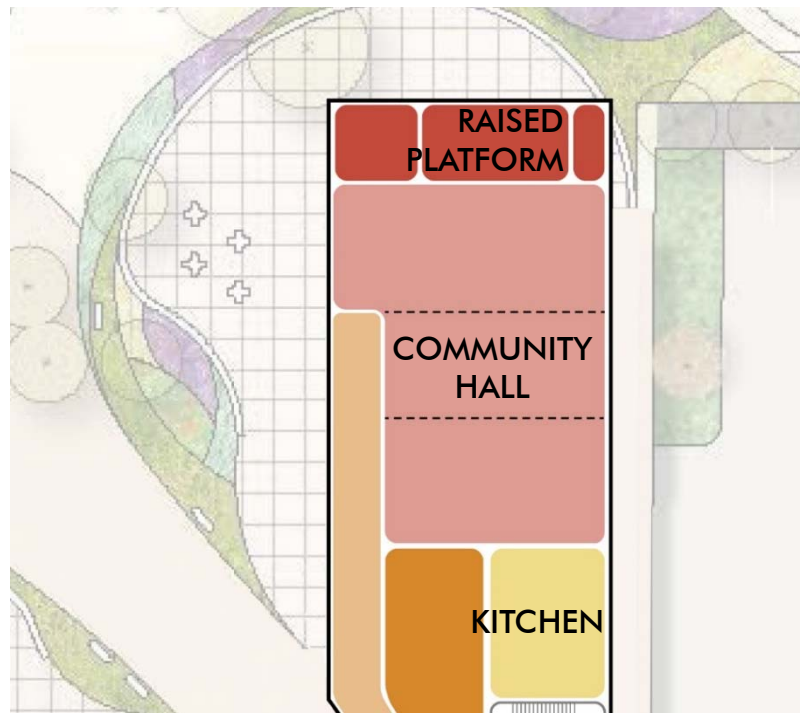

LOBBY/COMMUNITY LOUNGE

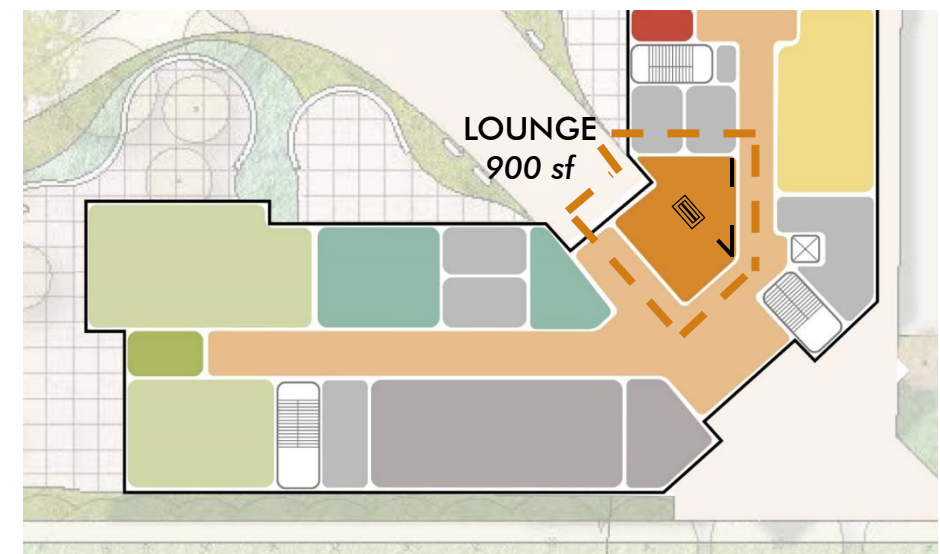

FLEX SPACE

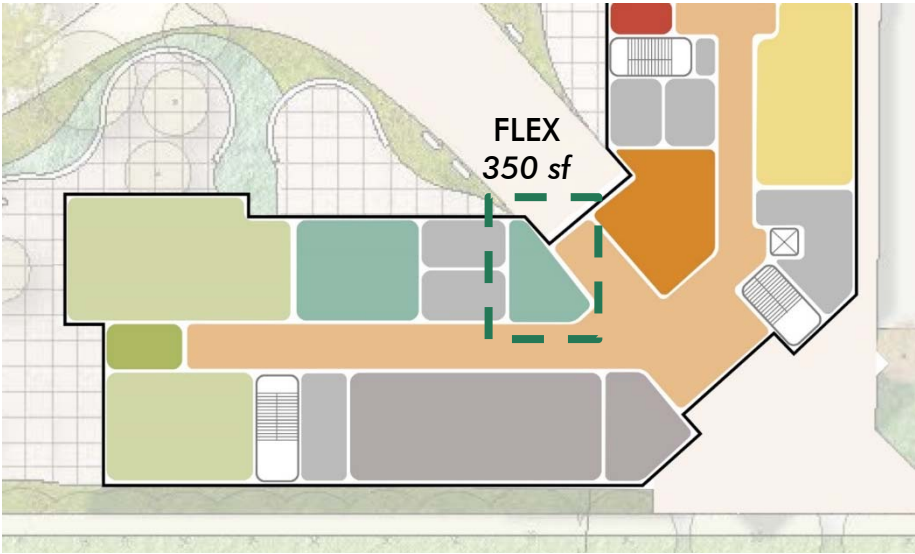

TEEN SCENE

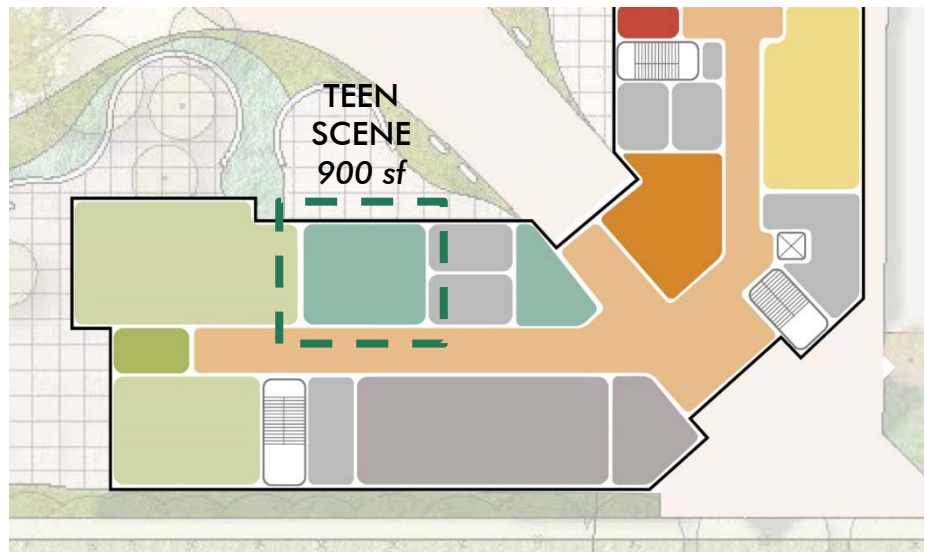

CREATIVE ARTS & CERAMICS

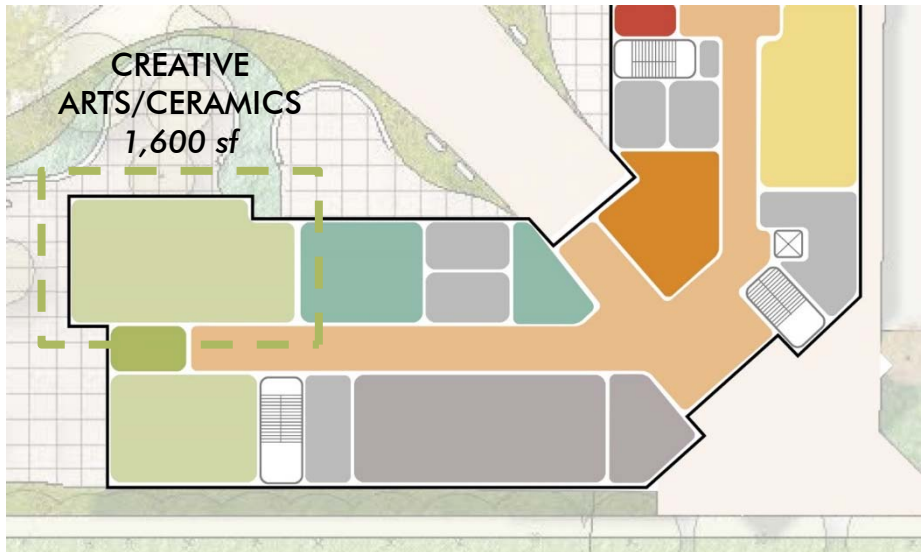

MAKER ROOM

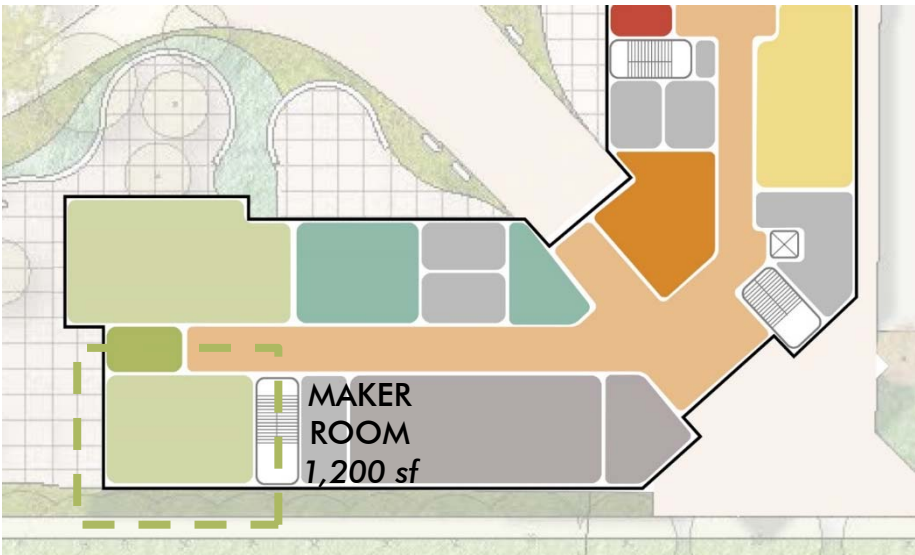
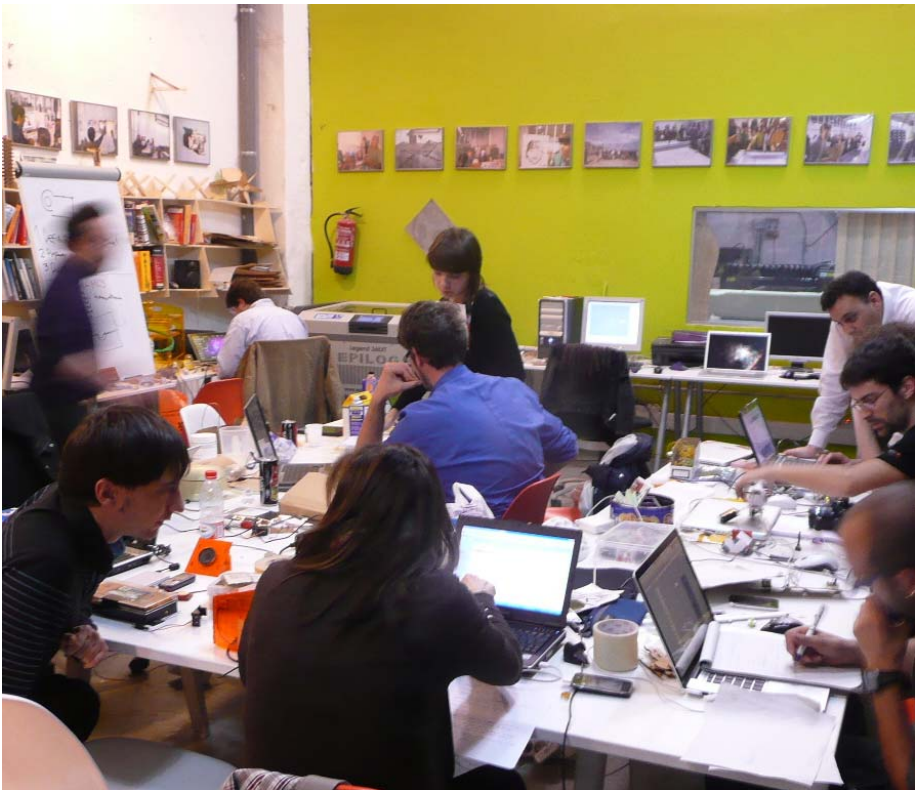

ENRICHMENT CLASSROOM

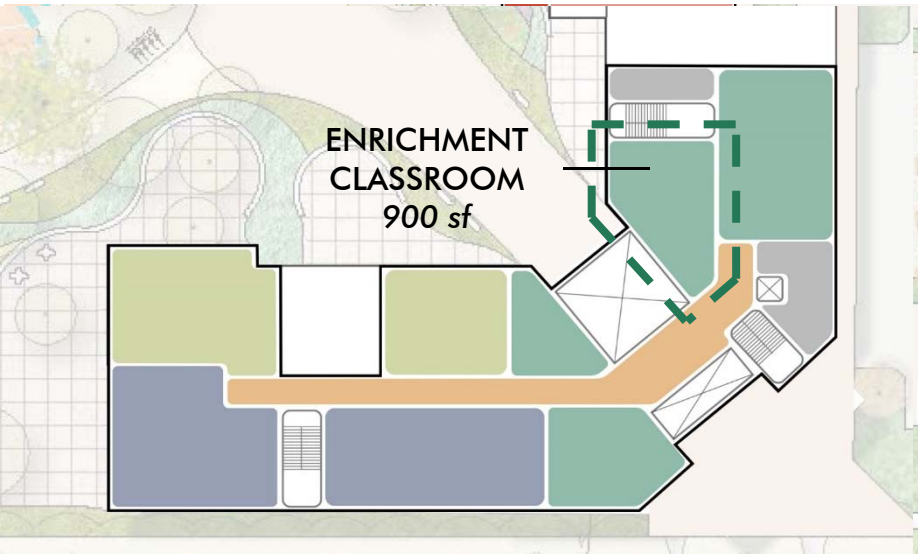

LARGE MEETING ROOM

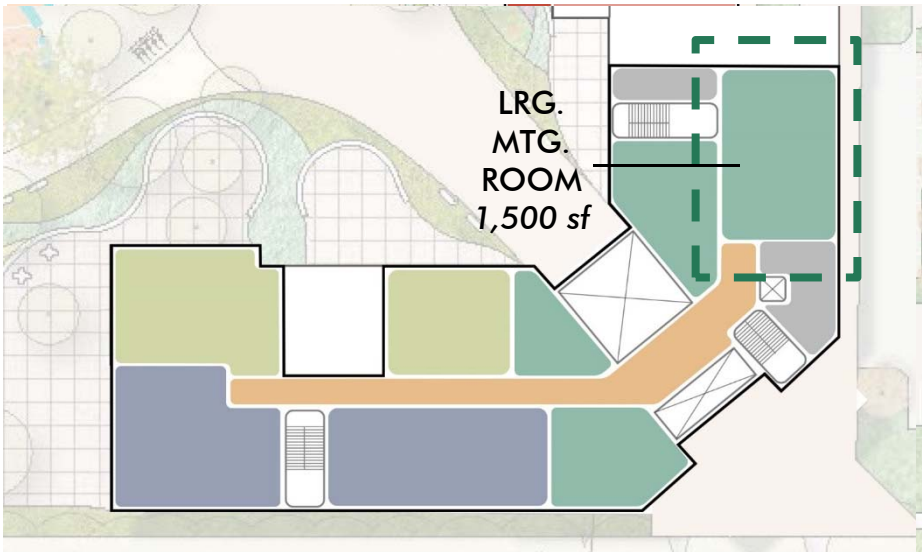

MUSICAL ARTS

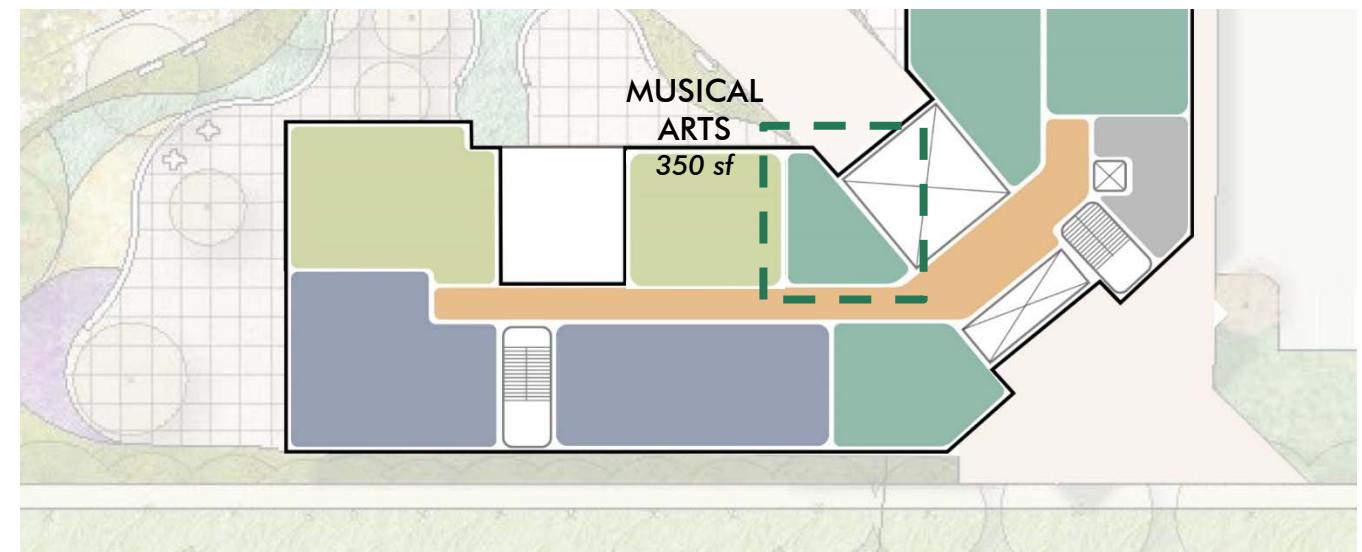

KIDS TOWN

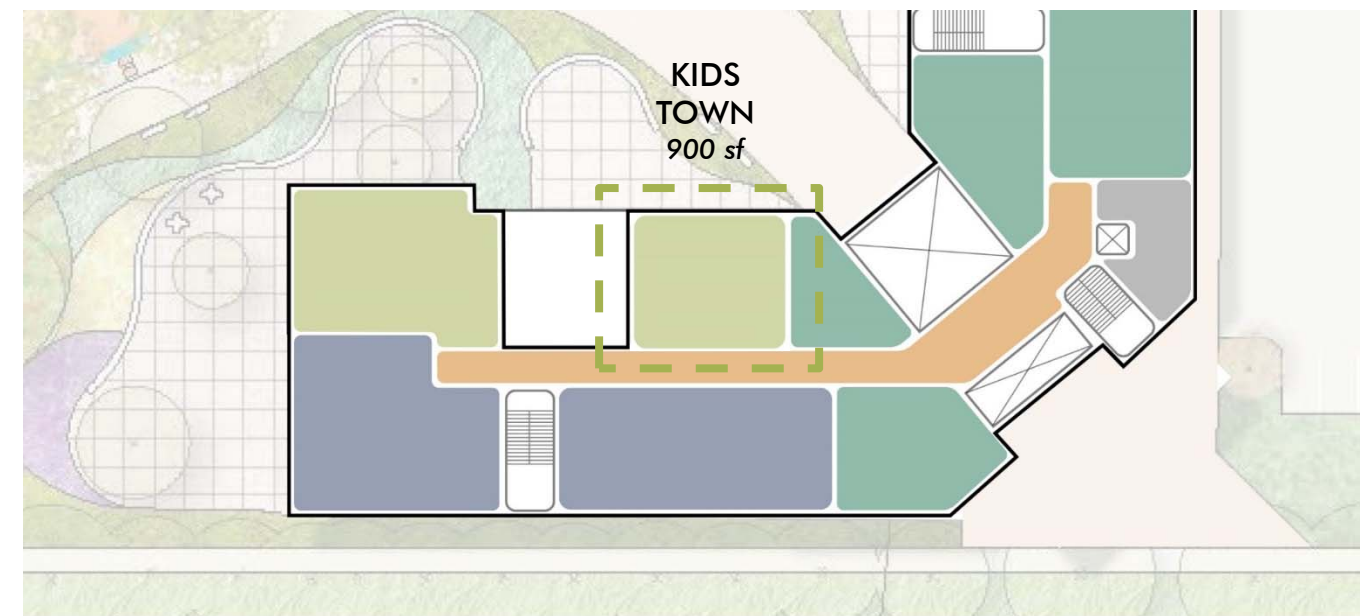

FINE ARTS

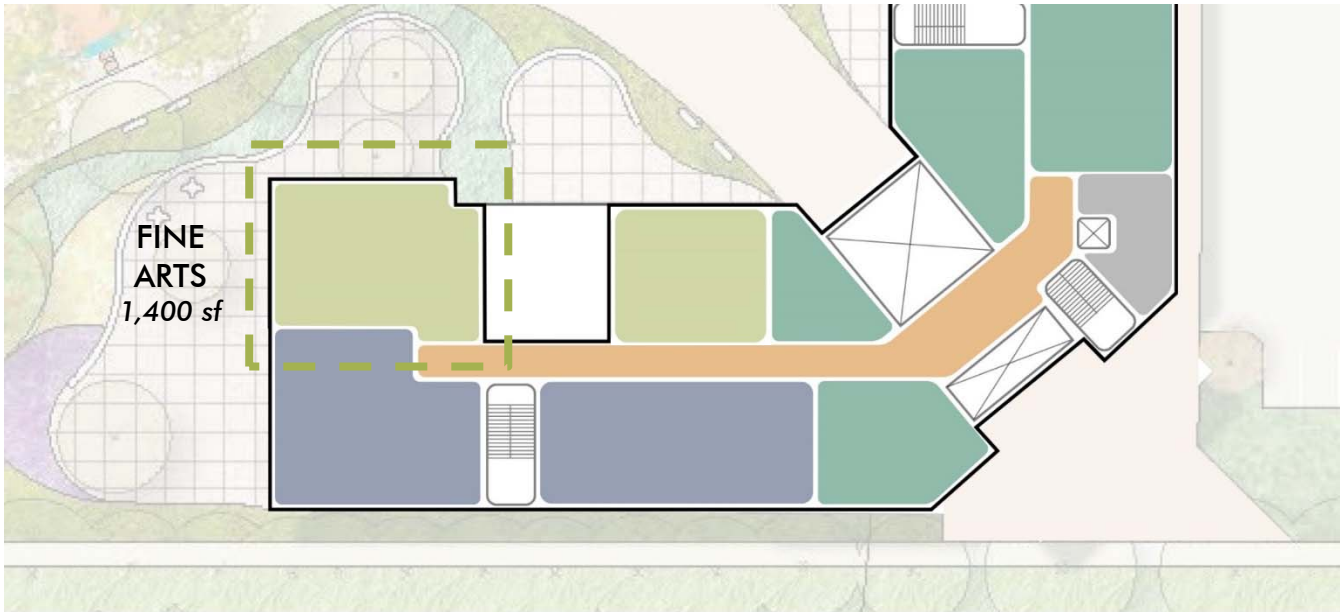

PERFORMING ARTS, DANCE, & FITNESS

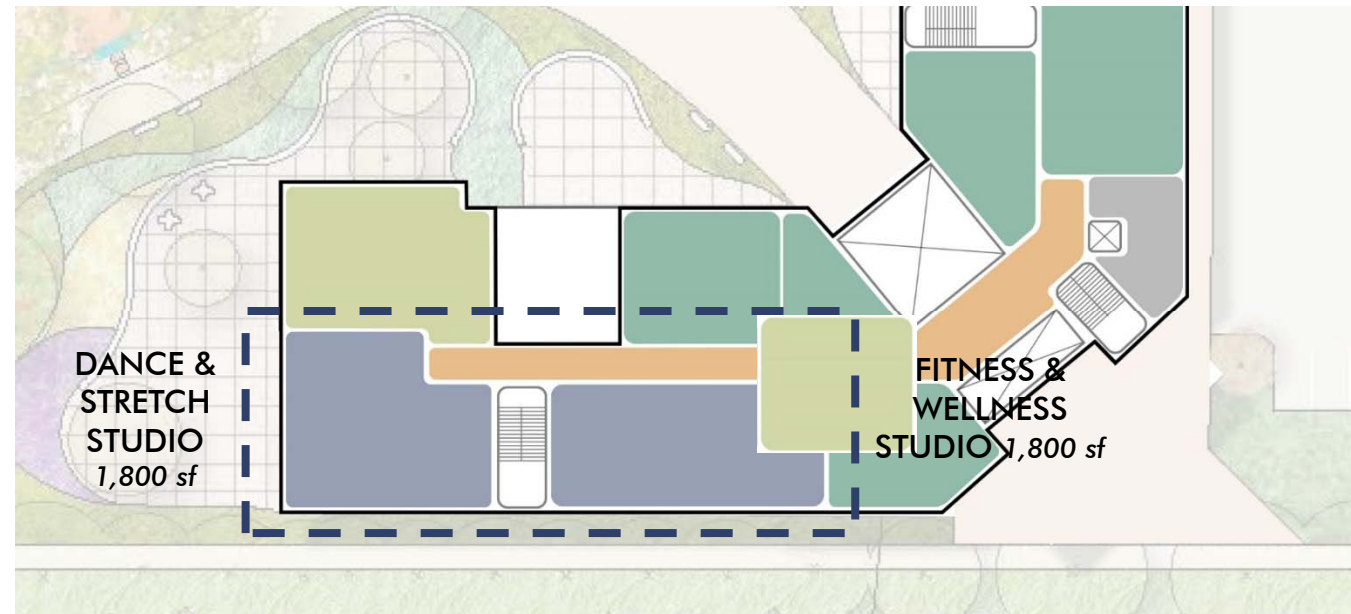

ACTIVE ADULT LOUNGE

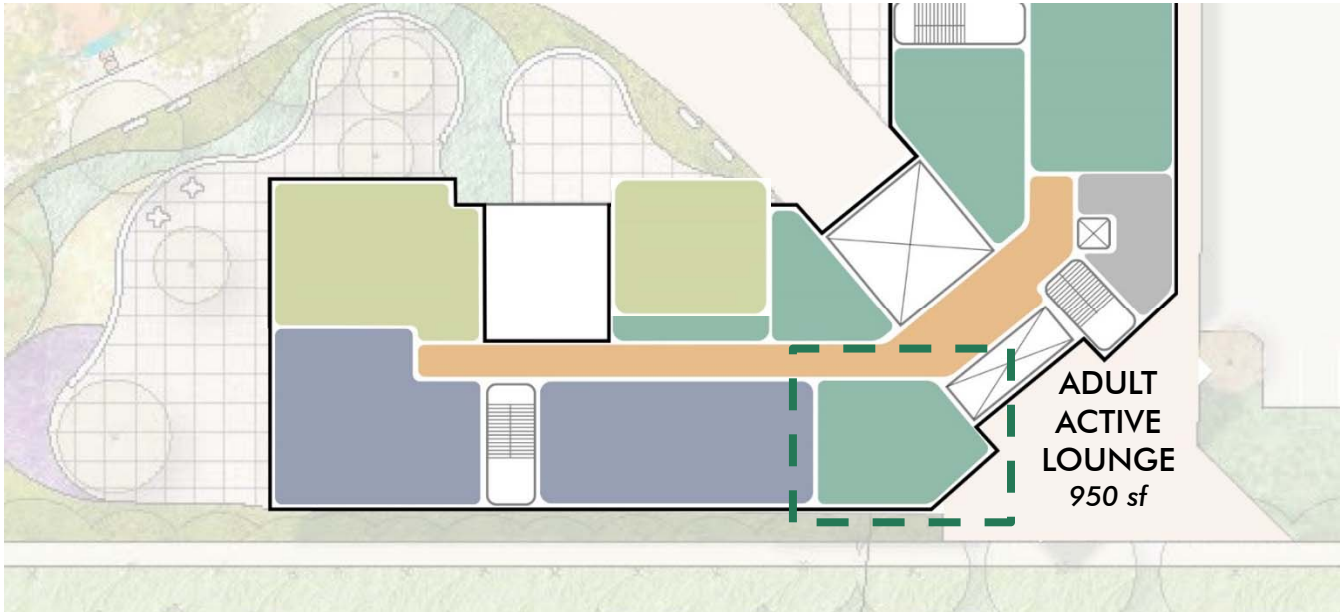

COMMUNITY HALL – OPTION A

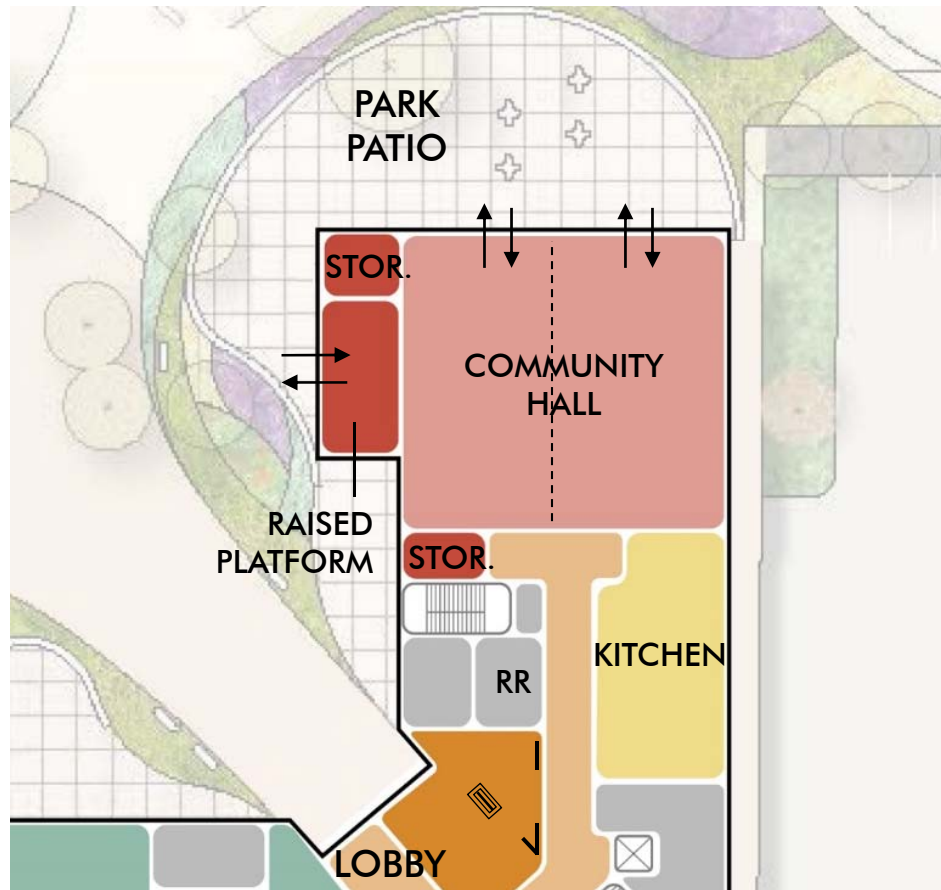

- **Feel of space:**
 - 64' x 64' – square form
 - Divisible into two, 2,016 square foot rooms
- **Raised platform:**
 - Oriented towards active park activities
 - Allows for direct connection to Gunst Estate and Park Patio from main Community Hall spaces

COMMUNITY HALL – OPTION B

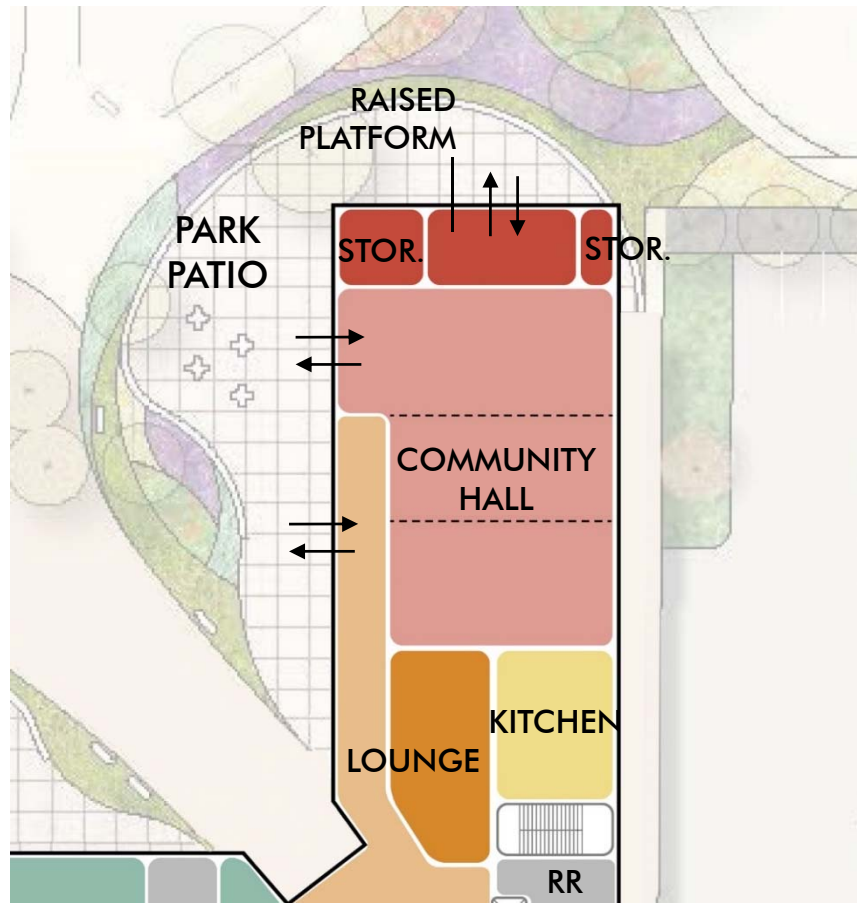

- **Feel of space:**
 - 50' x 80' – rectangular form
 - Divisible into three spaces: (2x) 1,500 sq. ft., (1x) 1,000 sq. ft.
- **Raised platform:**
 - Oriented towards Gunst Estate
 - Direct connection to Park Patio from 1/3rd of Community Hall
- **Lounge adjacency can serve as pre-function space for Community Hall**



AGENDA

1. Project and Schedule Updates

- Work Plan
- Participation and Outreach Schedule
- Process and Outcome Goals

2. Program and Building Bubble Diagram Options

3. Design Values Exercise

4. Next Steps

CONTEXTUAL INSPIRATION



TRADITIONALLY INFLUENCED



WARM + INVITING



CIVIC



RURAL + RUSTIC



EASY MODERN



GROUP 4

03.25.15

32

BURLINGAME COMMUNITY CENTER

COLORFUL



GROUP 4

03.25.15

33

BURLINGAME COMMUNITY CENTER

EXPRESSIVE

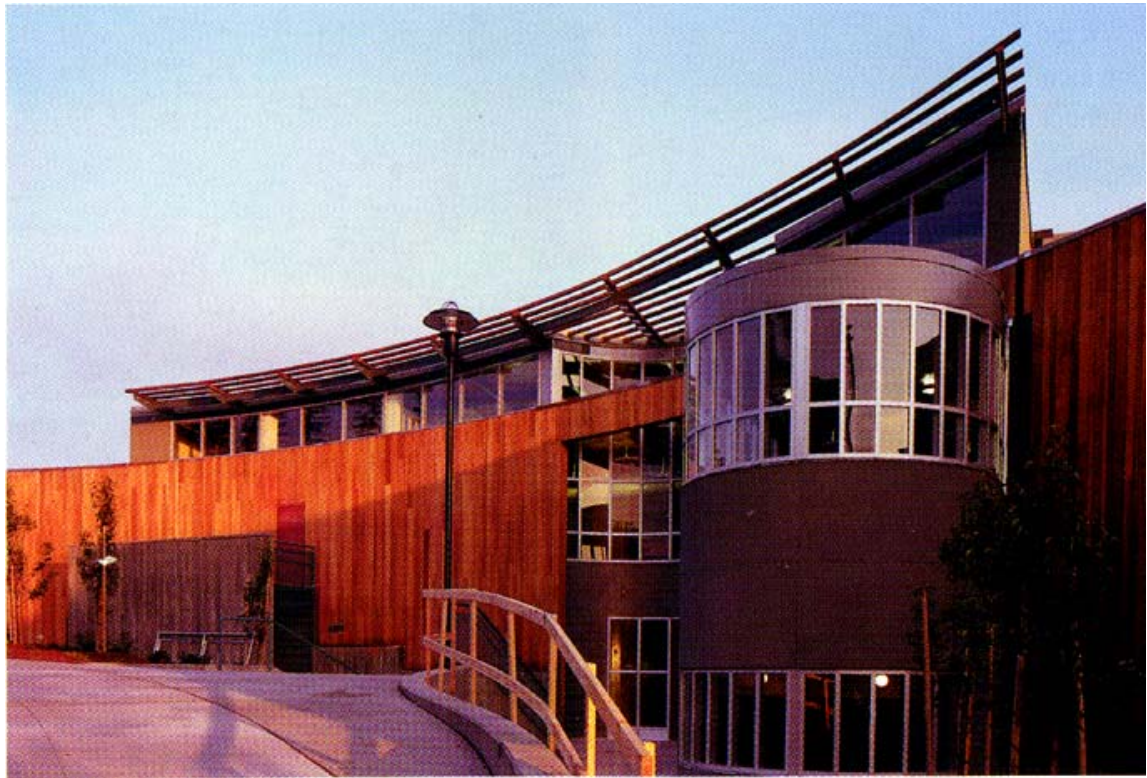

03/19/15 – Parks and Recreation Meeting

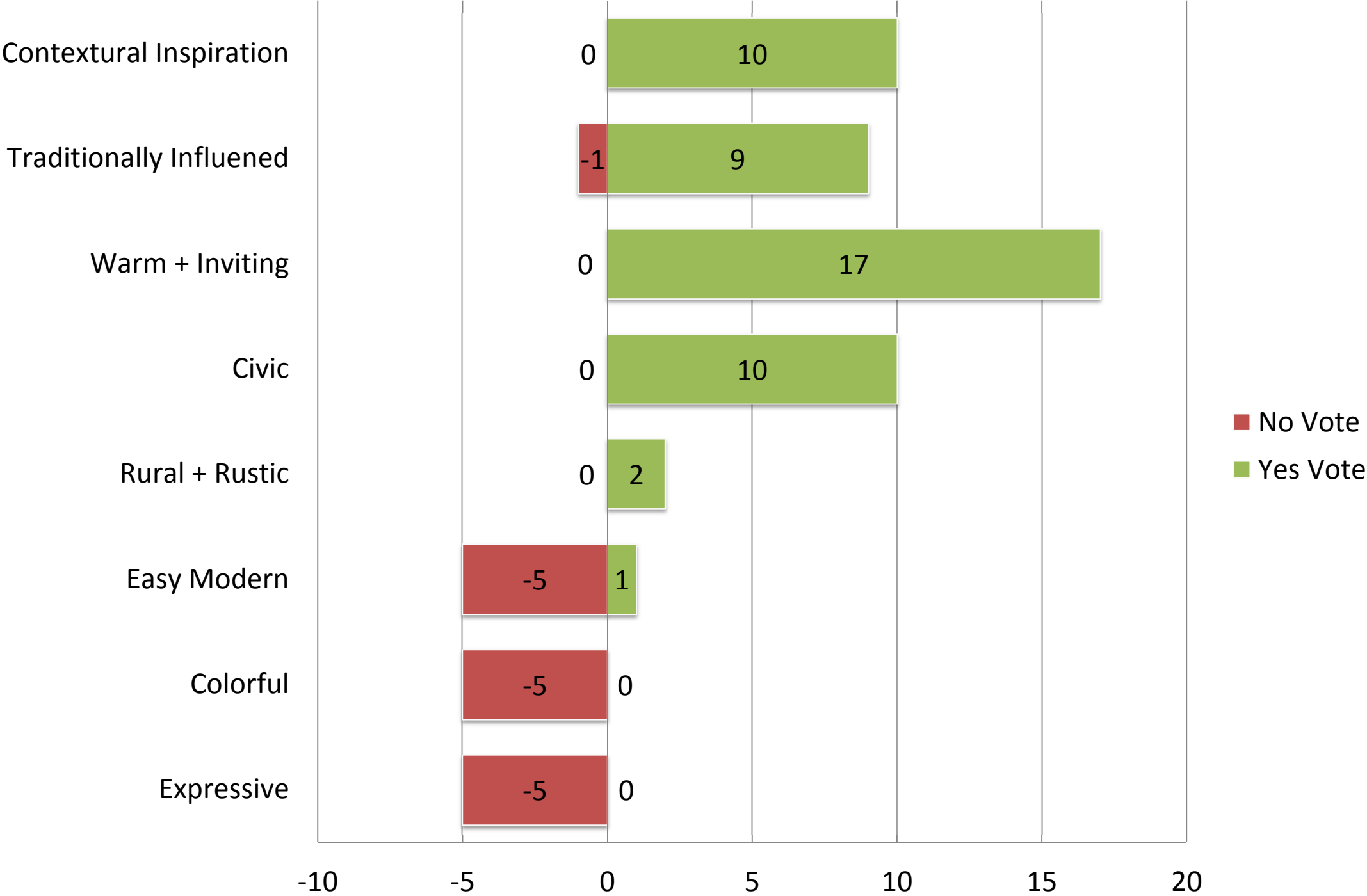

03/21/15 – Washington Park Open House

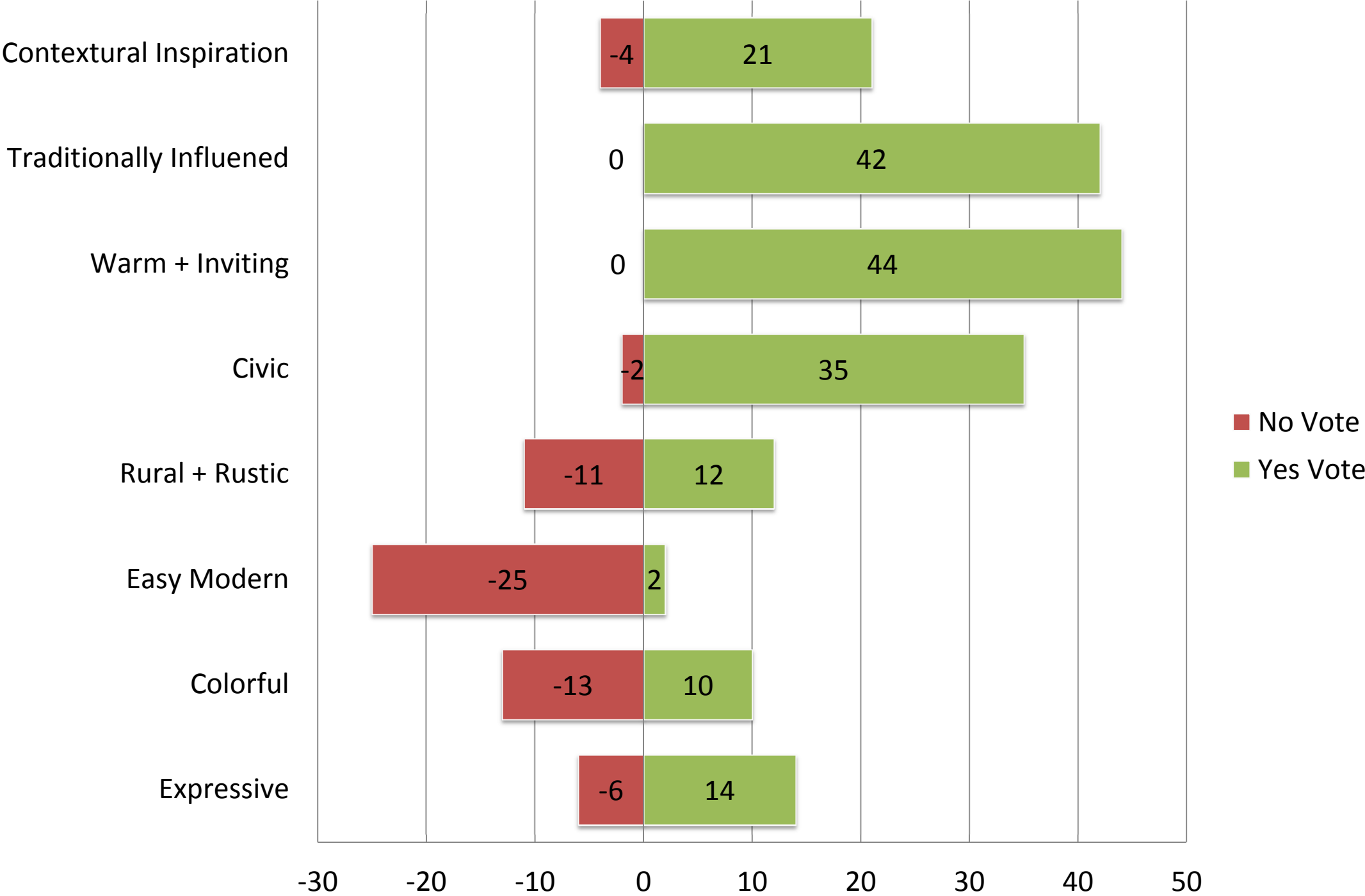

03/22/15 – Farmers Market Kiosk

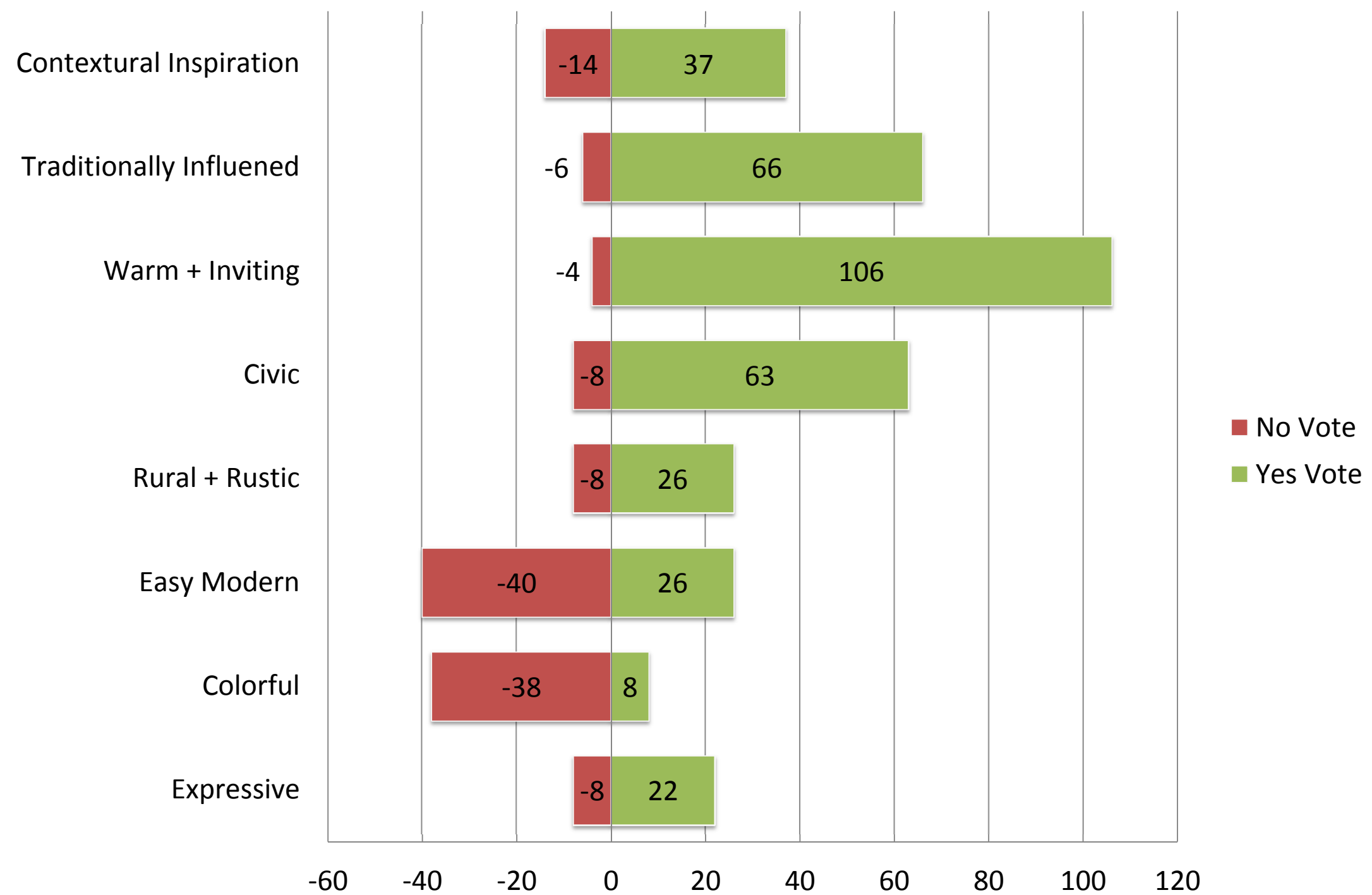

OUTREACH ROUND 1: Combined Results

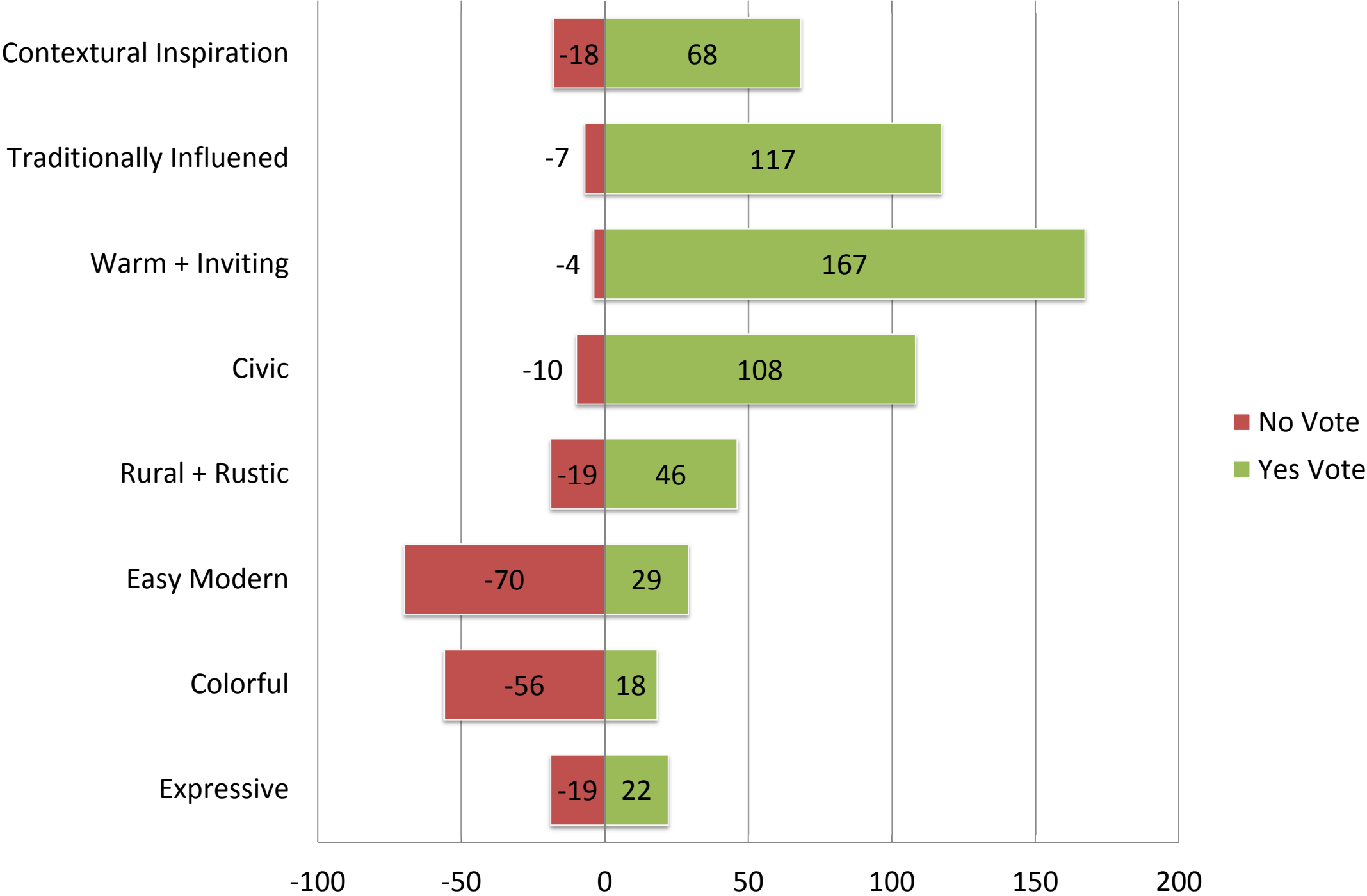



AGENDA

1. Project and Schedule Updates

- Work Plan
- Participation and Outreach Schedule
- Process and Outcome Goals

2. Program and Building Bubble Diagram Options

3. Design Values Exercise

4. Next Steps



NEXT STEPS

Community Outreach (*subject to change*)

TEEN/YOUTH OUTREACH

- ☐ Week of May 4th – Lunchtime Kiosks at Burlingame High School and Burlingame Intermediate School

ROUND 2

- ☐ MAY 30th: Community Open House, Washington Park, 10am-2pm
- ☐ MAY 31st: Community Kiosk, Farmers Market, 9am-1:30pm
- ☐ JUNE 18th: Parks & Recreation Commission, 7pm-8pm