

1150 Half Day Rd.
Highland Park, Illinois 60035
847.432.0807
cityhpil.com
August 13, 2020

Current Resident
Address
Highland Park, IL 60035

RE: Clavey Road Improvements Project – Larkspur Drive Access Closure

Dear Resident:

As a follow up to the recent Clavey Rd Improvements Project update letter, we are providing advance notification on Larkspur Drive access closure. During Phase One construction scheduled for 2021, access will be closed at Larkspur Drive due to the two-way traffic planned and proximity of Larkspur Drive to the bridge that is scheduled for replacement. **The Aspen Drive will remain open during Phase One Construction.** The City did a similar closure in recent years for the Concrete Replacement Project in the neighborhood.

The temporary closure will be removed with the completion of Phase One Construction, anticipated in Dec 2021 or earlier. No closure of Aspen Dr or Larkspur Dr is anticipated in Phase Two Construction, to be completed in 2022. Please see below plan sheet showing the Larkspur Dr closure:

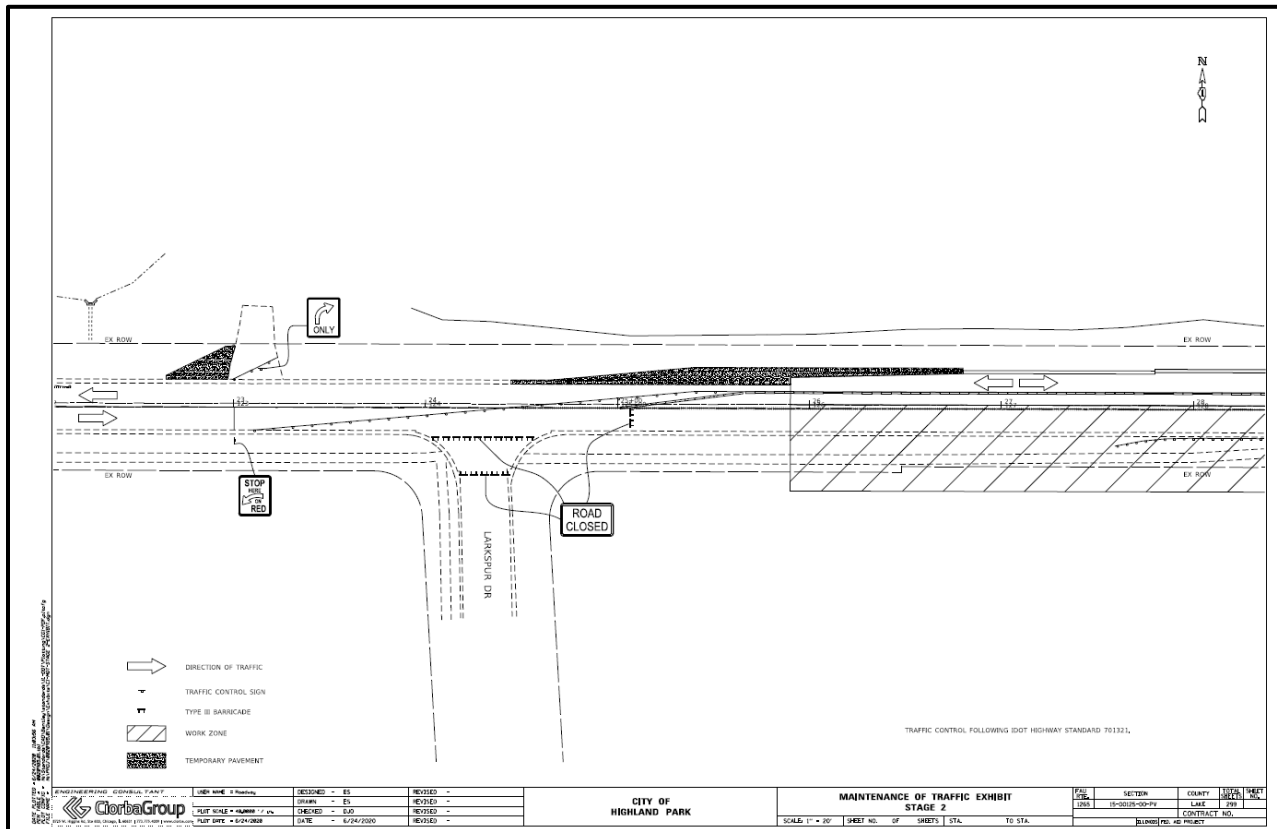

Additional communication will be sent prior to start of Phase One Construction. In addition, signs will be posted notifying motorists of the construction zones, access routes, and detour routes. Residents will be notified in advance of construction and the intersection closure.

Regular updates will be provided on City website during the construction of the project. And a dedicated project website is planned to provide enhanced communication to the residents and visitors during the construction of this project.

Information on this project is posted on City's website including project final plans, FAQ, and other pertinent information. https://www.cityhpil.com/projects_detail_T22_R40.php.

Please note traffic related congestion and temporary closures are to be expected due to the scale of the project. Also, inclement weather can adversely affect the construction schedule.

If you need additional information on this project or would like to be notified on project updates, please contact me at 847.432.0807 or via email at engineering@cityhpil.com

Thank you for the patience and understanding.

Sincerely,

A handwritten signature in black ink that reads "Emmanuel Gomez". The signature is written in a cursive style with a large, stylized 'E' and 'G'.

Emmanuel Gomez, P.E.
City Engineer

Cc: Ghida S. Neukirch, City Manager
Ramesh K. Kanapareddy, P.E., CFM, Director of Public Works