

LANDSCAPE REQUIREMENTS  
TABLE

Perimeter Setback Landscaping Along  
Street Right-of-Way

Required: (5,827 L.F. Frontage)  
1 tree / 25 l.f. (233 Trees)  
1 shrub / 15 l.f. (389 Shrubs)

Provided:  
107 Shade Trees  
119 Evergreen Trees  
304 Deciduous Shrubs  
85 Evergreen Shrubs

Foundation Landscaping:

Required: (702 L.F. - Office Only)  
1 tree / 25 l.f. (28 Trees)  
1 shrub / 10 l.f. (71 Shrubs)

Provided:  
24 Shade Trees  
4 Evergreen Trees  
43 Deciduous Shrubs  
56 Evergreen Shrubs

Screening from Residential

Required: (760 L.F. - Southeast Corner Only)  
1 evergreen tree /15 l.f. (51 Trees)

Provided:  
51 Evergreen Trees

Parking Lot Islands

Required:  
1 shade tree / 20 spaces (53 Trees)  
1 shade tree in each end island (32 Trees)

Provided:  
93 Shade Trees

LEGEND

Key	QTY.	Description
	11.30 AC.	EMERGENT SEED
	3.58 AC.	EMERGENT SEED & PLUGS
	2.29 AC.	WET MEADOW SEED & BLANKET
	6.63 AC.	LOW PROFILE PRAIRIE SEED & BLANKET
	75,696 S.F.	IRRIGATION (TO BE DESIGNER BY CONTRACTOR)
	30	NATURALIZED AREA SIGN

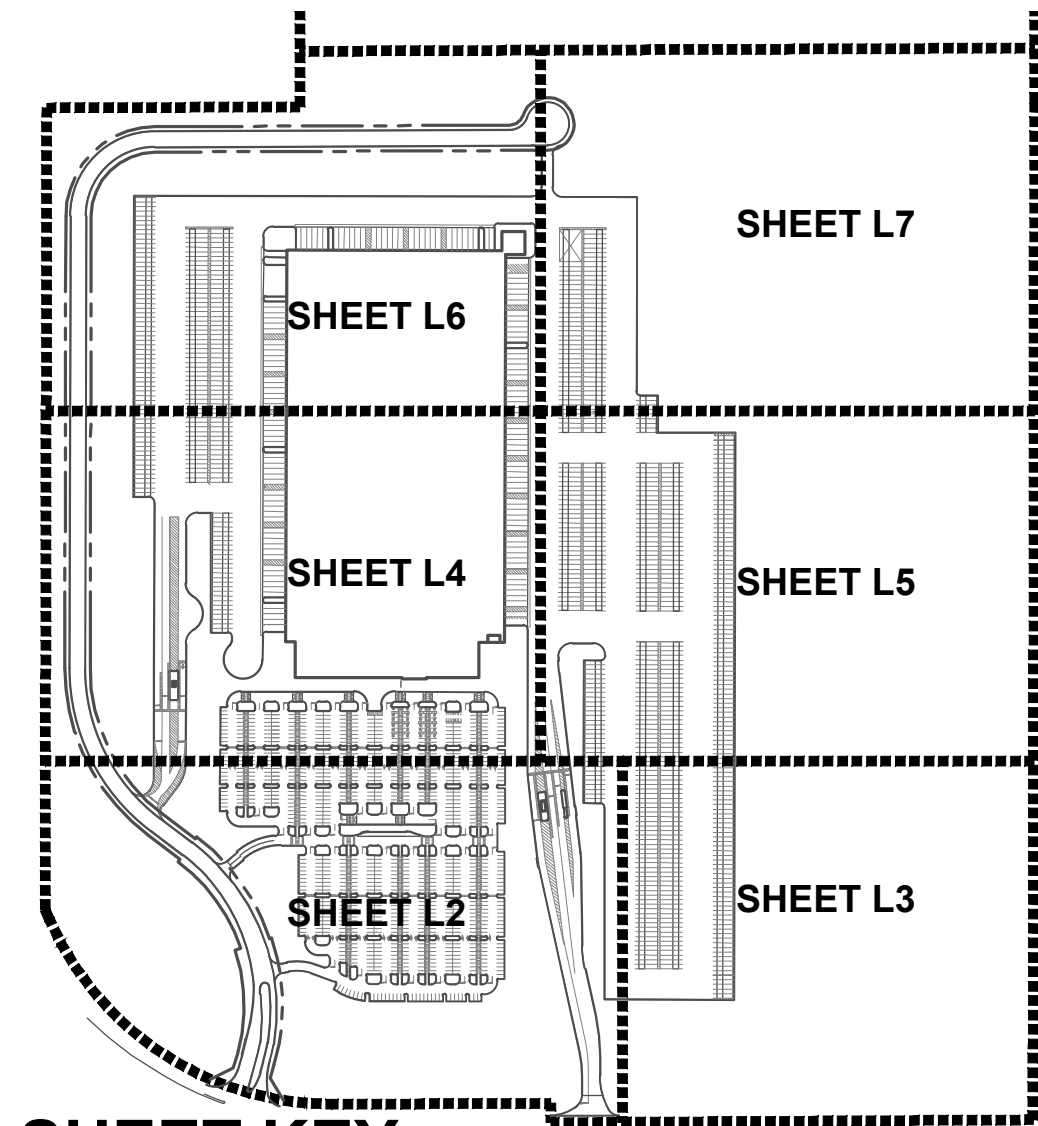

SHEET KEY  
SCALE: 1"=500'

PLANT LIST

Key	Qty	Botanical/Common Name	Size	Remarks
SHADE TREES				
AF	11	Acer x freemanii 'Marmo' MARMO FREEMAN MAPLE	2 1/2" Cal.	
AM	14	Acer miyabei 'Morton' STATE STREET MAPLE	2 1/2" Cal.	
AR	16	Acer rubrum 'Armstrong' ARMSTRONG RED MAPLE	2 1/2" Cal.	
AS	13	Acer x saccharum 'Green Mountain' GREEN MOUNTAIN SUGAR MAPLE	2 1/2" Cal.	
CO	21	Celtis occidentalis COMMON HACKBERRY	2 1/2" Cal.	
GT	23	Gleditsia triacanthos var. inermis 'Skycole' SKYLINE HONEYLOCUST	2 1/2" Cal.	
PM	14	Platanus x acerifolia 'Morton Circle' EXCLAMATION! LONDON PLANETREE	2 1/2" Cal.	
GB	16	Quercus bicolor SWAMP WHITE OAK	2 1/2" Cal.	
GM	20	Quercus macrocarpa BUR OAK	2 1/2" Cal.	
GR	21	Quercus rubra RED OAK	2 1/2" Cal.	
TC	12	Tilia cordata 'Greenspire' GREENSPIRE LITTLELEAF LINDEN	2 1/2" Cal.	
TT	17	Tilia tomentosa 'Sterling' STERLING SILVER LINDEN	2 1/2" Cal.	
UM	11	Ulmus 'Morton Glossy' TRIUMPH ELM	2 1/2" Cal.	
UC	13	Ulmus carpinifolia 'New Horizon' NEW HORIZON SMOOTHLEAF ELM	2 1/2" Cal.	
EVERGREEN TREES				
AC	38	Abies concolor WHITE FIR	6' Ht.	
PA	29	Picea abies NORWAY SPRUCE	6' Ht.	
PG	27	Picea glauca var. densata BLACK HILLS SPRUCE	6' Ht.	
PM	33	Picea omorika SERBIAN SPRUCE	6' Ht.	
PP	29	Picea pungens COLORADO SPRUCE	6' Ht.	
PS	22	Pinus strobus EASTERN WHITE PINE	6' Ht.	
DECIDUOUS SHRUBS				
CS	54	Cornus sericea 'Bailey' BAILEY'S REDTWIG DOGWOOD	24" Tall	5' O.C.
CF	31	Cornus sericea 'Farrow' ARCTIC FIRE REDTWIG DOGWOOD	24" Tall	4' O.C.
PO	16	Physocarpus opulifolius 'Dana May' LITTLE DEVIL NINEBARK	24" Tall	4' O.C.
PK	85	Physocarpus opulifolius 'Seward' SUMMER WINE NINEBARK	24" Tall	5' O.C.
SM	74	Syringa meyeri 'Paladin' DWARF KOREAN LILAC	24" Tall	4' O.C.
VT	87	Viburnum trilobum 'Redwing' JN SELECT CRANBERRYBUSH VIBURNUM	24" Tall	5' O.C.
EVERGREEN SHRUBS				
JK	141	Juniperus chinensis 'Kallaya Compact' KALLAYS COMPACT PFITZER JUNIPER	24" Wide	4' O.C.
ORNAMENTAL GRASSES				
CK	75	Calamagrostis x acutiflora 'Karl Foerster' FEATHER REED GRASS	#1	30" O.C.
PH	40	Panicum virgatum 'Heavy Metal' HEAVY METAL SWITCHGRASS	#1	30" O.C.
PERENNIALS				
HH	82	Hemerocallis 'Happy Returns' HAPPY RETURNS DAYLILY	#1	18" O.C.
HL	16	Hemerocallis 'Little Wine Cup' LITTLE WINE CUP DAYLILY	#1	18" O.C.
MISC. MATERIALS				
	204	DECORATIVE STONE MULCH	C.Y.	
	1,114	STEEL LANDSCAPE EDGING	L.F.	
	2,435	SOD	S.Y.	
	17.27	TURF SEED & EROSION CONTROL BLANKET	AC.	

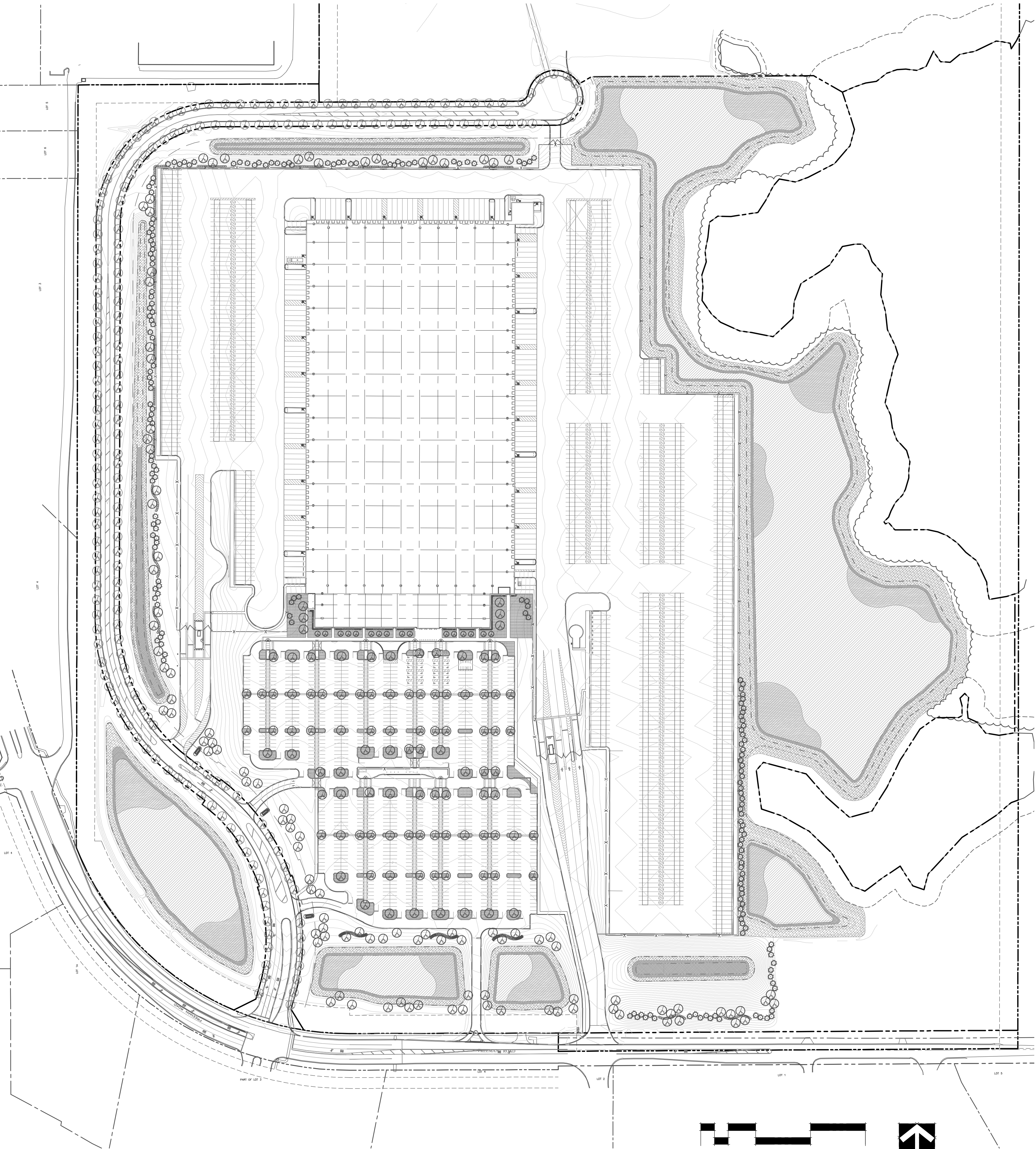

**GR**  
**WA**  
GARY R. WEBER  
ASSOCIATES, INC.  
LAND PLANNING  
ECOLOGICAL CONSULTING  
LANDSCAPE ARCHITECTURE  
402 WEST LIBERTY DRIVE  
WHEATON, ILLINOIS 60187  
PHONE: 630-668-7197

ENVIRONMENTAL  
ENGINEER  
JACOB & HEFNER  
ASSOCIATES, INC.  
1333 BUTTERFIELD ROAD, SUITE 300  
DOWNERS GROVE, ILLINOIS 60515

PROJECT PUMPKIN  
HUNTLEY, ILLINOIS  
OVERALL LANDSCAPE PLAN

1	2.08.2021
REVISIONS	

DATE 1.11.2021  
PROJECT NO. JH2078  
DRAWN GFB  
CHECKED MGM  
SHEET NO.

L1





GARY R. WEBER  
ASSOCIATES, INC.  
LAND PLANNING  
ECOLOGICAL CONSULTING  
LANDSCAPE ARCHITECTURE  
402 WEST LIBERTY DRIVE  
WHEATON, ILLINOIS 60187  
PHONE: 630-668-7197

CIVIL ENGINEER  
JACOB & HEFNER  
ASSOCIATES, INC.  
1333 BUTTERFIELD ROAD, SUITE 300  
DOWNERS GROVE, ILLINOIS 60515

# PROJECT PUMPKIN HUNTLEY, ILLINOIS LANDSCAPE PLAN

MATCH LINE  
SEE SHEET L5

MATCH LINE - SEE SHEET L4

MATCH LINE - SEE SHEET L3

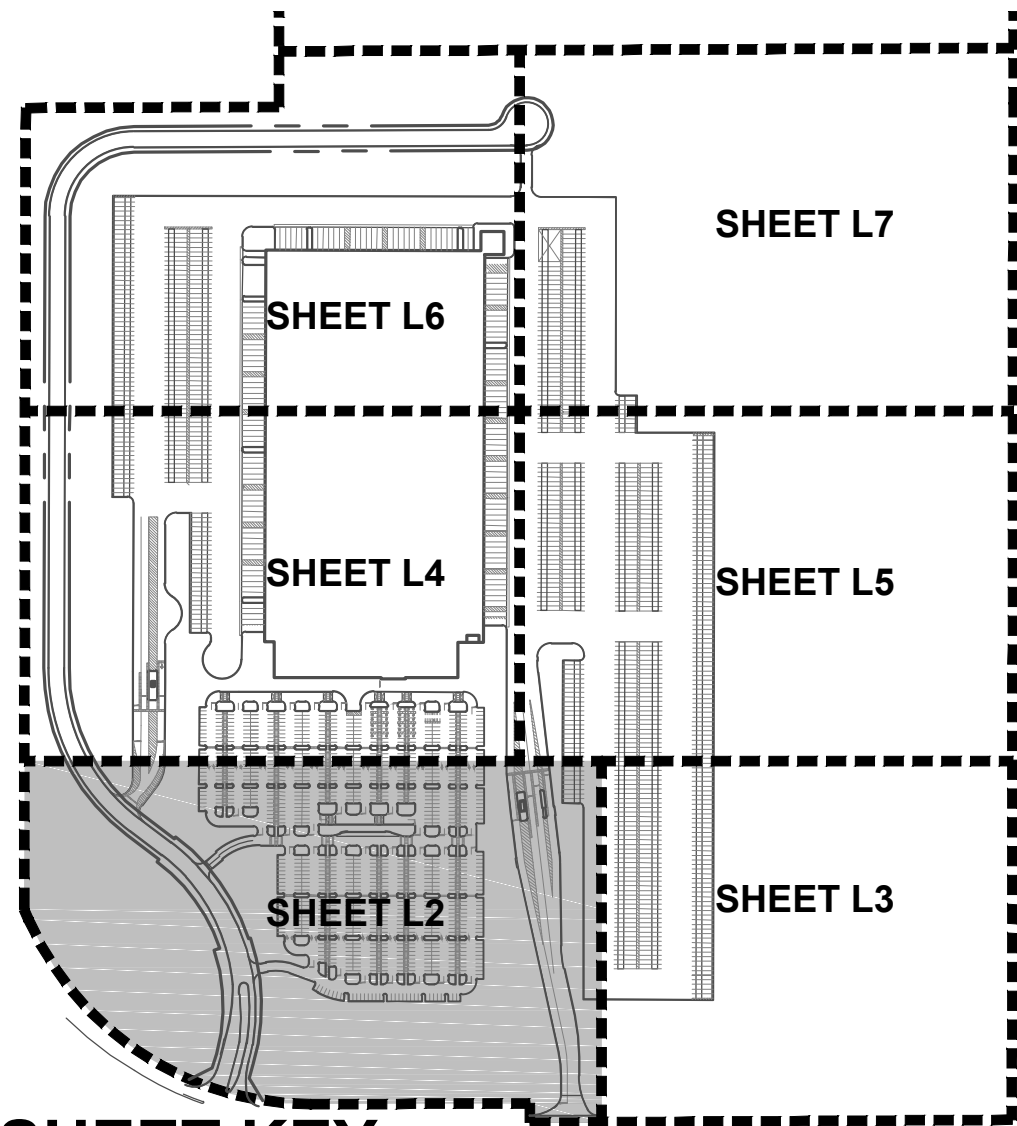

**SHEET KEY**  
SCALE: 1"=500'

## LEGEND

Key	Description
	EMERGENT SEED
	EMERGENT SEED & PLUGS
	WET MEADOW SEED & BLANKET
	LOW PROFILE PRAIRIE SEED & BLANKET
	IRRIGATION (TO BE DESIGNER BY CONTRACTOR)
	NATURALIZED AREA SIGN (SEE QUANTITIES ON SHEET L1)

## GENERAL LANDSCAPE NOTES

- Contractor shall verify underground utility lines and is responsible for any damage.
- Contractor shall verify all existing conditions in the field prior to construction and shall notify landscape architect of any variance.
- Material quantities shown are for contractors convenience only. The Contractor must verify all material and supply sufficient materials to complete the job per plan.
- The landscape architect reserves the right to inspect plant materials either at place of growth or at site before planting, for compliance with requirements of variety, size and quality.
- Work shall conform to American Standard for Nursery Stock, State of Illinois Horticultural Standards, and Local Municipal requirements.
- Contractor shall secure and pay for all permits, fees, and inspections necessary for the proper execution of this work and comply with all codes applicable to this work.
- See General Conditions and Specifications for landscape work for additional requirements.

0' 30' 60' 120' 180'  
SCALE: 1"=60'



1 2.08.2021  
REVISIONS

DATE 1.11.2021  
PROJECT NO. JH2078  
DRAWN GFB  
CHECKED MGM  
SHEET NO.

L2





## NATIVE SEED MIXTURES

## Temporary Cover Crop

Cover crops shall be installed in all planting areas containing dry mesic, mesic, and wet mesic soils to, stabilize soils, and combat weed pressure during the germination and establishment of the native seeding area.

Botanical Name	Common Name	lbs / AC
<strong>Spring Cover Crop</strong>		
<i>Avena sativa</i>	Seed Oats	30.000
<strong>Fall or Dormant Cover Crop</strong>		
<i>Triticum aestivum</i>	Regreen	10.000

## Emergent Wetland Plant Mix

Stormwater basin bottoms in areas with 6" of water

Botanical Name	Common Name	lbs / AC	Plugs / AC.
<i>Acorus calamus</i>	Sweet Flag	0.500	494
<i>Alisma subcordatum</i>	Water Plantain	1.250	
<i>Iris virginica shrevei</i>	Blue Flag	0.500	494
<i>Juncus effusus</i>	Common Rush	0.500	
<i>Leersia oryzoides</i>	Rice Cut Grass	1.250	494
<i>Pontederia cordata</i>	Pickernel Weed	0.250	494
<i>Sagittaria latifolia</i>	Common Arrowhead	1.250	494
<i>Scirpus acutus</i>	Hardstem Bulrush	0.500	988
<i>Scirpus fluviatilis</i>	River Bulrush	1.000	494
<i>Scirpus pungens</i>	Chairmaker's Rush	0.250	
<i>Scirpus validus</i>	Great Bulrush	0.500	988
<i>Sparganium eurycarpum</i>	Bur Reed	1.000	494
<strong>Total Emergent Wetland Mix</strong>		<strong>8.750</strong>	<strong>5434</strong>

## Wet Meadow Seed Mixture

Lower slopes of basin

Botanical Name	Common Name	lbs / AC
<strong>Grasses / Sedges</strong>		
<i>Carex bebbii</i>	Bebbs Oval Sedge	0.250
<i>Carex bicknellii</i>	Bicknell's Sedge	0.125
<i>Carex brevior</i>	Plains Oval Sedge	0.250
<i>Carex cristatella</i>	Crested Oval Sedge	0.060
<i>Carex molesta</i>	Field Oval Sedge	0.250
<i>Carex normalis</i>	Spreading Oval Sedge	0.015
<i>Carex scoroparia</i>	Pointed Broom Sedge	0.190
<i>Carex stipata</i>	Common Fox Sedge	0.060
<i>Carex vulpinoidea</i>	Brown Fox Sedge	0.250
<i>Elymus virginicus</i>	Virginia Wild Rye	3.000
<i>Glyceria striata</i>	Fowl Manna Grass	0.130
<i>Juncus dudleyi</i>	Dudleys Rush	0.020
<i>Juncus torreyi</i>	Torreys Rush	0.031
<i>Panicum virgatum</i>	Switch Grass	3.000
<i>Scirpus atrovirens</i>	Dark Green Bulrush	0.060
<i>Scirpus cyperinus</i>	Wool Grass	0.030
<strong>Total Grasses / Sedges</strong>		<strong>7.721</strong>

## Wildflowers/Broadleaves

<i>Asclepias incarnata</i>	Swamp Milkweed	0.125
<i>Bidens cernua</i>	Nodding Bur Marigold	0.190
<i>Boltonia asteroides</i>	False Aster	0.031
<i>Chamaecrista fasciculata</i>	Partridge pea	0.188
<i>Euthamia graminifolia</i>	Grassleaved Goldenrod	0.300
<i>Eupatorium perfoliatum</i>	Common Boneset	0.015
<i>Helenium autumnale</i>	Sneezeweed	0.063
<i>Iris virginica shrevei</i>	Blue Flag Iris	1.000
<i>Lobelia siphilitica</i>	Great Blue Lobelia	0.031
<i>Mimulus rmgens</i>	Monkey Flower	0.031
<i>Symphotrichum novae-angliae</i>	New England Aster	0.250
<i>Pycnanthemum virginianum</i>	Common Mountain Mint	0.063
<i>Rudbeckia fulgida var. sullivantii</i>	Common Black-Eyed Susan	0.250
<i>Zizia aurea</i>	Golden Alexanders	0.500

## Low Profile Prairie with Flowers Seed Mix

Upper basin slopes

Botanical Name	Common Name	lbs / AC
<strong>Grasses</strong>		
<i>Bouteloua curtipendula</i>	Side Oats Grama	8.000
<i>Panicum virgatum</i>	Prairie Switch Grass	0.125
<i>Elymus trachycaulis</i>	Slender Wheatgrass	2.000
<i>Elymus canadensis</i>	Prairie Wild Rye	1.000
<i>Schizachyrium scoparium</i>	Little Bluestem	6.000
<strong>Total Grasses</strong>		<strong>17.125</strong>
<strong>Wildflowers/Broadleaves</strong>		
<i>Allium cernuum</i>	Nodding Wild Onion	0.190
<i>Amorpha canescens</i>	Lead Plant	0.125
<i>Asclepias canadensis</i>	Whorled Milkweed	0.063
<i>Asclepias tuberosa</i>	Butterflyweed	0.500
<i>Astragalus canadensis</i>	Canada Milk Vetch	0.063
<i>Coreopsis palmata</i>	Prairie Coreopsis	0.025
<i>Echinacea pallida</i>	Pale Purple Coneflower	1.000
<i>Echinacea purpurea</i>	Purple Coneflower	0.500
<i>Eryngium yuccifolium</i>	Rattlesnake Master	0.125
<i>Lespedeza capitata</i>	Round-Headed Bush Clover	0.125
<i>Liatris aspera</i>	Rough Blazing Star	0.250
<i>Liatris pycnostachya</i>	Prairie Blazing Star	0.188
<i>Monarda fistulosa</i>	Prairie Bergamot	0.063
<i>Parthenium integrifolium</i>	Wild Quinine	0.016
<i>Penstemon digitalis</i>	Foxglove Beard Tongue	0.125
<i>Petalostemum candidum</i>	White Prairie Clover	0.125
<i>Petalostemum purpureum</i>	Purple Prairie Clover	0.156
<i>Potentilla arguta</i>	Prairie Cinquefoil	0.031
<i>Pycnanthemum tenuifolium</i>	Slender Mountain Mint	0.031
<i>Ratibida pinnata</i>	Yellow Coneflower	0.125
<i>Rudbeckia fulgida var. sullivantii</i>	Showy Black-Eyed Susan	0.500
<i>Rudbeckia hirta</i>	Black-Eyed Susan	0.500
<i>Rudbeckia subtomentosa</i>	Sweet Black-Eyed Susan	0.063
<i>Symphotrichum leave</i>	Smooth Blue Aster	0.063
<i>Tradescantia ohimensis</i>	Common Spiderwort	0.063
<i>Verbena stricta</i>	Hoary Vervain	0.125
<i>Zizia aurea</i>	Golden Alexanders	0.500
<strong>Total Forbs</strong>		<strong>5.640</strong>
<strong>Total Low Profile Prairie Seed Mix</strong>		<strong>22.765</strong>

MATCH LINE - SEE SHEET L2

MATCH LINE - SEE SHEET L5

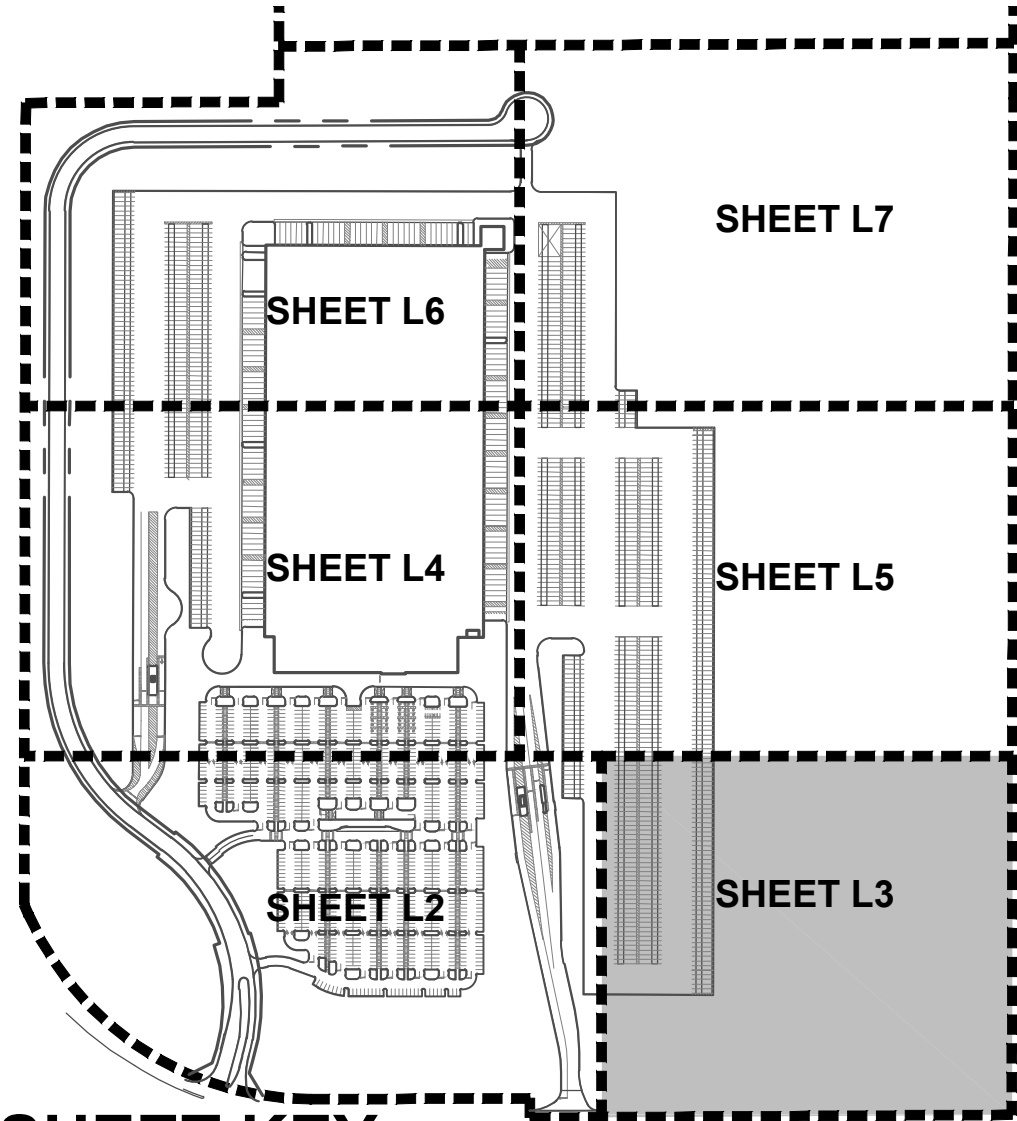
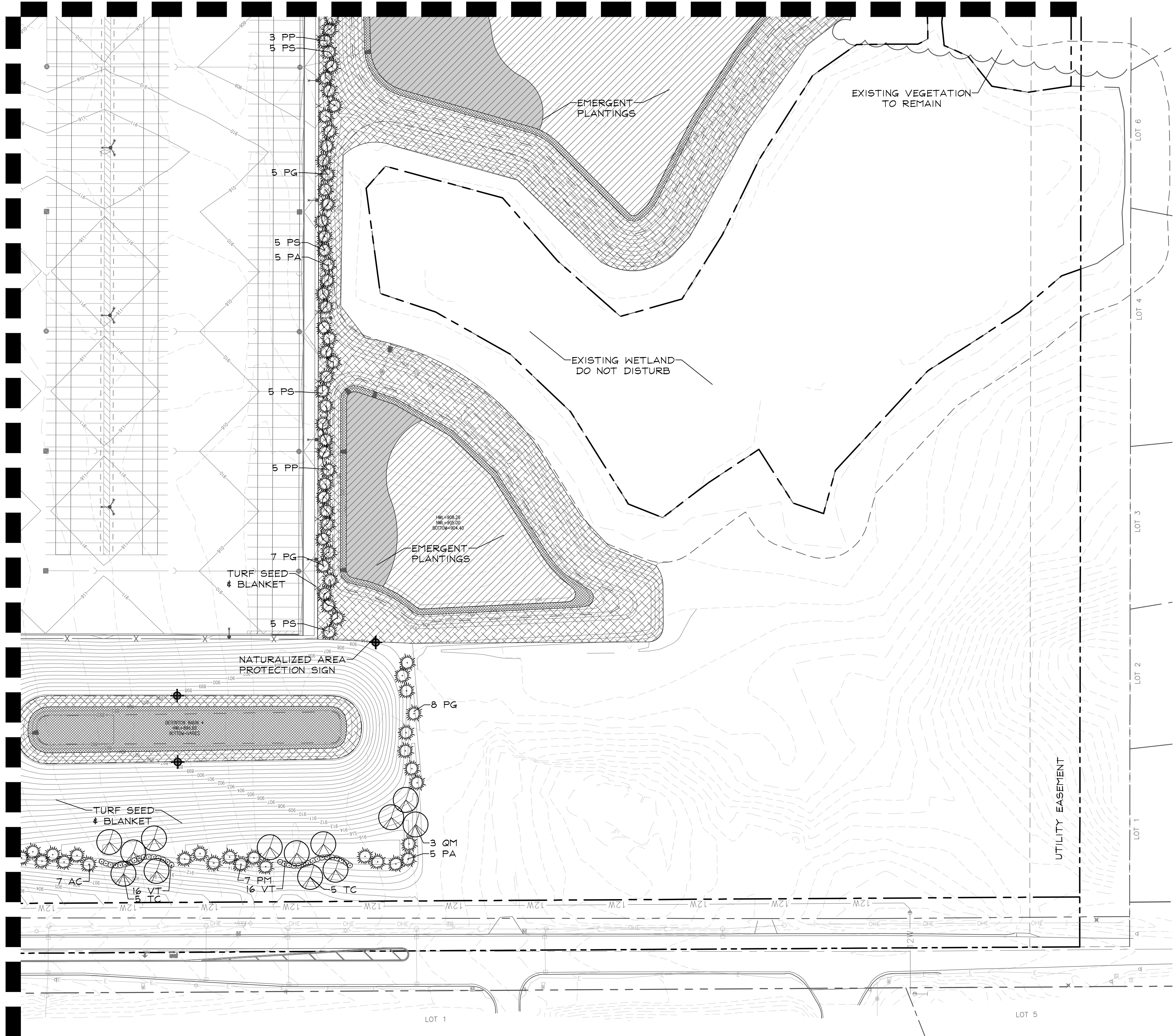

**SHEET KEY**  
SCALE: 1"=500'

## LEGEND

Key	Description
	EMERGENT SEED
	EMERGENT SEED & PLUGS
	WET MEADOW SEED & BLANKET
	LOW PROFILE PRAIRIE SEED & BLANKET
	IRRIGATION (TO BE DESIGNER BY CONTRACTOR)
	NATURALIZED AREA SIGN

(SEE QUANTITIES ON SHEET L1)

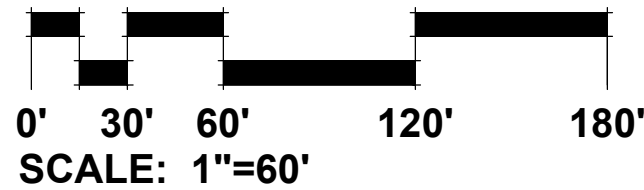

**GRWA**  
**GARY R. WEBER**  
**ASSOCIATES, INC.**  
LAND PLANNING  
ECOLOGICAL CONSULTING  
LANDSCAPE ARCHITECTURE  
402 WEST LIBERTY DRIVE  
WHEATON, ILLINOIS 60187  
PHONE: 630-668-7197

CIVIL ENGINEER  
**JACOB & HEFNER**  
**ASSOCIATES, INC.**  
1333 BUTTERFIELD ROAD, SUITE 300  
DOWNERS GROVE, ILLINOIS 60515

**PROJECT PUMPKIN**  
HUNTLEY, ILLINOIS  
**LANDSCAPE PLAN**

1 2.08.2021  
REVISIONS

DATE 1.11.2021  
PROJECT NO. JH2078  
DRAWN GFB  
CHECKED MGM  
SHEET NO.

**L3**





GARY R. WEBER  
ASSOCIATES, INC.  
LAND PLANNING  
ECOLOGICAL CONSULTING  
LANDSCAPE ARCHITECTURE  
402 WEST LIBERTY DRIVE  
WHEATON, ILLINOIS 60187  
PHONE: 630-668-7197

CIVIL ENGINEER  
JACOB & HEFNER  
ASSOCIATES, INC.  
1333 BUTTERFIELD ROAD, SUITE 300  
DOWNERS GROVE, ILLINOIS 60515

# PROJECT PUMPKIN

HUNTLEY, ILLINOIS

## LANDSCAPE PLAN

1 2.08.2021  
REVISIONS

DATE 1.11.2021  
PROJECT NO. JH2078  
DRAWN GFB  
CHECKED MGM  
SHEET NO.

L4

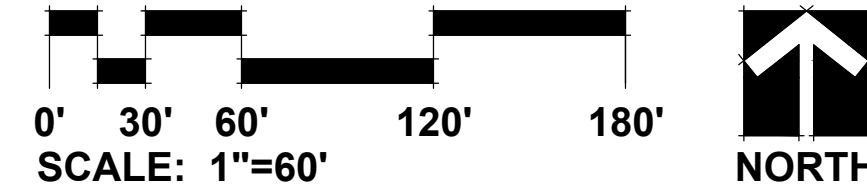
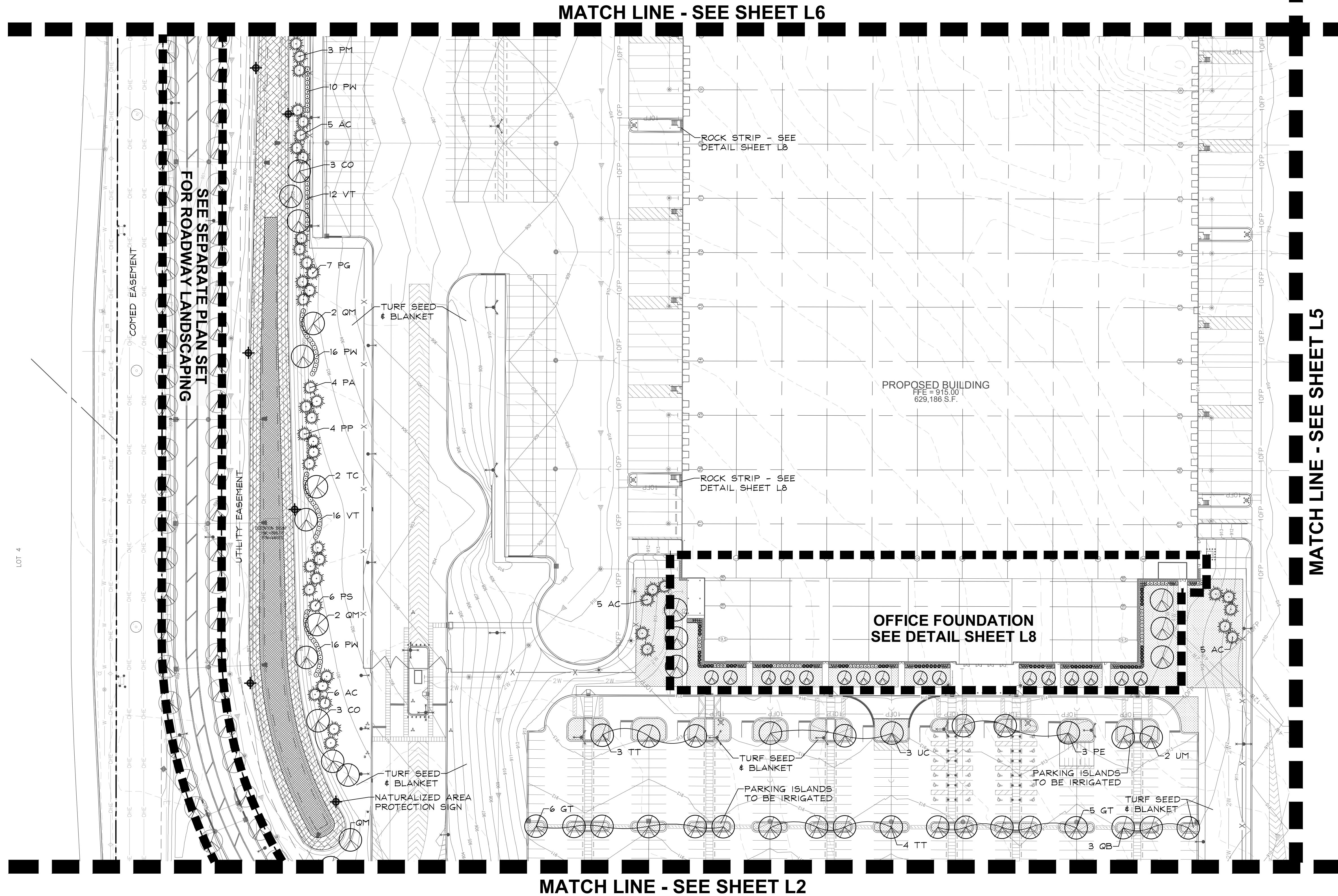

- LEGEND**
- | Key       | Description                               |
|-----------|---|
| [Pattern] | EMERGENT SEED                             |
| [Pattern] | EMERGENT SEED & PLUGS                     |
| [Pattern] | WET MEADOW SEED & BLANKET                 |
| [Pattern] | LOW PROFILE PRAIRIE SEED & BLANKET        |
| [Pattern] | IRRIGATION (TO BE DESIGNER BY CONTRACTOR) |
| [Symbol]  | NATURALIZED AREA SIGN                     |
- (SEE QUANTITIES ON SHEET L1)

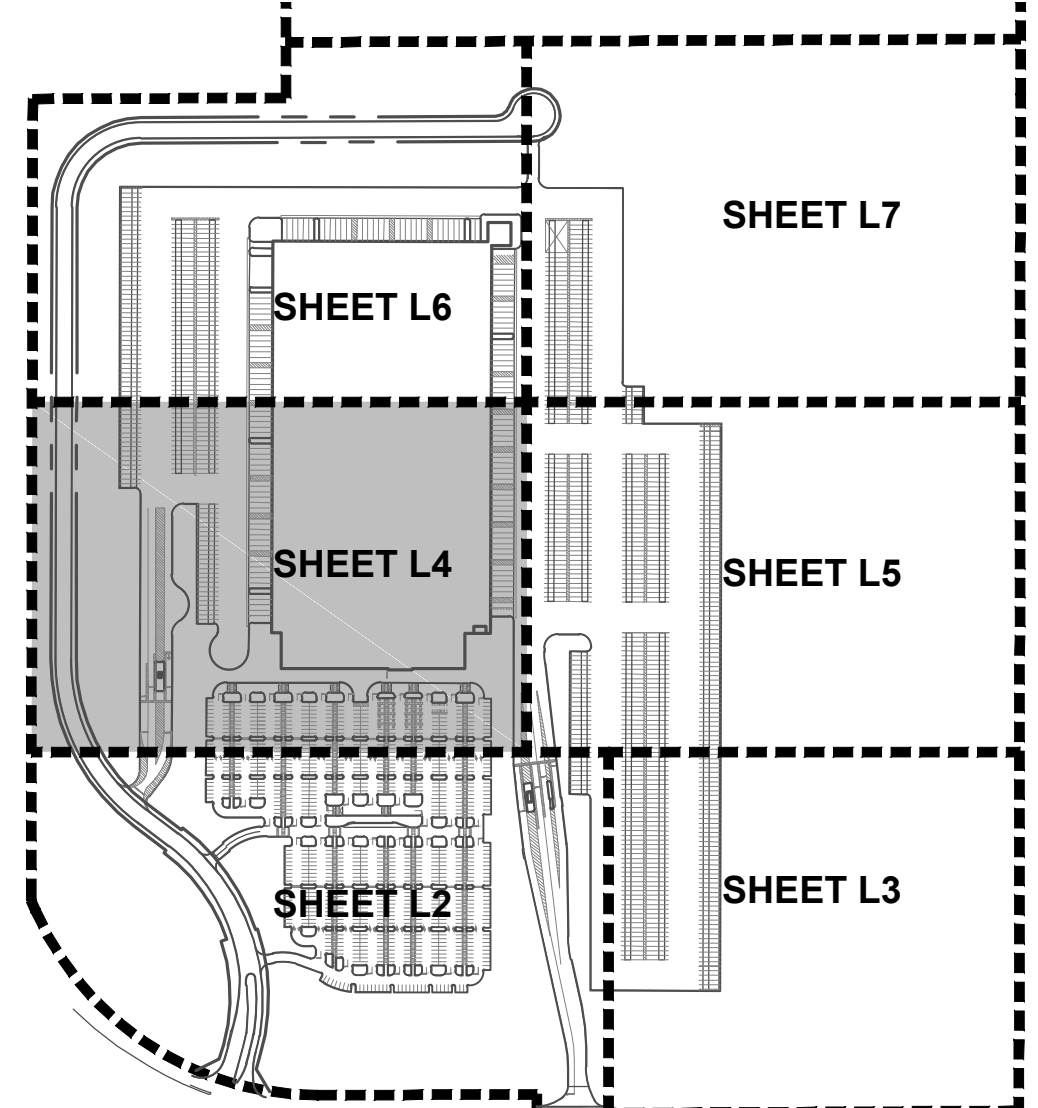

**SHEET KEY**  
SCALE: 1"=500'

NOT CONTOUR SHEETS



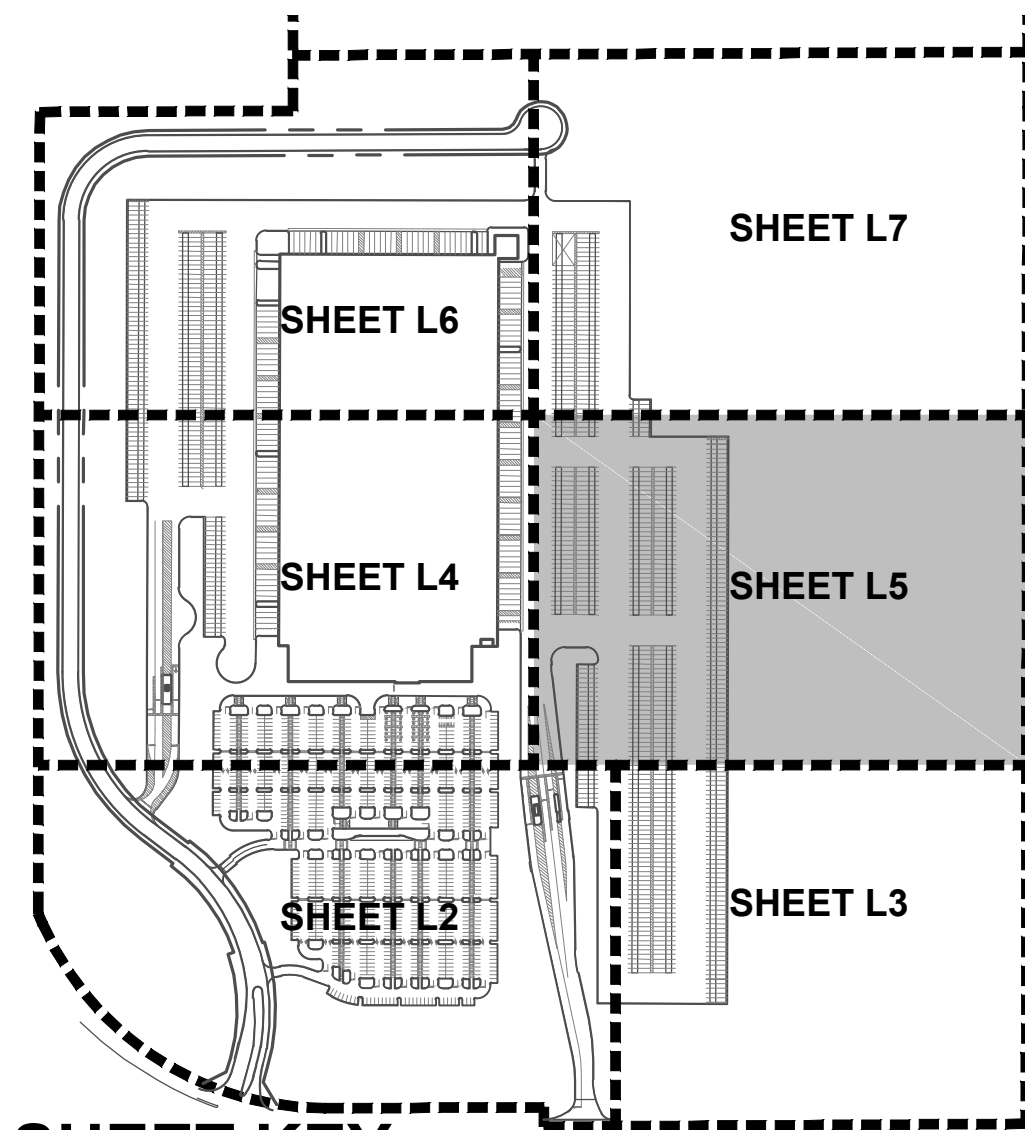
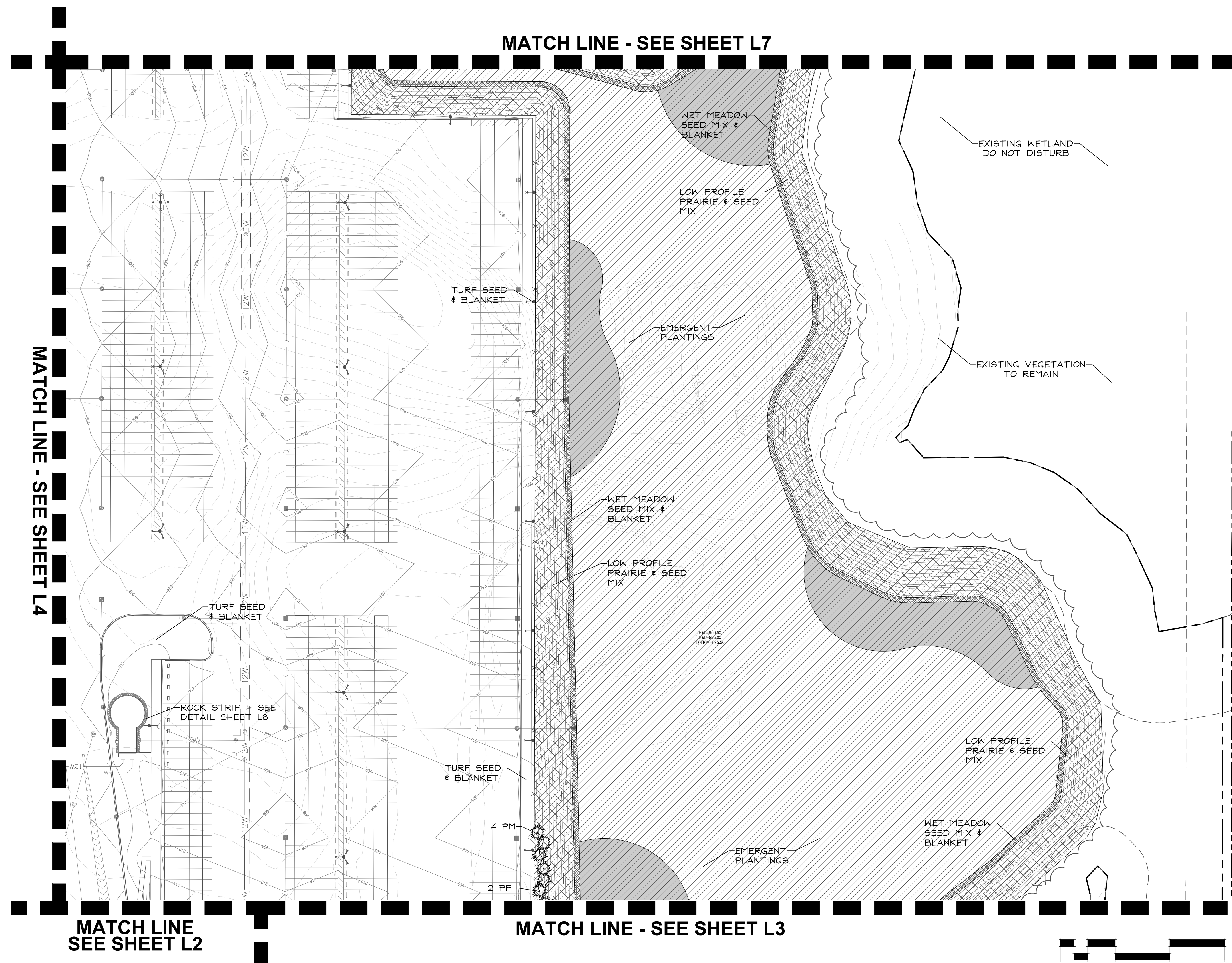

### LEGEND

Key	Description
	EMERGENT SEED
	EMERGENT SEED & PLUGS
	WET MEADOW SEED & BLANKET
	LOW PROFILE PRAIRIE SEED & BLANKET
	IRRIGATION (TO BE DESIGNER BY CONTRACTOR)
	NATURALIZED AREA SIGN (SEE QUANTITIES ON SHEET L1)

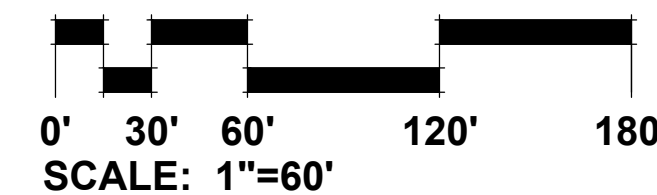

**GRWA**  
GARY R. WEBER  
ASSOCIATES, INC.  
LAND PLANNING  
ECOLOGICAL CONSULTING  
LANDSCAPE ARCHITECTURE  
402 WEST LIBERTY DRIVE  
WHEATON, ILLINOIS 60187  
PHONE: 630-668-7197

CIVIL ENGINEER  
**JACOB & HEFNER  
ASSOCIATES, INC.**  
1333 BUTTERFIELD ROAD, SUITE 300  
DOWNERS GROVE, ILLINOIS 60515

## PROJECT PUMPKIN HUNTLEY, ILLINOIS LANDSCAPE PLAN

1 2.08.2021  
REVISIONS

DATE 1.11.2021  
PROJECT NO. JH2078  
DRAWN GFB  
CHECKED MGM  
SHEET NO.



L5



**PROJECT PUMPKIN**  
HUNTLEY, ILLINOIS  
**LANDSCAPE PLAN**

1 2.08.2021  
REVISIONS

DATE 1.11.2021  
PROJECT NO. JH2078  
DRAWN GFB  
CHECKED MGM  
SHEET NO.

**L6**

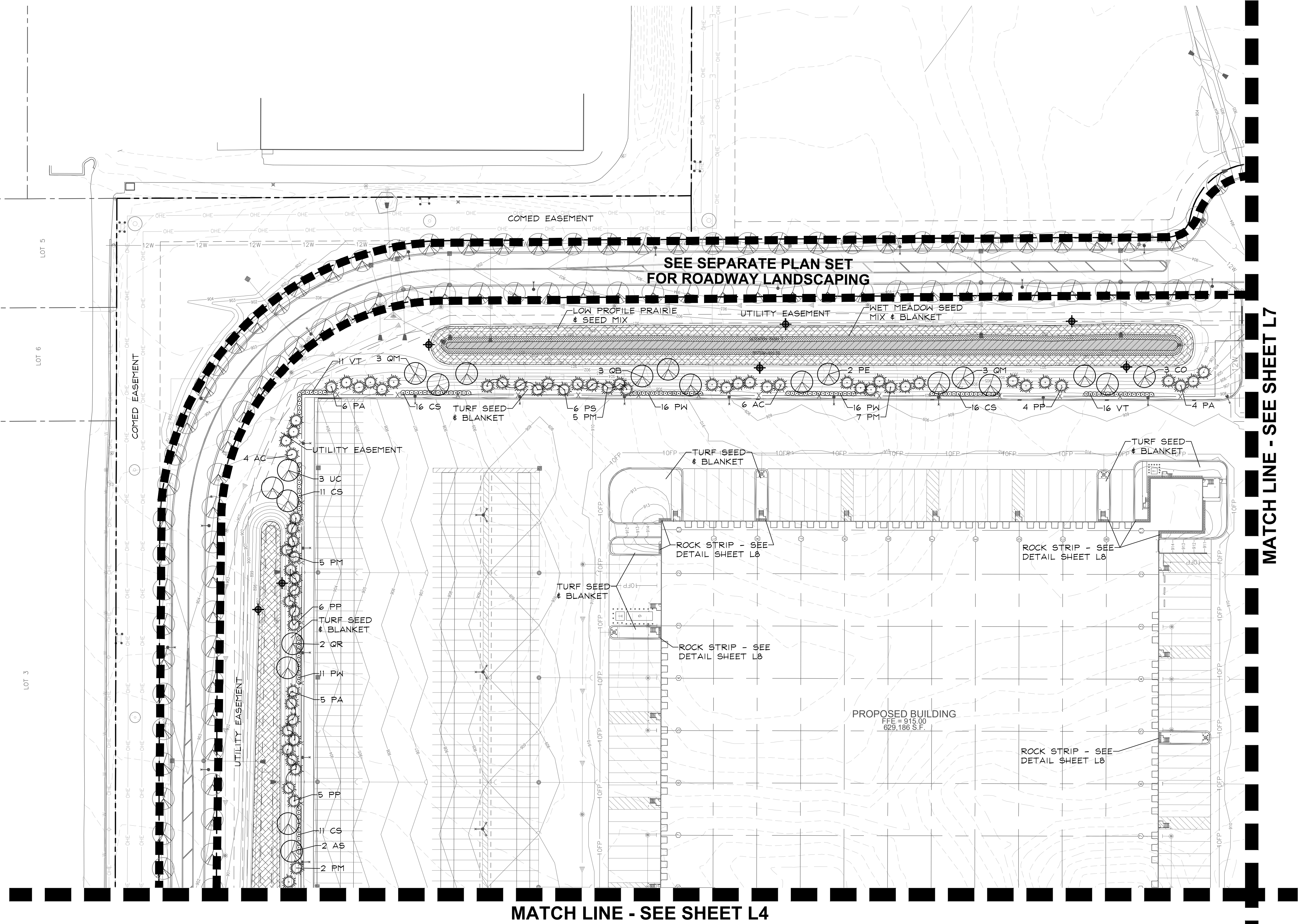

- SIGN NOTES:
- SIGN BACKGROUND COLOR:  
C=40, M=70, Y=100, K=28  
SIGN FONT AND GRAPHIC COLOR: WHITE
  - FONT STYLE: MYRIAD PRO  
FONT SIZE: 116 PT.
  - SIGN ARTWORK SHALL BE PROVIDED BY  
GARY R. WEBER ASSOCIATES, INC.
  - CONTRACTOR TO SUBMIT SHOP DRAWING  
AND COLOR SAMPLE FOR THE  
STORMWATER MANAGEMENT AREA SIGN  
FOR REVIEW AND APPROVAL BY THE  
LANDSCAPE ARCHITECT PRIOR TO  
FABRICATION AND INSTALLATION.

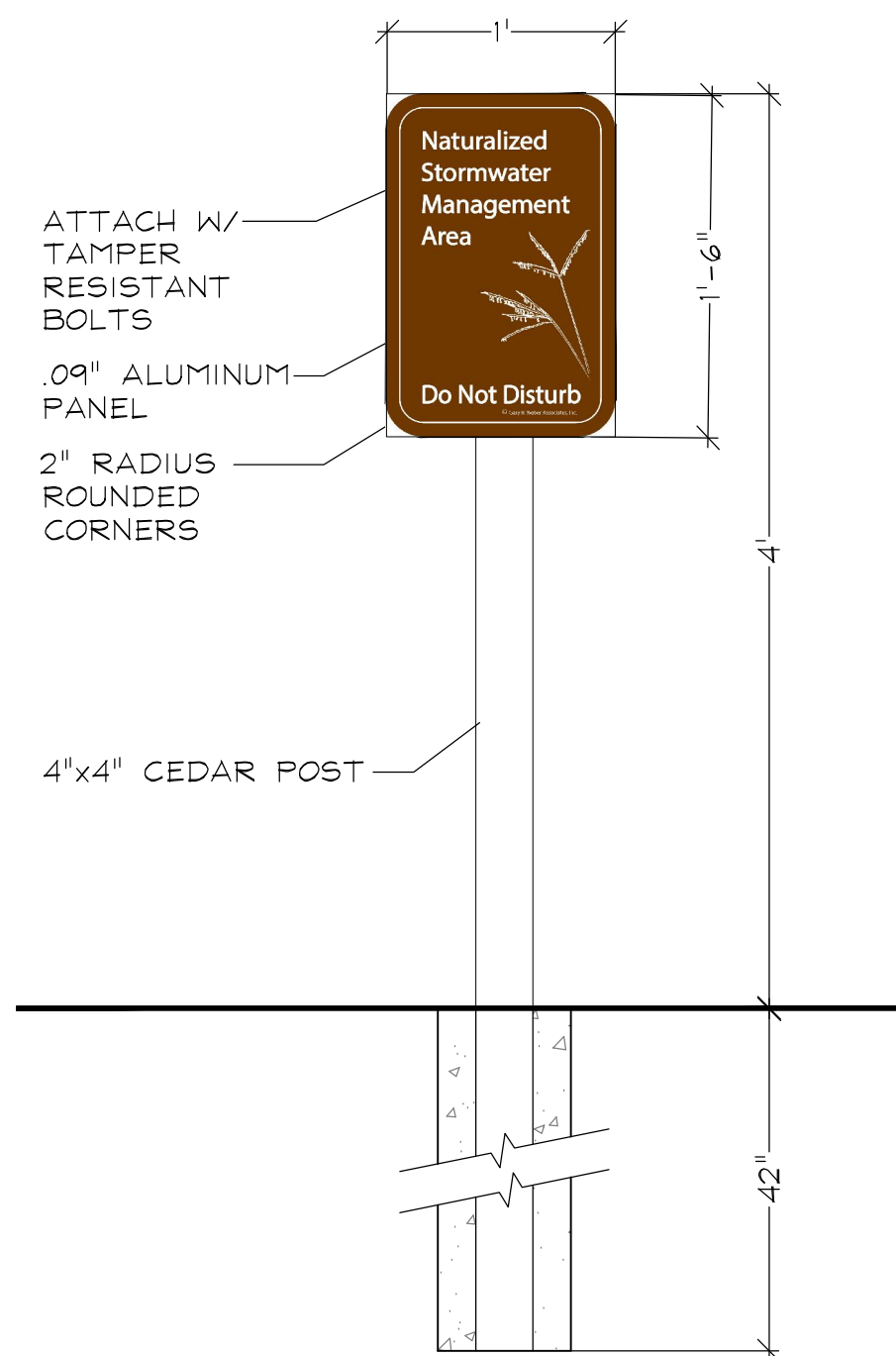

**NATURALIZED AREA  
SIGN DETAIL**  
NOT TO SCALE

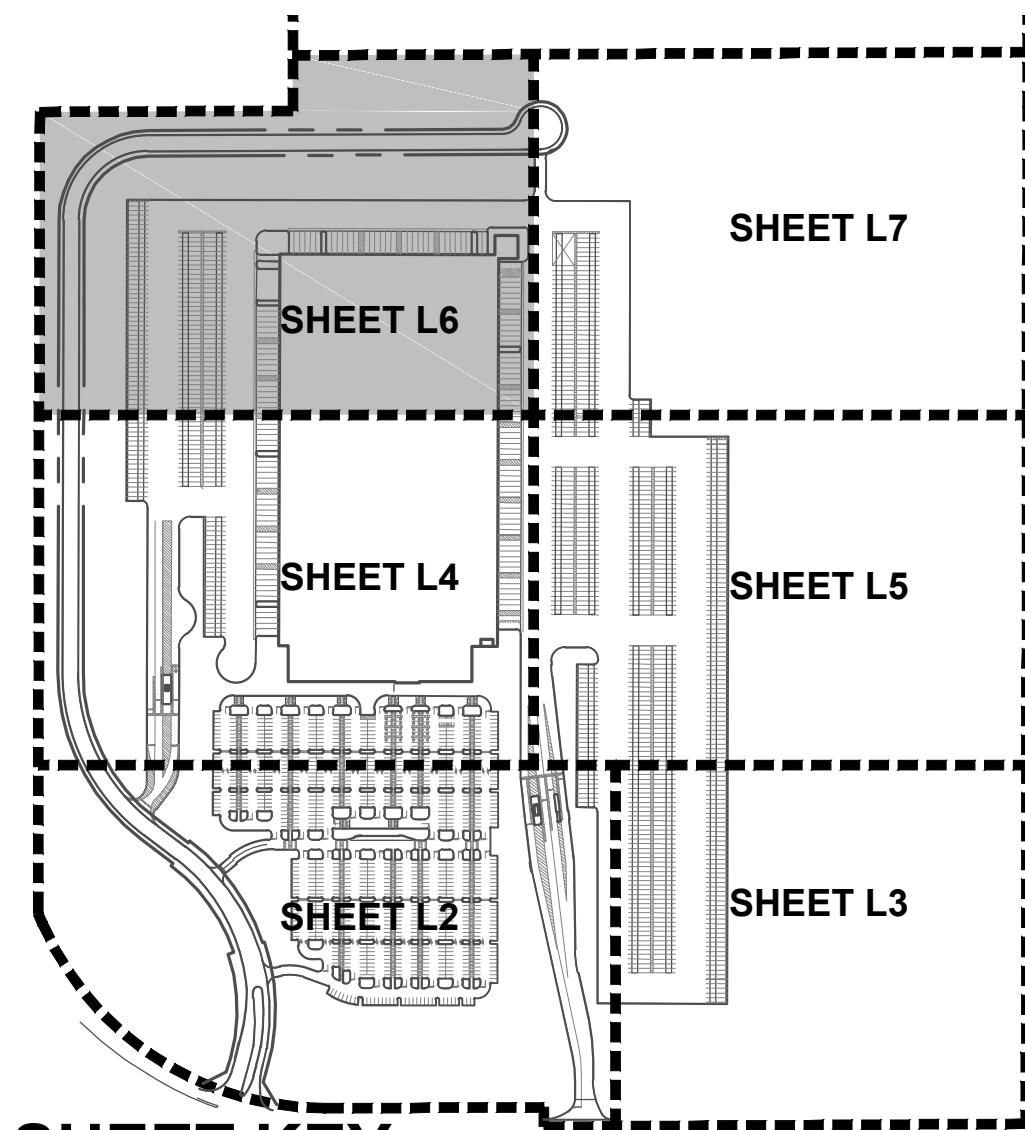

**SHEET KEY**  
SCALE: 1"=500'

**LEGEND**

Key	Description
	EMERGENT SEED
	EMERGENT SEED & PLUGS
	WET MEADOW SEED & BLANKET
	LOW PROFILE PRAIRIE SEED & BLANKET
	IRRIGATION (TO BE DESIGNER BY CONTRACTOR)
	NATURALIZED AREA SIGN (SEE QUANTITIES ON SHEET L1)

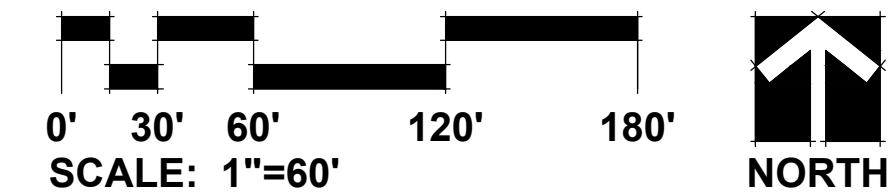



NOT CONTOUR SHEETS

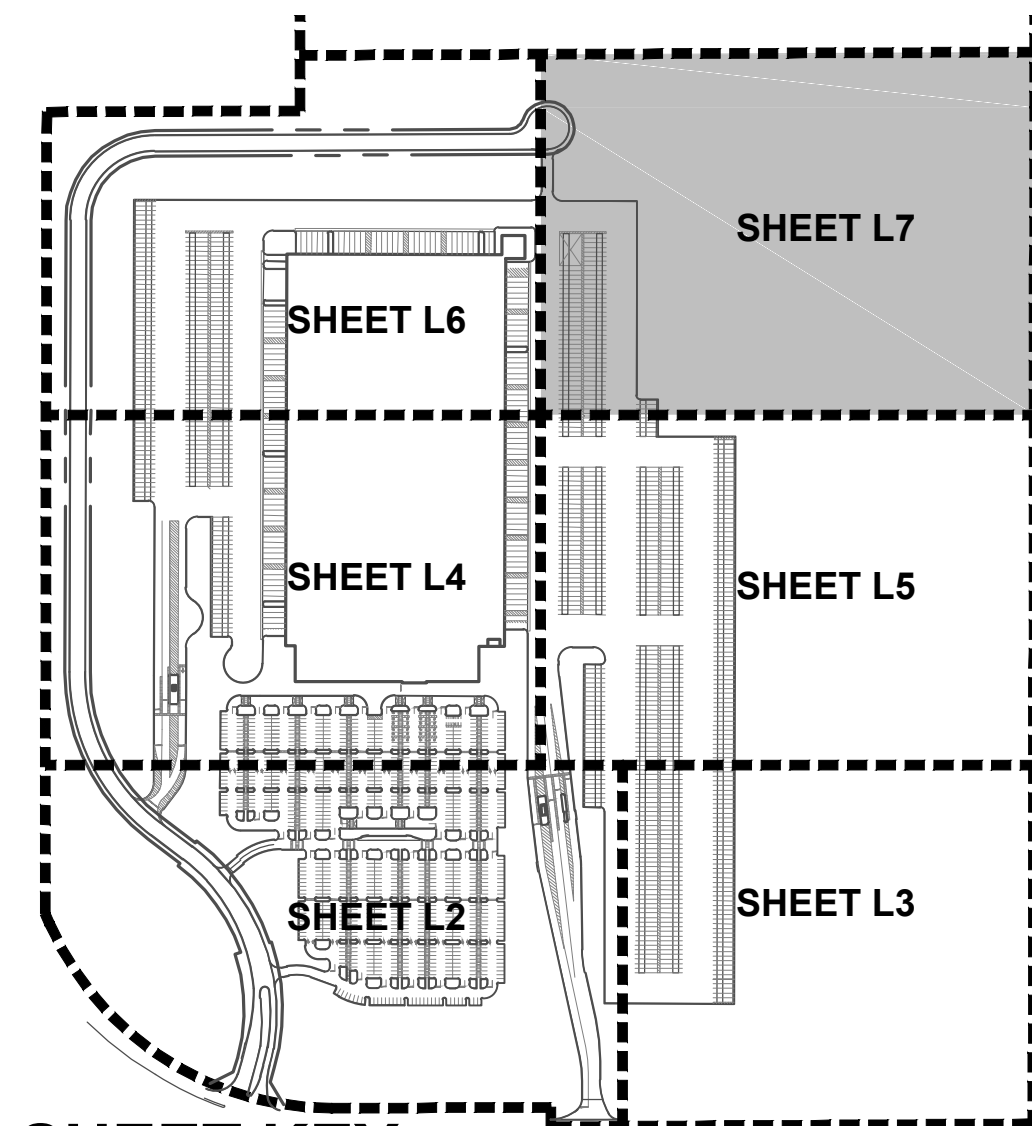

**SHEET KEY**  
SCALE: 1"=500'

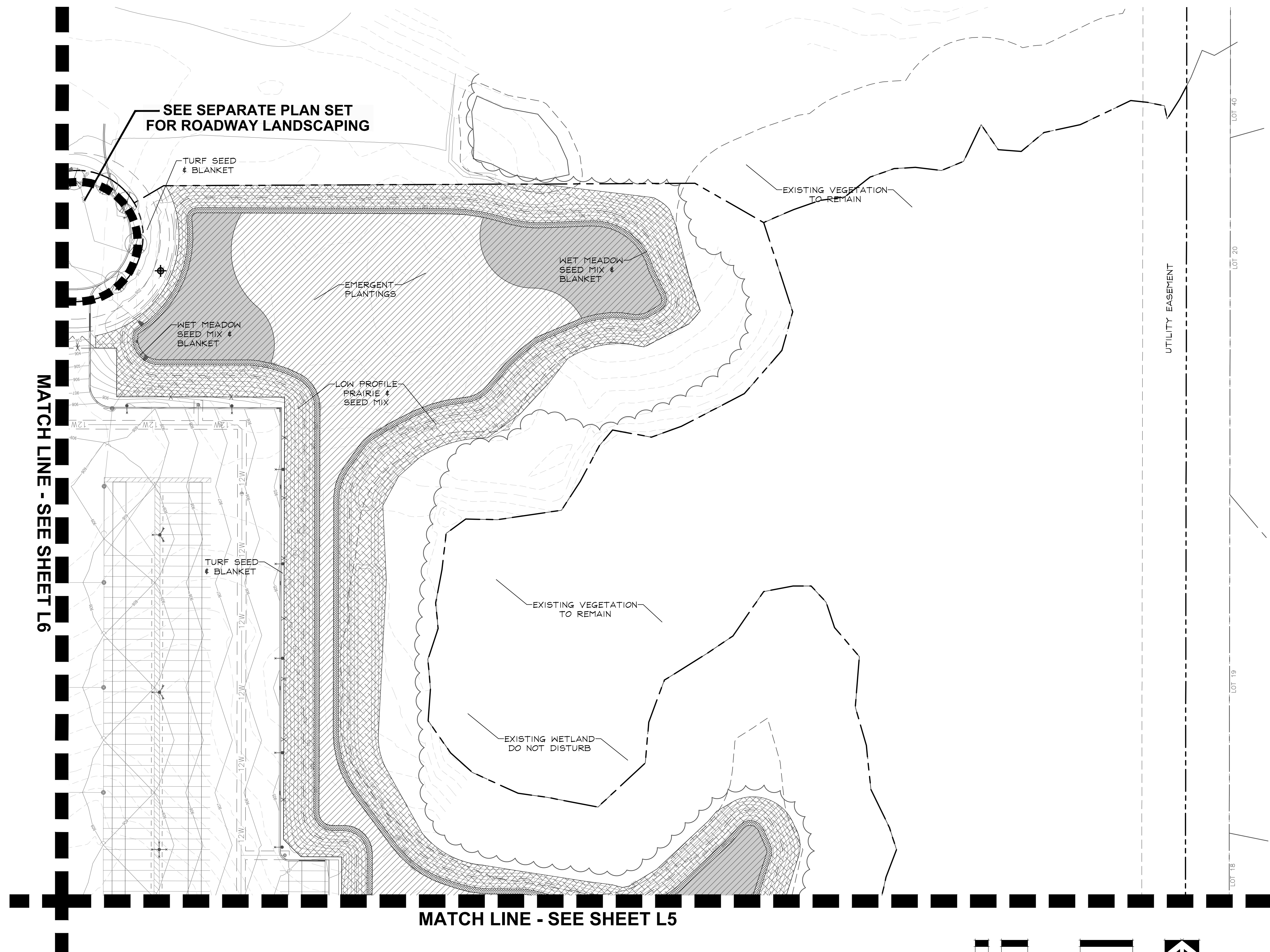

**LEGEND**

Key	Description
	EMERGENT SEED
	EMERGENT SEED & PLUGS
	WET MEADOW SEED & BLANKET
	LOW PROFILE PRAIRIE SEED & BLANKET
	IRRIGATION (TO BE DESIGNER BY CONTRACTOR)
	NATURALIZED AREA SIGN
(SEE QUANTITIES ON SHEET L1)	

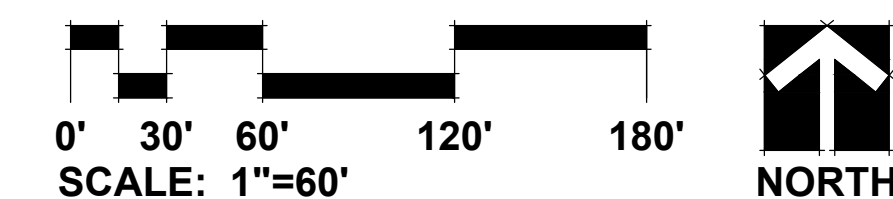

**GRWA**  
GARY R. WEBER  
ASSOCIATES, INC.  
LAND PLANNING  
ECOLOGICAL CONSULTING  
LANDSCAPE ARCHITECTURE  
402 WEST LIBERTY DRIVE  
WHEATON, ILLINOIS 60187  
PHONE: 630-668-7197

CIVIL ENGINEER  
**JACOB & HEFNER**  
ASSOCIATES, INC.  
1333 BUTTERFIELD ROAD, SUITE 300  
DOWNERS GROVE, ILLINOIS 60515

**PROJECT PUMPKIN**  
HUNTLEY, ILLINOIS  
**LANDSCAPE PLAN**

1	2.08.2021
REVISIONS	

DATE	1.11.2021
PROJECT NO.	JH2078
DRAWN	GFB
CHECKED	MGH
SHEET NO.	









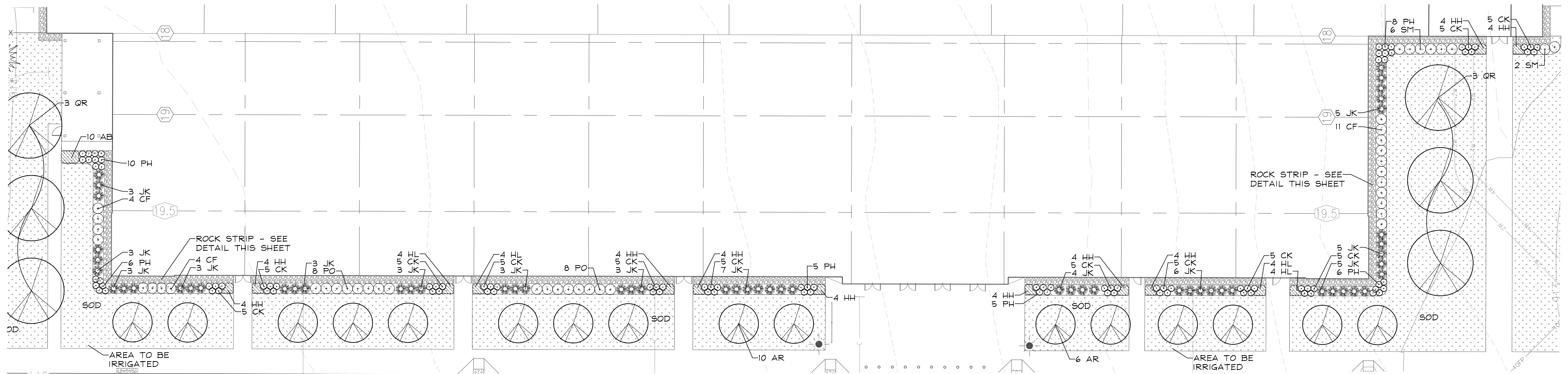

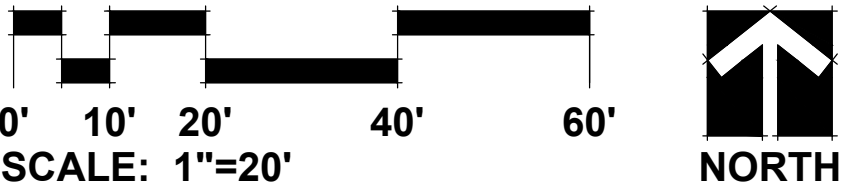

**JACOB & HEFNER  
ASSOCIATES, INC.**  
33 BUTTERFIELD ROAD, SUITE 300  
OWNERS GROVE, ILLINOIS 60515



# OFFICE FOUNDATION LANDSCAPE DETAIL



# LEGEND

Key	Description
	EMERGENT SEED
	EMERGENT SEED & PLUGS
	WET MEADOW SEED & BLANKET
	LOW PROFILE PRAIRIE SEED & BLANKET
	IRRIGATION (TO BE DESIGNED BY CONTRACTOR)
	NATURALIZED AREA SIGN

(SEE QUANTITIES ON SHEET LI)

## PLANTING DETAILS

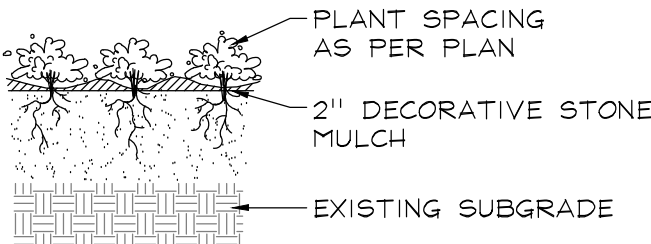

**PERENNIALS AND GROUNDCOVERS**  
NOT TO SCALE

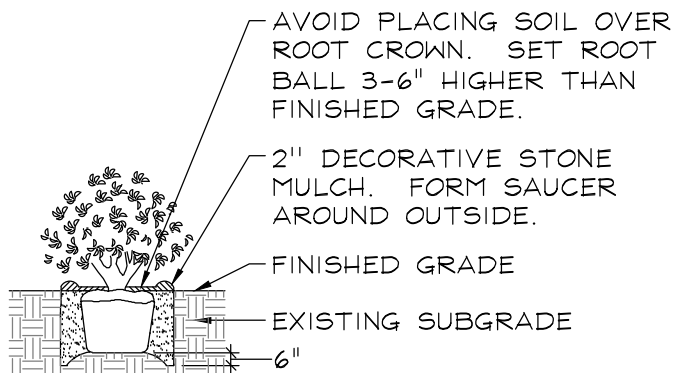

**DECIDUOUS AND EVERGREEN SHRUBS**  
NOT TO SCALE

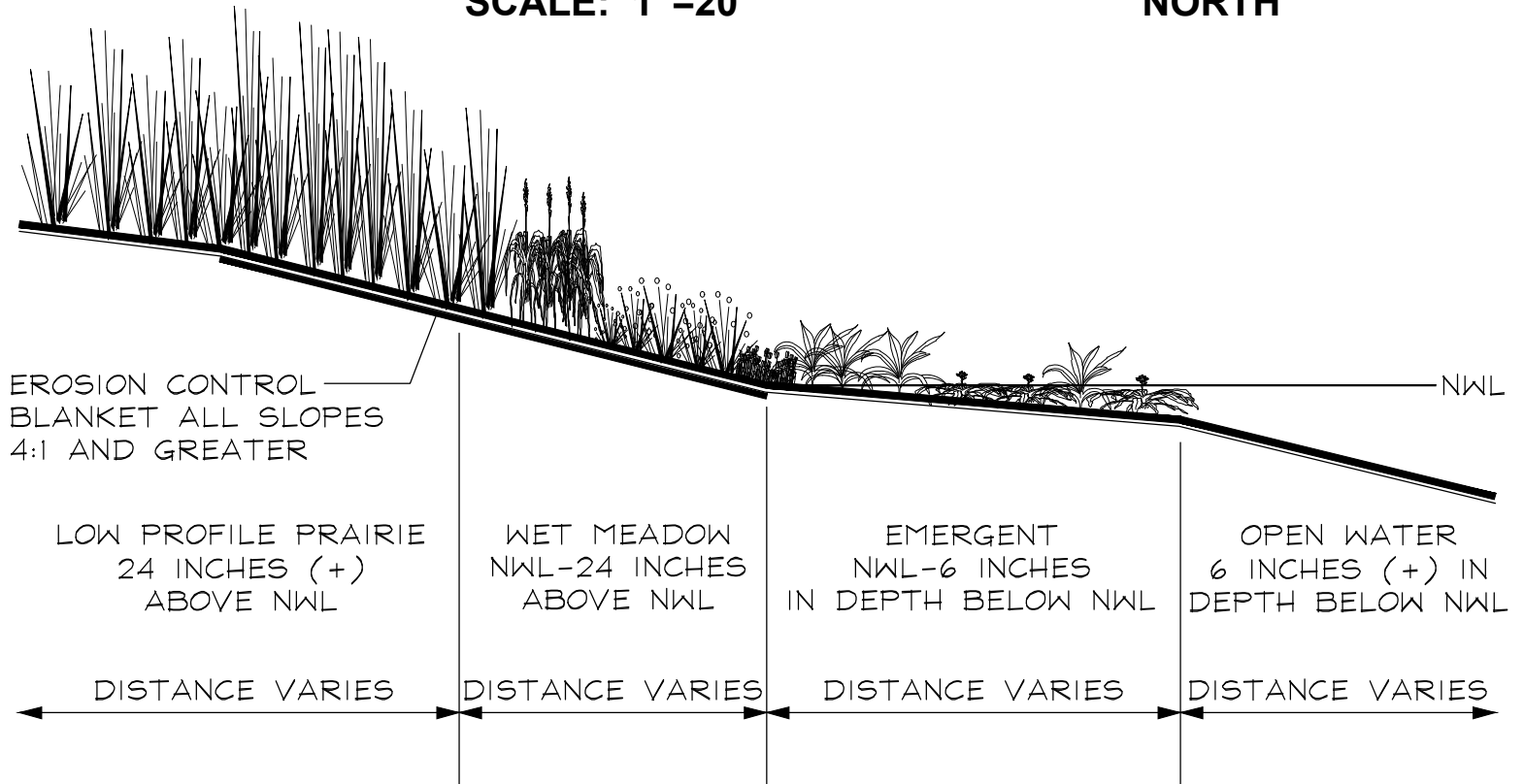

**PLANT COMMUNITY SECTION**  
NOT TO SCALE

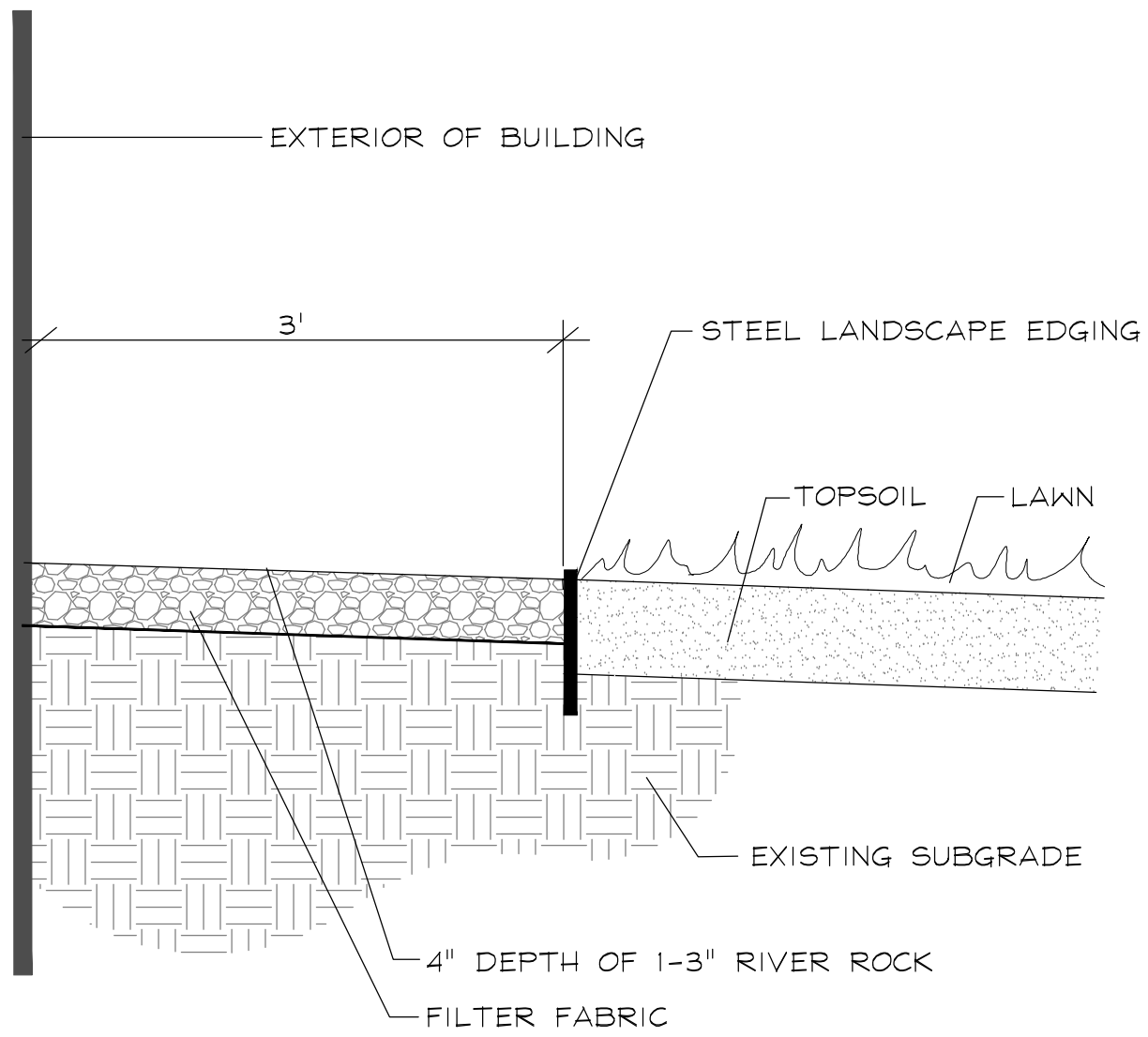

# STONE STRIP DETAIL

SCALE: N.T.S.

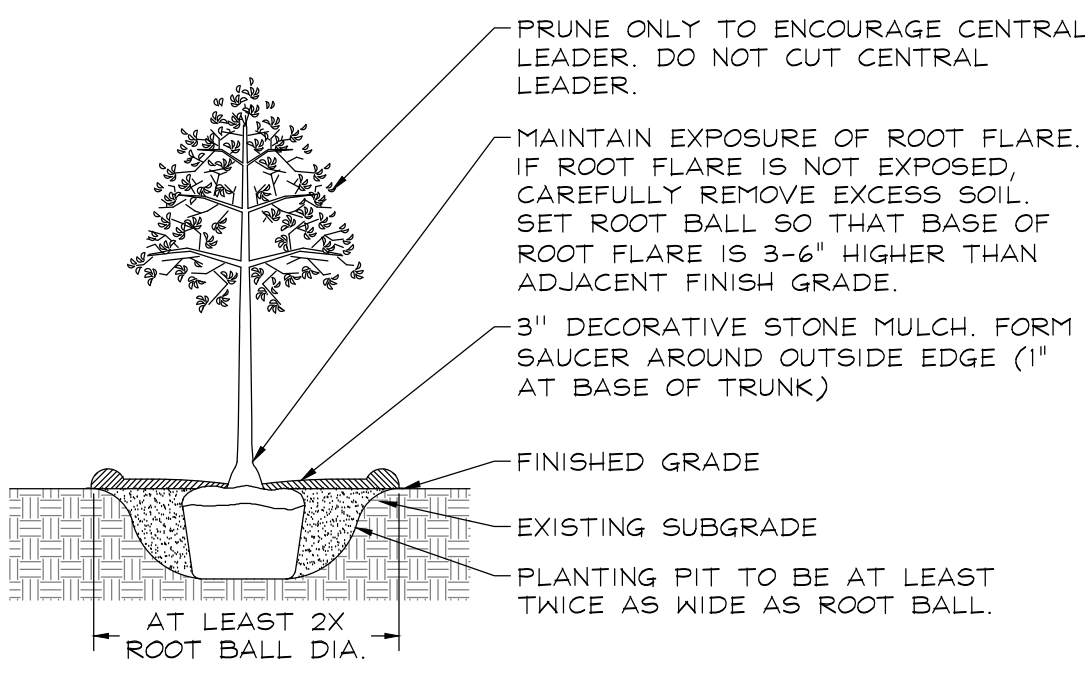

**DECIDUOUS TREES**  
NOT TO SCALE

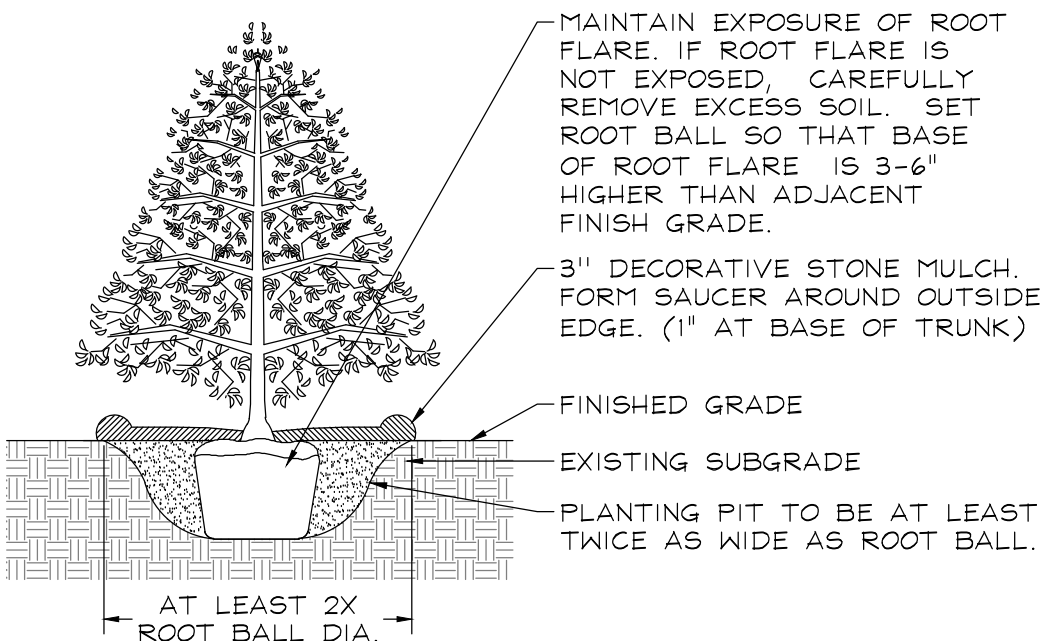

**EVERGREEN TREES**  
NOT TO SCALE

# PROJECT PUMPKIN

HUNTLEY, ILLINOIS

## LANDSCAPE DETAILS

2.08.2021	
EVISIONS	
DATE	1.11.2021
PROJECT NO.	JH2078
DRAWN	GFB
CHECKED	MGM
HEET NO.	



LANDSCAPE WORK PART 1 - GENERAL

1.1 DESCRIPTION OF WORK

The work shall consist of furnishing, transporting and installing all seeds, plants and other materials required for:

1. The establishment of trees, shrubs, perennial, annual and lawn areas as shown on Landscape Plan;
2. The provision of post-planting management as specified herein;
3. Any remedial operations necessary in conformance with the plans as specified in this document;
4. Permits which may be required.

1.2 QUALITY ASSURANCE

- A. Work shall conform to State of Illinois Horticultural Standards and local municipal requirements.
- B. Quality Control Procedures:

1. Ship landscape materials with certificates of inspection as required by governmental authorities. Comply with governing regulations applicable to landscape materials.
2. Do not make substitutions. If specified landscape material is not obtainable, submit to Landscape Architect proof of non-availability and proposal for use of equivalent material.
3. Analysis and Standards: Package standard products with manufacturer's certified analysis.

1.3 SUBMITTALS

A. Planting Schedule

Submit three (3) copies of the proposed planting schedule showing dates for each type of planting

B. Maintenance Instruction - Landscape Work

Submit two (2) copies of typewritten instructions recommending procedures to be established by the Owner for the maintenance of landscape work for one full year. Submit prior to expiration of required maintenance periods.

Instructions shall include: watering, fertilizing, spraying, mulching and pruning for plant material and trimming groundcover. Instructions for watering, fertilizing and mowing grass areas shall be provided ten (10) days prior to request for inspection for final acceptance. Landscape Architect shall receive copies of all instructions when issued.

C. Submit two (2) copies of soil test of existing topsoil with recommendations for soil additive requirement to Landscape Architect for review and written approval.

D. Submit two (2) samples of shredded hardwood bark mulch, erosion control blankets, and all other products and materials as specified on plans to Landscape Architect for review and written approval.

E. Nursery packing lists indicating the species and quantities of material installed must be provided to the Owner and/or City upon request.

1.4 JOB CONDITIONS

A. Examine and evaluate grades, soils and water levels. Observe the conditions under which work is to be performed and notify Landscape Architect of unsatisfactory conditions. Do not proceed with the work until unsatisfactory conditions have been corrected in an acceptable manner.

B. Utilities: Review underground utility location maps and plans; notify local utility location service; demonstrate an awareness of utility locations; and certify acceptance of liability for the protection of utilities during course of work. Contractor shall be responsible for any damage to utilities or property.

C. Excavation: When conditions detrimental to plant growth are encountered such as rubble fill, advise drainage conditions or obstructions, notify Landscape Architect before planting.

1.5 GUARANTEES

A. Guarantee seeded and sodded areas through the specified maintenance period and until final acceptance.

B. Guarantee trees, shrubs, groundcover and perennials for a period of one year after date of acceptance against defects including death and unsatisfactory growth, except for defects resulting from neglect by Owner, abuse or damage by others or unusual phenomena or incidents which are beyond Landscape Installer's control.

C. Native Planting Area Performance Criteria

1st Full Growing Season: 90% of cover crop shall be established. There shall be no bare areas greater than two (2) square feet in seeded areas. At least 25% of vegetation coverage shall be native, non-invasive species. At least 50% of the emergent species, if planted as plugs shall be alive and apparent.

2nd Full Growing Season: All areas with the exception of emergent zones shall exhibit full vegetative cover. At least 50% of the vegetation coverage shall be native, non-invasive species.

3rd Full Growing Season: At least 75% of vegetation coverage shall be native, non-invasive species. Non-native species shall constitute no more than 25% relative aerial coverage of the planted area. Non-native/ Invasive species for this project shall include but are not limited to the following: Ambrosia artemisiifolia & trifida (Common & Giant Ragweed), Cirsium arvense (Canada Thistle), Euphorbia corollata (Cult-leaved Spurge), Euphorbia corollata (Common Teasel), Euphorbia corollata (Purple Loosestrife), Melilotus sp. (Sweet Clover), Phalaris arundinacea (Reed Canary Grass), Phragmites australis (Giant Reed), Polygonum cuspidatum (Fallopia japonica) (Japanese Knotweed), Rhamnus cathartica & frangula (Common & Glossy Buckthorn), Typha sp. (Broadleaf, Narrowleaf, and Hybrid Cattail).

LANDSCAPE WORK PART 2 - PLANT MATERIALS

2.1 LAWN SOD

Provide strongly rooted sod, not less than two (2) years old and free of weeds and undesirable native grasses. Provide only sod capable of growth and development when planted (viable, not dormant) and in strips not more than 18" wide x 4' long. Provide sod composed of a 5-way blend of Kentucky Bluegrass such as: Midnight, Allure, Viva, Washington, Liberty.

2.2 LAWN SEED MIXTURE

Grass Seed: Provide fresh, clean, new crop seed complying with the tolerance for purity and germination established by the Official Seed Analysts of North America. Provide seed of the grass species, proportions and maximum percentage of weed seed, as specified.

- A. Lawn Seed Mixture - 5 lbs./1,000 sq. ft.  
50% Kentucky Bluegrass 98/85  
15% Custer Perennial Ryegrass  
10% Spartan Hard Fescue  
10% Edge Perennial Ryegrass  
10% Express Perennial Ryegrass  
5% Pennlawn Creeping Red Fescue
- B. Temporary Lawn Seed Mixture - 5 lbs./1,000 sq.ft.  
40% Kentucky Bluegrass 98/85  
40% Perennial Ryegrass  
20% Annual Ryegrass

2.3 NATIVE PLANTING MIXTURES

Provide fresh, clean, new crop of the species and proportions as specified. Native seed and live plant material shall be obtained from a reputable supplier (approved by Landscape Architect) that has collected from sources east of the Mississippi River within the same EPA Level III Ecoregion as the project site (Central Corn Belt Plains). Any material sourced from outside this ecoregion must be approved by the Landscape Architect prior to installation.

It is the sole responsibility of the Native Landscape Contractor to provide approved seed that meets industry-standard PLS requirements.

2.4 GROUNDCOVERS, PERENNIALS AND ANNUALS

Provide plants established and well-rooted in removable containers or integral pot pots and with not less than the minimum number and length of runners required by ANSI Z60.1 for the pot size shown or listed.

2.5 TREES AND SHRUBS

A. Name and Variety: Provide nursery grown plant material true to name and variety.

B. Quality: Provide trees, shrubs and other plants complying with the recommendations and requirements of ANSI Z60.1 "Standard for Nursery Stock" and as further specified.

C. Deciduous Trees: Provide trees of height and caliper listed or shown and with branching configuration recommended by ANSI Z60.1 for type and species required. Provide single stem trees except where special forms are shown or listed. Provide balled and burlapped (B&B) deciduous trees.

D. Deciduous Shrubs: Provide shrubs of the height shown or listed and with not less than the minimum number of canes required by ANSI Z60.1 for the type and height of shrub required. Provide balled and burlapped (B&B) deciduous shrubs.

E. Coniferous Evergreen: Provide evergreens of the sizes shown or listed. Dimensions indicate minimum spread for spreading and semi-spreading type evergreens and height for other types. Provide quality evergreens with well-balanced form complying with requirements for other size relationships to the primary dimension shown. Provide balled and burlapped (B&B) evergreen trees and containerized shrubs.

F. Inspection: All plants shall be subject to inspection and review at the place of growth or upon delivery and conformity to specification requirements as to quality, right of inspection and rejection upon delivery at the site or during the progress of the work for size and condition of balls or roots, diseases, insects and latent defects or injuries. Rejected plants shall be removed immediately from the site.

2.6 PLANTING SOIL MIXTURE

Provide planting soil mixture consisting of clean uncompacted topsoil (stockpiled at site) for all planting pits, perennial, annual and groundcover areas. Topsoil shall be conditioned based on any recommendations resulting from the soil test in 1.3.C.

2.7 EROSION CONTROL

A. Lawn Seed Areas Erosion Control Blanket: North American Green D575, or equivalent approved equal.

B. Native Areas Erosion Control Blanket: North American Green S150, or equivalent approved equal.

C. Shoreline and Sloped Berm Areas Erosion Control Blanket: North American Green SC150, or approved equal. To be installed per manufacturer's recommendations.

2.8 DECORATIVE STONE MULCH

Provide decorative stone mulch consisting of 1 1/2" clean river rock. Provide sample to Landscape Architect for approval prior to ordering materials.

LANDSCAPE WORK PART 3 - EXECUTION

3.1 PLANTING SCHEDULE

At least thirty (30) days prior to the beginning of work in each area, submit a planting schedule for approval by the Landscape Architect.

3.2 PLANTINGS

A. Sodding New Lawns

1. Remove existing grass, vegetation and turf. Dispose of such material legally off-site, do not turn over into soil being prepared for lawns.
2. Till to a depth of not less than 6"; apply soil amendments as needed; remove high areas and fill in depressions; till soil to a homogenous mixture of fine texture, remove lumps, clods, stones over 1" diameter, roots and other extraneous matter. Dispose of such material legally off-site.
3. Sodded areas shall receive an application of commercial fertilizer at the rate of 10 lbs. per 1,000 sq. ft. and shall have an analysis of 16-8-8.
4. Lay sod within 24 hours from time of stripping.
5. Lay sod to form a solid mass with tightly fitted joints. Butt ends and sides of sod strips; do not overlap. Stagger strips to offset joints in adjacent courses. Work from boards to avoid damage to subgrade or sod. Tamp or roll lightly to ensure contact with subgrade. Work sifted soil into minor cracks between pieces of sod; remove excess to avoid smothering of adjacent grass.
6. Water sod thoroughly with a fine spray immediately after planting.

B. Seeding New Lawns

1. Remove existing grass, vegetation and turf. Dispose of such material legally off-site. Do not turn over into soil being prepared for lawns.
2. Till to a depth of not less than 6"; apply soil amendments; remove high areas and fill in depressions; till soil to a homogenous mixture of fine texture, remove lumps, clods, stones over 1" diameter, roots and other extraneous matter. Dispose of such material legally off-site.
3. Seeded lawn areas shall receive an application of commercial fertilizer at the rate of 5 lbs. per 1,000 sq. ft. and shall be 6-24-24. Fertilizer shall be uniformly spread and mixed into the soil to a depth of 1" inches.
4. Do not use wet seed or seed which is moldy or otherwise damaged in transit or storage.
5. Sow seed using a spreader or seeding machine. Do not seed when wind velocity exceeds five (5) miles per hour. Distribute seed evenly over entire area by sowing equal quantity in two directions at right angles to each other.
6. Sow not less than specified rate.
7. Rake lawn seed lightly into top 1" of soil, roll lightly and water with a fine spray.
8. After the seeding operation is completed, spray a wood fiber mulch (Comweb 2000 with tacifier or approved equal) over the entire grassed area at the rate of 2,000 lbs. per acre. Use a mechanical spray unit to insure uniform coverage. Exercise care to protect buildings, automobiles and people during the application of the mulch.

C. Seeding Native Areas

1. The period for planting prairie seed shall be from April 1 to June 15 or September 15 to just before the first frost. Seeding outside of these timeframes must be approved by the landscape architect.
2. The General Contractor and Native Landscape Contractor shall be responsible for performing all work necessary to achieve and maintain an acceptable seedbed prior to seeding. All areas must be properly prepared before seeding begins. Equipment having low unit pressure ground contact shall be utilized within the planting areas.
3. If present, compacted soils shall be disked or raked prior to seeding. Remedial measures for the access area may, at the direction of the Wetland Consultant, involve ripping from 12 to 18 inches of the soil horizon prior to disking.
4. Prior to seeding, planting areas shall have at least twelve inches of clean un-compacted topsoil. Clumps, clods, stones over 2" diameter, roots and other extraneous matter shall be removed and disposed of legally off-site.
5. Granular mycorrhizal inoculants shall be installed with the seed mix at a rate of 40lbs/ acre. Inoculant can be banded under seed, worked into seed or added into spray tanks. Native areas shall not receive fertilizer.
6. Contractor shall be solely responsible for the proper handling and storage of the seed according to the best seed handling and storage practices, including fungicide treatments and stratification considerations. Owner shall make no compensation for damage to the seed because of improper storage, cleaning, threshing, or screening operations.
7. Except where site conditions preclude their use, seeding shall be performed using a Truax drill, Truax Trillion seeder, or comparable equipment designed specifically for installation of native seed. For areas where site conditions preclude the use of specialized equipment, seed may be installed through hand broadcasting and followed by light raking. Hand broadcast seed shall be spread at twice the specified rate. Other methods of seed installation may be used with prior approval from the Landscape Architect.
8. Prior to starting work, all seeding equipment shall be calibrated and adjusted to sow seeds at the proper seeding rate. In general, the optimum seeding depth is 0.25 inch below the soil surface. Areas where the seed has not been incorporated into the soil to the proper depths will not be accepted, and no compensation for materials or labor for the rejected work will be made by the Owner.
9. Seeding and soil tracking/firming shall not be done during periods of rain, severe drought, high winds, excessive moisture, frozen ground, or other conditions that preclude satisfactory results.
10. Wet mesic and emergent areas shall be planted, and seed allowed to germinate (if possible), prior to flooding with significant amounts of water. Any areas of significant permanent water located within the planting area will receive live plugs in lieu of seed.
11. After the seeding operation is completed, install erosion control blanket per manufacturer's specifications.
12. Emergent plugs shall be planted in natural groupings within designed areas containing saturated soils or shallow inundation. Plants within groupings shall be planted at 2 foot centers.
13. Emergent plugs shall not be planted less than the specified rate and shall be protected with goose enclosures surrounding all natural groupings of plugs.

E. Groundcover and Perennial Beds

Groundcover, perennials, and annuals shall be planted in continuous beds of planting soil mixture a minimum of 8" deep. Install per spacing indicated on plan.

F. Trees and Shrubs

1. Set balled and burlapped (B&B) stock plumb and in center of pit or trench with top of ball at an elevation that will keep the root flare exposed upon backfill and mulching. Remove burlap from top and sides of balls; retain on bottoms. When set, place additional topsoil backfill around base and sides of ball and work each layer to settle backfill and eliminate voids and air pockets. When excavation is approximately 2/3 full, water thoroughly before placing remainder of backfill. Repeat watering until no more is absorbed. Water again after placing final layer of backfill.
2. Dish top of backfill to allow for mulching. Provide additional backfill berm around edge of excavations to form shallow saucer to collect water.
3. Mulch pits, trenches and planted areas. Provide not less than 2" thickness of mulch and work into top of backfill and finish level with adjacent finish grades. Maintain exposed root flare at all times.
4. Prune only injured or dead branches from flowering trees, if any. Protect central leader of tree during shipping and pruning operations. Prune shrubs to retain natural character in accordance with standard horticultural practices.
5. Remove and replace excessively pruned or ill-formed stock resulting from improper pruning.
6. The Contractor shall be wholly responsible for assuring that all trees are planted in a vertical and plumb position and remain so throughout the life of this contract and guarantee period. Trees may or may not be staked and guyed depending upon the individual preference of the Contractor; however, any bracing procedure(s) must be approved by the Owner prior to its installation.

3.3 INITIAL MAINTENANCE

- A. Begin maintenance immediately after planting, continuing until final acceptance. A minimum of thirty (30) days.
- B. Maintain planted and seeded areas by watering, rolling/regrading, replanting and implementing erosion control as required to establish vegetation free of eroded or bare areas.
- C. Compensatory Storage and Native Planting areas are to be mowed only once per spring during the initial three year establishment period.

3.4 NATIVE LANDSCAPED AREAS CONTINUED MONITORING & MAINTENANCE

A. Monitoring

The Owner shall notify the County upon completion of plantings. The Owner's Environmental Specialist shall inspect the plantings and provide the County with a copy of the planting locations, species, and quantities for verification by the County.

The Owner's Environmental Specialist shall inspect the plantings at least twice per year during the three-year term of the Establishment and Maintenance Cash Bond or Letter of Credit, to determine compliance with the minimum annual performance criteria (See 1.5C Guarantees). A monitoring report will be provided to the County by January 31st following each growing season.

B. Maintenance:

First Season

With the exception of the emergent area, native seeding areas should be mowed to a height of 6" to control annual nonnative and invasive species early in the growing season. Mowing, including weed whipping, should be conducted during prior to weed seed production. Mowing height and timing may need to be adjusted per target species. Small quantities of undesirable plant species, shall be controlled by hand pulling prior to the development and maturity of the plant. Hand removal shall include the removal of all above-ground and below-ground stems, roots and flower masses prior to development of seeds. Herbicide should be applied as necessary by a trained and licensed operator that is competent in the identification of native and nonnative herbaceous plants. Debris shall be removed from the native areas and storm structures shall be inspected and maintained as necessary.

Second Season

Control of undesirable plant species during the second growing season shall consist primarily of pre-emptive herbicide application. Mowing and weed whipping shall be conducted as needed during the early growing season and as needed to a height of 6 to 8 inches to prevent annual weeds from producing seed. Debris and litter shall be removed from the native areas and storm structures shall be inspected and maintained as necessary.

Third Season

Seasonal mowing and herbicide will continue as above but should be reduced over time. Debris and litter shall be removed from the native areas and storm structures shall be inspected and maintained as necessary. At the completion of the third growing season (dependent on fuel availability; dominance of graminoid species; and favorable weather conditions), fire may be introduced to the planted areas as the primary management tool.

State and local permits shall be required prior to controlled burning. Burning shall be conducted by trained professionals experienced in managing smoke in urban environments. Prior to a controlled burn, surrounding property owners as well as local fire and police departments shall be notified. A burn plan detailing preferred wind direction and speed, location of fire breaks, and necessary personnel and equipment shall be prepared and utilized in planning and burn implementation.

The initial burn shall be dependant on fuel availability which is directly related to the quantity and quality of grasses contained within the plant matrix. Timing of the burn shall be determined based on results of the annual monitoring indicating species composition of the management area and other analysis of management goals. Generally, burns shall be scheduled from spring to fall on a rotational basis. Burn frequency shall also be dependant on the species composition within the management area. Generally, a new prairie restoration area shall be burned annually for two years after the second or third growing season after planting and then every 2-3 years thereafter, burning 50-75% of the area.

C. Long Term Wetland and Prairie Management/Maintenance

A final compliance report and Long-Term Operation and Maintenance Plan shall be submitted by the Developer/Owner's Environmental Specialist no less than 60 days prior to the expiration of any landscape Cash Bond or Letter of Credit posted for the native areas. Final acceptance and release shall be determined by the County or Municipality upon inspection of the site to verify compliance.

The Long -Term Operation and Maintenance Plan shall be written to include guidelines and schedules for burning, mowing, application of herbicide, debris/litter removal and inspection schedule for storm structures and sediment removal.

3.5 CLEAN UP AND PROTECTION

- A. During landscape work, store materials and equipment where directed. Keep pavements clean and work areas and adjoining areas in an orderly condition.
- B. Protect landscape work and materials from damage due to landscape operations, operations by other trades and trespassers. Maintain protection during installation and maintenance periods. Treat, repair or replace damaged landscape work as directed by Landscape Architect.

3.6 INSPECTION AND ACCEPTANCE

- A. The Landscape Architect reserves the right to inspect seeds, plants, trees and shrubs either at place of growth or at site before planting for compliance with requirements for name, variety, size, quantity, quality and mix proportion.
- B. Supply written affidavit certifying composition of seed mixtures and integrity of plant materials with respect to species, variety and source.
- C. Notify the Landscape Architect within five (5) days after completing initial and/or supplemental plantings in each area.
- D. When the landscape work is completed, including maintenance, the Landscape Architect will, upon request, make a final inspection to determine acceptability. After final acceptance, the Owner will be responsible for maintenance.



GARY R. WEBER  
ASSOCIATES, INC.  
LAND PLANNING  
ECOLOGICAL CONSULTING  
LANDSCAPE ARCHITECTURE  
402 WEST LIBERTY DRIVE  
WHEATON, ILLINOIS 60187  
PHONE: 630-668-7197

ENVIRONMENTAL ENGINEER  
JACOB & HEFNER  
ASSOCIATES, INC.  
1333 BUTTERFIELD ROAD, SUITE 300  
DOWNERS GROVE, ILLINOIS 60515

PROJECT PUMPKIN  
HUNTLEY, ILLINOIS  
LANDSCAPE SPECIFICATIONS

1	2.08.2021
REVISIONS	

DATE	1.11.2021
PROJECT NO.	JH2078
DRAWN	GFB
CHECKED	MGM
SHEET NO.	

