



OPTIV
PROPERTIES

BOULEVARD
at
Central Station

**NOW
LEASING**

COMMERCIAL SPACE

BOULEVARD AT CENTRAL STATION

6725 SOUTH ST

TINLEY PARK IL 60477



- \$15 PSF + CAM + Tax (NNN Leases)
- 1,477-6,199 SQFT sized units available
- Potential incentives for qualifying businesses



Get in at ground level with Tinley Park's newest prime development directly across from the train station and planted in the heart of the village's downtown district!



Multiple suites are available in various sizes. Immense exposure with hundreds of luxury residential units neighboring directly above, flowing foot traffic from the train station, Harmony Square, and Oak Park's main drag of local businesses and entertainment.





Tinley Park Train Station

Oak Park Avenue

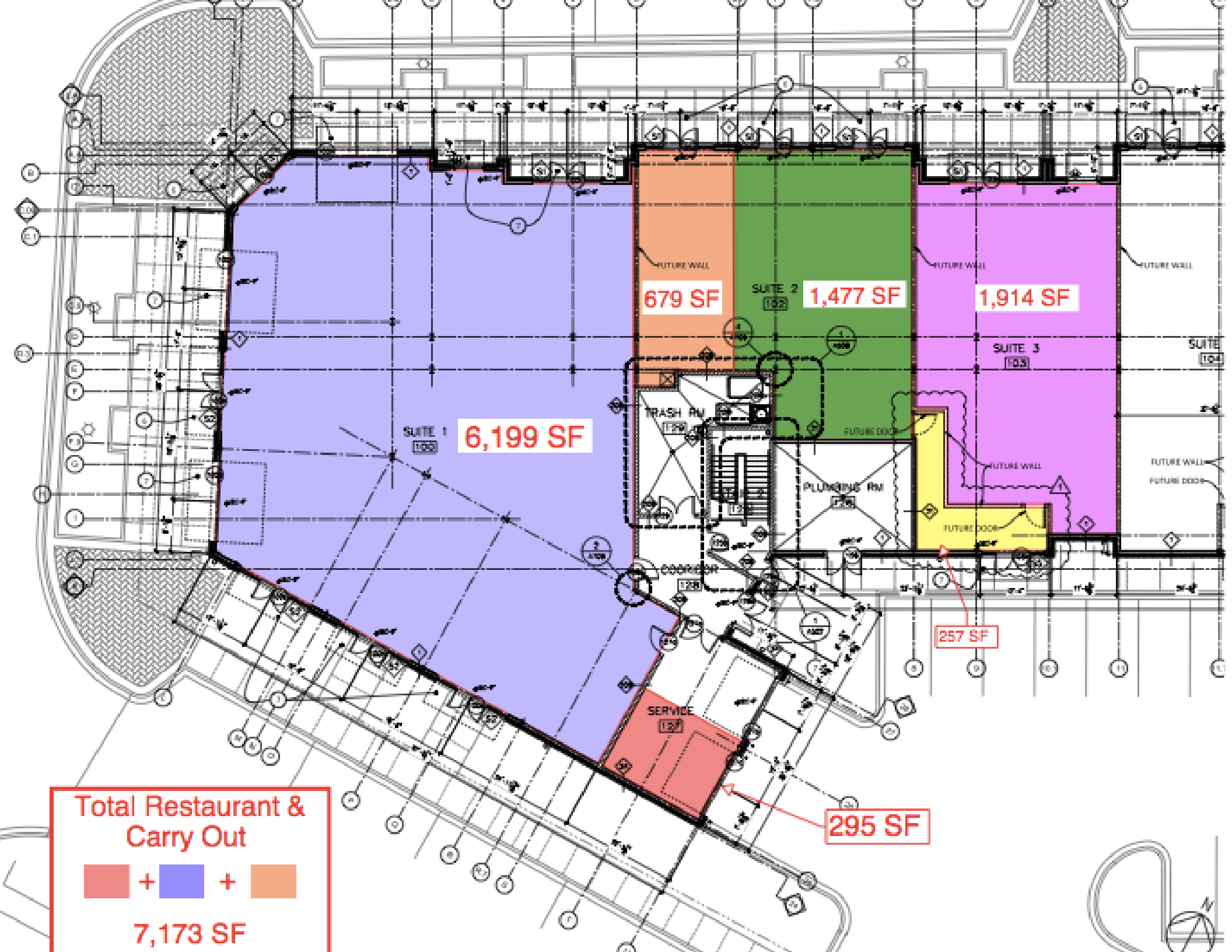

679 SF

SUITE 2
1,477 SF

1,914 SF

SUITE 1
6,199 SF

TRASH RM
128

PLUMBING RM
176

257 SF

SERVICE
295

295 SF

Total Restaurant &
Carry Out



7,173 SF

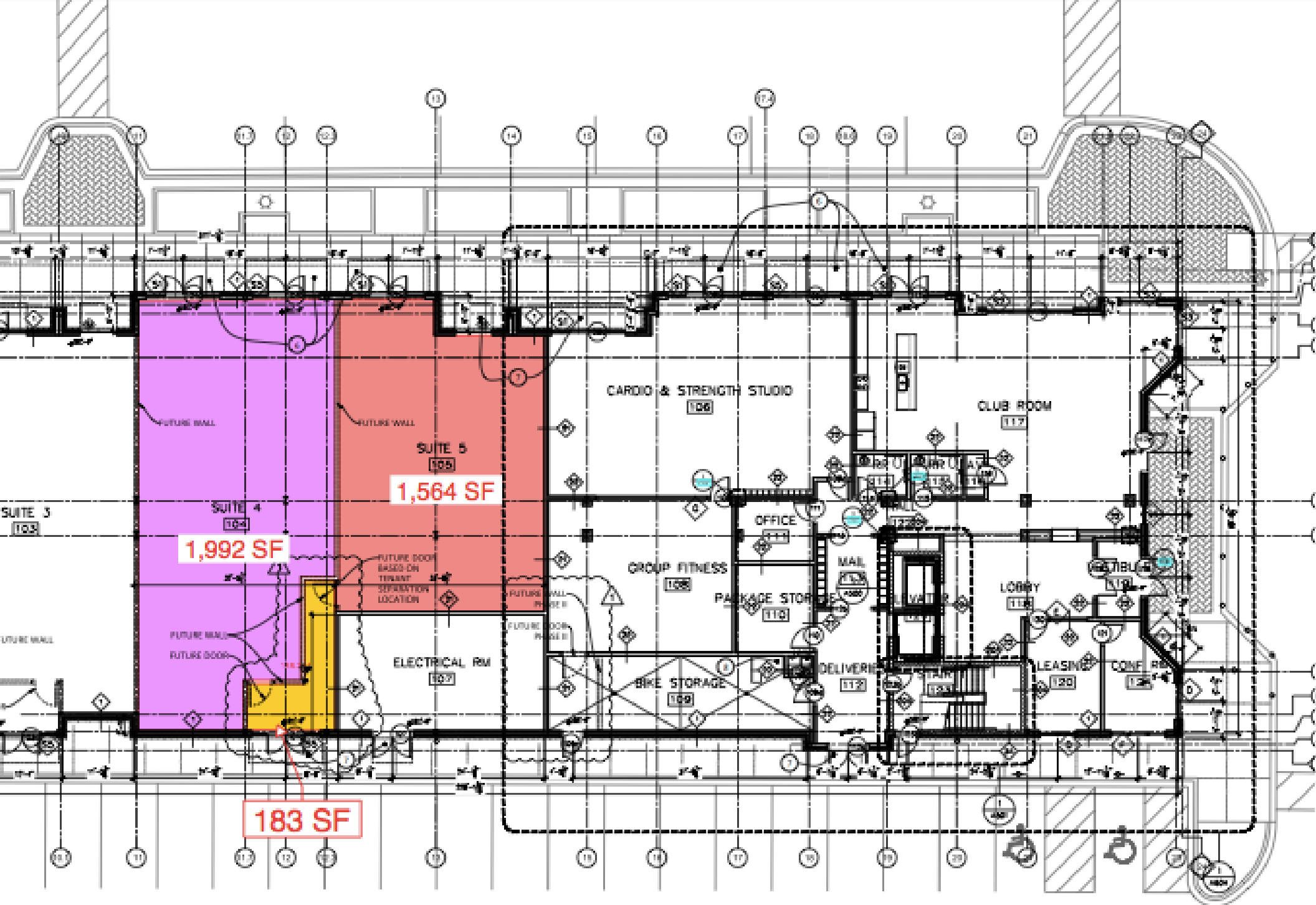



OPTIV
PROPERTIES

CONTACT

BOULEVARD
at Central Station

OPTIV PROPERTIES
PO BOX 70, PALOS PARK IL
60464

(708) 846-0199
OPTIVPROPERTIES.COM

PAIGE HANSEN
MANAGING BROKER
PAIGE@OPTIVPROPERTIES.COM

