



Village of Tinley Park - Building Department
Dumpster Enclosure Requirements

16250 S. Oak Park Avenue
Tinley Park, Illinois 60477
(708) 444-5100 Fax (708) 444-5199
www.tinleypark.org

The following information must be filled-out on the application in order to approve the permit.

- Date of Application
- Name of Owner of Property and Phone Number
- Project Address
- Description of Project
- Cost of Project
- All contractor's hired on the project: Name, Address, and Phone Number
- Copy of written contract from ALL contractors hired to work on the project
- Sign and Date Permit Application

PLAT OF SURVEY

A Plat of Survey of the property must accompany the permit application. This will not be returned to the property owner; however, our office would be happy to make a copy. Please contact your waste hauler for enclosure dimensions required for the size of dumpsters on your lot. Draw the dumpster enclosure on the plat in its exact location. Please draw the distance from the dumpster to the side and rear lot lines on the survey

FEE

The fee for a dumpster enclosure permit is \$50.00. Payment is not required until the permit is picked-up at the Clerk's Office.

PERMIT ISSUANCE

Permits take approximately **SEVEN TO TEN BUSINESS DAYS** to process. The Building Department will notify the property owner by telephone when the permit is ready. **All permits are to be picked-up at the Village Clerk's Office located in the Village Hall, NOT the Building Department.**

PERMIT EXPIRATION

The life of a permit is six (6) months from the date of issue. A permit may be extended past the six (6) months by submitting a written request for extension, to be approved by the Building Commissioner. If work has not started within three (3) months of the date of issue, the permit will be void unless a written request is submitted for extension, and approved by the Building Commissioner.

CONTRACTORS

All contractors doing work in the Village of Tinley Park must be licensed and bonded with the Village prior to starting work. Permits will not be issued unless all contractors noted on the permit are licensed and bonded. At any time during the permit approval process or during construction after permit is approved and issued a decision is made to change any contractor listed on the application, a Change of Contractor form must be completed and submitted to the Building Department. Verification of the new contractor's license and bond status as current must be confirmed by the Village before work on the project can resume.

PROPERTY OWNER

The owner of the property where work is to be performed is responsible for filling out the permit application and obtaining the permit before any construction is performed. Property owners may give permission for a contractor or any other party to apply for the permit and obtain it, but is still responsible.

J.U.L.I.E.

Please call the Joint Utility Locating Information for Excavators (J.U.L.I.E.) at least 48 hours prior to any digging. Please call 1-800-892-0123.

RESTRICTIONS

1. **Where Required:** Trash and recycling enclosures shall be provided at all new buildings and uses including single family attached and detached dwelling units (if the owner chooses to have a dumpster instead of garbage cans). The enclosed area shall be screened on three (3) sides by a wall from view from public streets and any abutting properties and have a gate made of wood or vinyl fencing material (no chain link fencing can be used). There shall not be any types of enclosures or container in the front yards or any building or use including single family attached and detached units.
2. **Construction Materials:** Any wall around a dumpster or trash handling area shall be constructed in a durable fashion of brick, stone or other masonry materials with a gate opening which will accommodate the pickup of the dumpsters by the scavenger service.
3. **Enclosure Height:** Any enclosure constructed shall have a height not greater or less than 6 feet.
4. **Foundation:** Any enclosure constructed shall have a concrete foundation capable of supporting the walls and any other live and dead loads anticipated.
5. **Size of Trash Enclosure:** The area of a trash enclosure for a site or business shall be sized using dimensions, which relate to the size and use of the principal building and as approved by the building official.
6. **Existing Buildings:** Existing buildings and properties prior to October 2002, shall conform to **Chapter VIII, IPMC Section 307.5 Dumpster Enclosures.**

If you have any questions, please contact the Building Department at (708) 444-5100.

DUMPSTER RESTRICTIONS:

- A. Where required: Trash and recycling enclosures shall be provided at all new buildings and uses including single family attached and detached dwelling units (if the owner chooses to have a dumpster instead of garbage cans). The enclosed area shall be screened on three (3) sides by a wall from view from public streets and any abutting properties and have a gate made of wood or vinyl fencing material (no chain link fencing can be used). There shall not be any types of enclosures or container in the front yards or any building or use including single family attached and detached units.
- B. Construction Materials: Any wall around a dumpster or trash handling area shall be constructed in a durable fashion of brick, stone or other masonry materials with a gate opening which will accommodate the pickup of the dumpsters by the scavenger service.
- C. Enclosure Height: Any enclosure constructed shall have a height not greater or less than 6 feet.
- D. Foundation: Any enclosure constructed shall have a concrete foundation capable of supporting the walls and any other live and dead loads anticipated.
- E. Size of Trash Enclosure: The area of a trash enclosure for a site or business shall be sized using dimensions, which relate to the size and use of the principal building and as approved by the building official.
- F. Existing Buildings: Existing buildings and properties prior to October 2002, shall conform to **Chapter VIII, IPMC Section 307.5 Dumpster Enclosures.**

Examples for 3 Yard Containers on Wheels

Examples for 6 Yard Containers

1 ½ Times Size of Dumpster

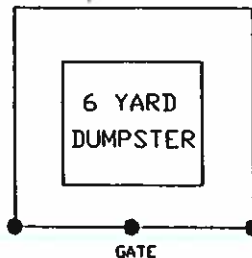
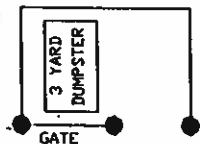

2 Times Size of Dumpster

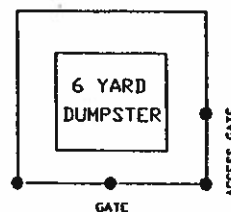
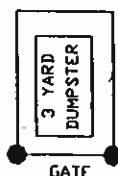
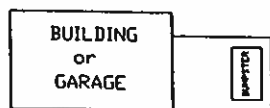
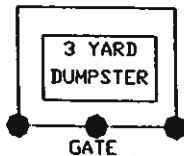



How to Read Your Plat of Survey

LOT 1 IN BLOCK 1 IN TINLEY PARK VILLAS, A SUBDIVISION IN THE WEST 1/2 OF SECTION 30, TOWNSHIP 36 NORTH, RANGE 15 EAST OF THE THIRD PRINCIPAL MERIDIAN, IN COOK COUNTY, ILLINOIS.

(sample description)

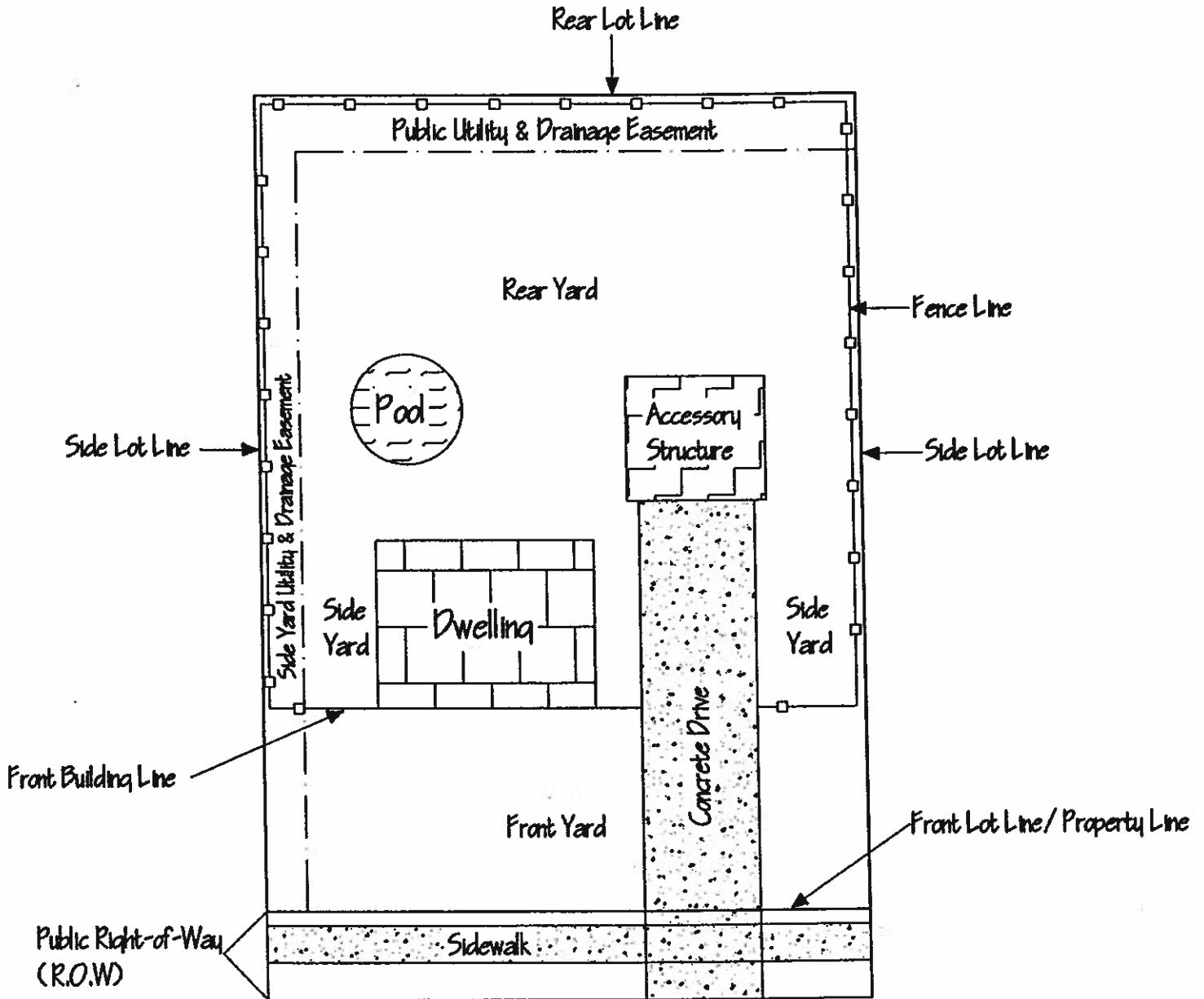

Contact Tinley Park Building & Planning Department at
(708) 444-5100 for further questions



How to Read Your Corner Lot Plat of Survey

LOT 1 IN BLOCK 1 IN TINLEY PARK VILLAS, A SUBDIVISION IN THE WEST
1/2 OF SECTION 30, TOWNSHIP 36 NORTH, RANGE 13 EAST OF THE
THIRD PRINCIPAL MERIDIAN, IN COOK COUNTY, ILLINOIS.

(sample description)

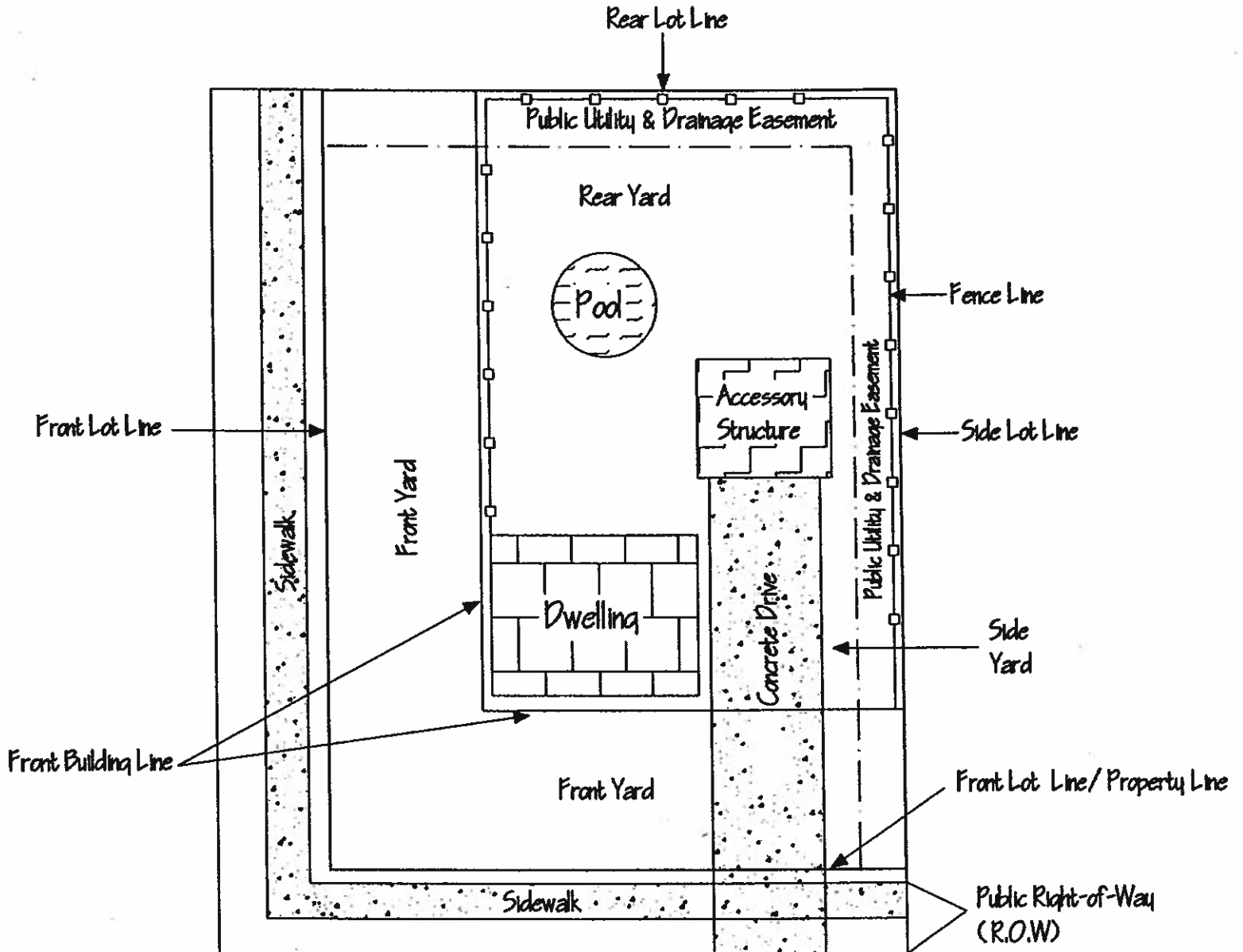

Contact Tinley Park Building & Planning Department at
(708) 444-5100 for further questions