

# RESIDENTIAL FENCE

Waterloo Planning Department 715 Mulberry Street Waterloo IA 50703 319-291-4366  
www.cityofwaterlooia.com

## Visibility Triangle

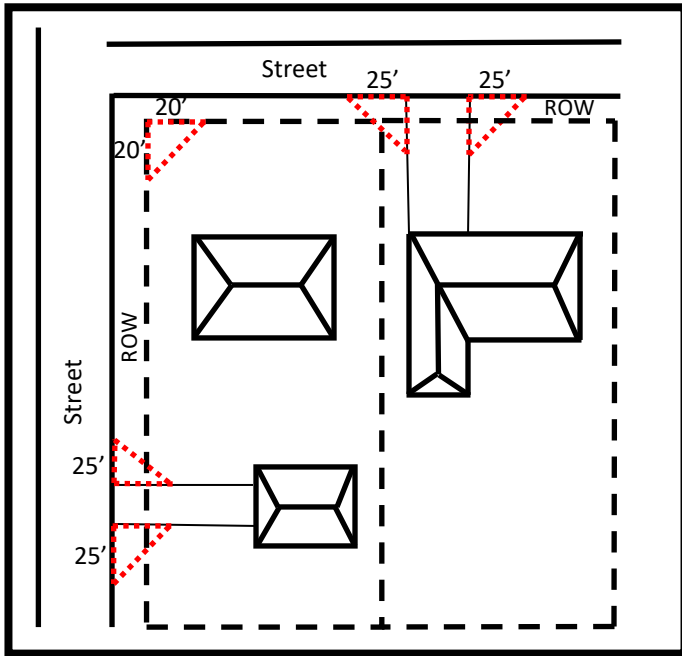

- A Building Permit is required to build a fence over 4' in height.
- Fences can be located up to the property line, but shall not be over the property line or on abutting property.
- Maximum Height in a required Front Yard: 4'
- Maximum Height in a Rear Yard or Side Yard: 8'
- A 25' triangular area for visibility purposes is required for any solid fence at the intersection of a street and a driveway or alley, measured from the edge of the street.
- A 20' triangular area for visibility purposes is required for any solid fence at the intersection of two streets, measured from the property line.
- Property owners are responsible for knowing the location of their lot lines.

// // // Max Height: 4'   
 \* \* \* \* \* Max Height: 8'  
 - - - Property Lines    ROW: Right-of-way

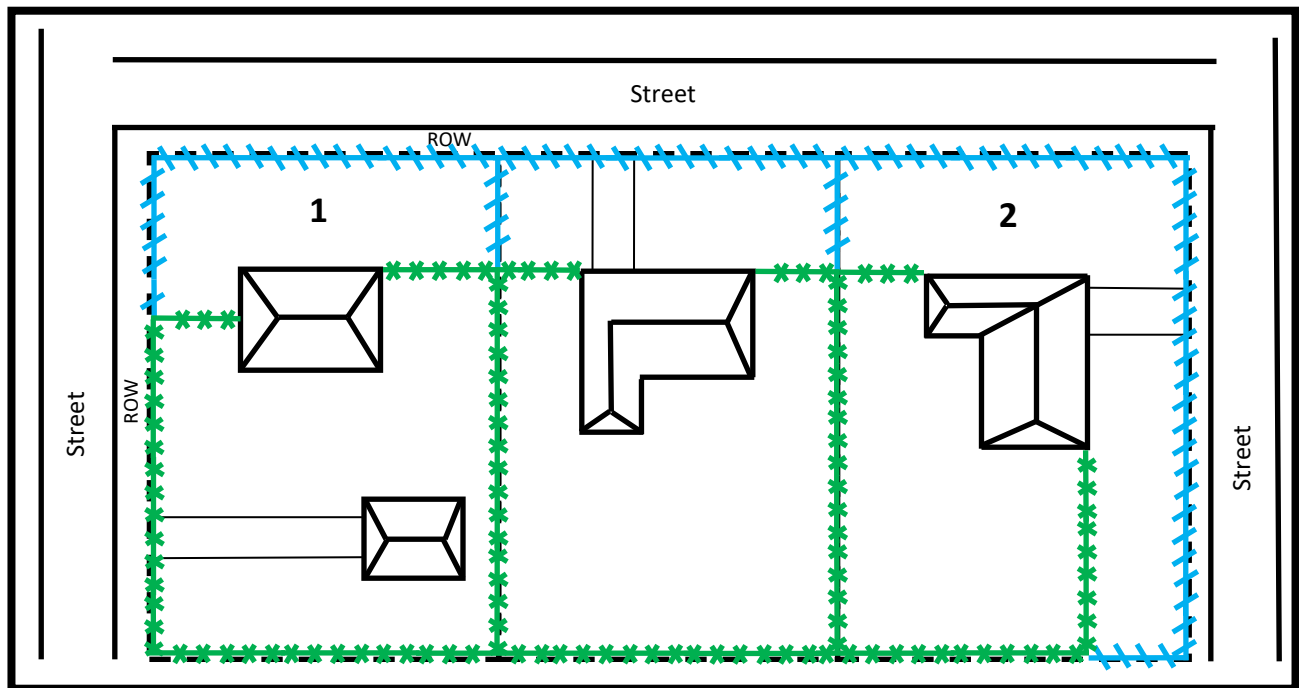

1 = House addressed/facing narrow dimension street frontage.  
2 = House addressed/facing long dimension street frontage.

*This brochure is intended to explain some of the requirements for residential fences. If you have further questions, please contact the Waterloo Planning Department. Please print this brochure in color.*