

This map is for use in administering the National Flood Insurance Program. It does not necessarily identify all areas subject to flooding, particularly from local drainage sources of small size. The **community map repository** should be consulted for possible updated or additional flood hazard information.

Coastal Base Flood Elevations shown on this map apply only landward of 0.0 North American Vertical Datum of 1988 (NAVD 88). Users of this FIRMI should be aware that coastal flood elevations are also provided in the Summary of Stillwater Elevations table in the Flood Insurance Study report for this jurisdiction. Elevations shown in the Summary of Stillwater Elevations table should be used for construction and/or floodplain management purposes when they are higher than the elevations shown on this FIRMI.

Certain areas not in Special Flood Hazard Areas may be protected by **flood control structures**. Refer to Section 2.4 "Flood Protection Measures" of the Flood Insurance Study report for information on flood control structures for this jurisdiction.

Flood elevations on this map are referenced to the North American Vertical Datum of 1988. These flood elevations must be compared to structure and ground elevations referenced to the same **vertical datum**. For information regarding conversion between the National Geodetic Vertical Datum of 1929 and the North American Vertical Datum of 1988, visit the National Geodetic Survey website at <http://www.ngs.noaa.gov/> or contact the National Geodetic Survey at the following address:

To obtain current elevation, description, and/or location information for **bench marks** shown on this map, please contact the Information Services Branch of the National Geodetic Survey at (301) 713-3242, or visit its website at <http://www.ngs.noaa.gov/>.

This map reflects more detailed and up-to-date **stream channel configurations** than those shown on the previous FIRM for this jurisdiction. The floodplains and floodways that were transferred from the previous FIRM may have been adjusted to conform to these new stream channel configurations. As a result, the Flood Profiles and Floodway Data tables in the Flood Insurance Study Report (which contains authoritative hydraulic data) may reflect stream channel distances that differ from what is shown on this map.

Please refer to the separately printed **Map Index** for an overview map of the county showing the layout of map panels; community map repository addresses; and a Listing of Communities table containing National Flood Insurance Program dates for each community as well as a listing of the panels on which each community is located.

If you have **questions about this map** or questions concerning the National Flood Insurance Program in general, please call **1-877-FEMA MAP**(1-877-336-2627) or visit the FEMA website at <http://www.fema.gov/business/nfip/>.

Provisionally Accredited Levee Notes to Users: Check with your local community to obtain more information, such as the estimated level of protection provided (which may exceed the 1-percent-annual-chance level) and Emergency Action Plan, on the levee system(s) shown as providing protection for areas on this panel. To maintain accreditation, the levee owner or community is required to submit data and documentation necessary to comply with Section 65.10 of the IFIR (regulation 19.100, 2010), if the community or owner does not provide the necessary data and documentation or if the data and documentation provided indicate the levee system does not comply with Section 65.10 requirements, FEMA will revise the flood hazard information for this area to reflect de-accreditation of the levee system.

To mitigate flood risk in residual risk areas, property owners and residents are encouraged to take additional measures to help protect themselves and their property from flooding, such as flood insurance and other protective measures. For more information on flood insurance, interested parties should visit the FEMA Website at <http://www.fema.gov/business/nfip/index.shtm>.

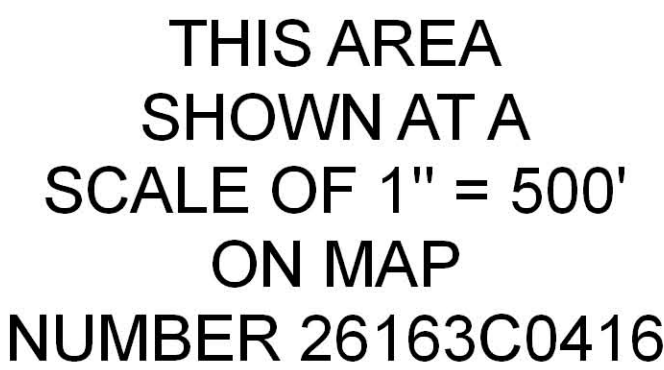
 SPECIAL FLOOD HAZARD AREAS SUBJECT TO INUNDATION BY THE 1% ANNUAL CHANCE FLOOD

The 1% annual chance flood (100 year flood), also known as the base flood, is the flood that has a 1% chance of being equaled or exceeded in any given year. The Special Flood Hazard Area is the area subject to flooding by the 1% annual chance flood. Areas of Special Flood Hazard may include Zones A, AE, AH, AO, AR, A99, V, and VE. The Base Flood Elevation is the water-surface elevation of the 1% annual chance flood.

ZONE A	No Base Flood Elevations determined.
ZONE AE	Base Flood Elevations determined.
ZONE AH	Flood depths of 1 to 3 feet (usually areas of ponding); Base Flood Elevations determined.
ZONE AO	Flood depths of 1 to 3 feet (usually sheet flow on sloping terrain); average depths determined. For areas of alluvial fan flooding, velocities also determined.
ZONE AR	Area of special flood hazard formerly protected from the 1% annual chance flood event by a flood control system that was subsequently deteriorated. ZONE AR indicates that the former flood control system is being restored to provide protection from the 1% annual chance or greater flood.
ZONE A99	Area to be protected from 1% annual chance flood by a Federal flood protection system under construction; no Base Flood Elevations determined.
ZONE V	Coastal flood zone with velocity hazard (wave action); no Base Flood Elevations determined.
ZONE VE	Coastal flood zone with velocity hazard (wave action); Base Flood Elevations determined.

The floodway is the channel of a stream plus any adjacent floodplain areas that must be kept free of encroachment so that the 1% annual chance flood can be carried without substantial increases in flood heights.

ZONE X Areas of 0.2% annual chance flood; areas of 1% annual chance flood with average depths of less than 1 foot or with drainage areas less than 1 square mile; and areas protected by levees from 1% annual chance flood.





ZONE X Areas determined to be outside of the 0.2% annual chance floodplain.

ZONE D Areas in which flood hazards are undetermined, but possible.

OTHERWISE PROTECTED AREAS (OPAs)

1% annual chance floodplain boundary

0.2% annual chance floodplain boundary

 Floodway boundary
 Zone D boundary
 CBRS and OPA boundary
 Boundary dividing Special Flood Hazard Areas of different Base Flood Elevations, flood depths or flood velocities
 Base Flood Elevation line and value; elevation in feet*
 Base Flood Elevation value where uniform within zone; elevation in feet*

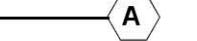
Referenced to the North American Vertical Datum of 1988

 Cross section line
 Transect line
 Geographic coordinates referenced to the North American Datum of 1983 (NAD 83), Western Hemisphere
 1000-meter Universal Transverse Mercator grid values, zone 17
 500-foot grid ticks: Michigan State Plane South Coordinate System, 4801 zone (FIPS502 2113), Lambert Conformal Conic Projection
 Bench mark (see explanation in Notes to Users section of this FIRM panel)
 River Mile
 M1.5

MAP REPOSITORY
Refer to listing of Map Repositories on Map Index

EFFECTIVE DATE OF COUNTYWIDE
FLOOD INSURANCE RATE MAP
PRELIMINARY

EFFECTIVE DATE(S) OF REVISION(S) TO THIS PANEL

For community map revision history prior to countywide mapping, refer to the Community Map History table located in the Flood Insurance Study report for this jurisdiction.

To determine if flood insurance is available in this community, contact your insurance agent or call the National Flood Insurance Program at 1-800-638-6620.

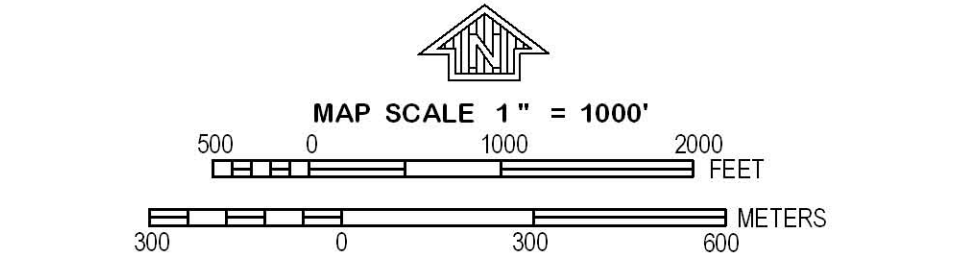

PANEL 0420E

FLOOD INSURANCE RATE MAP

**WAYNE COUNTY,
MICHIGAN
(ALL JURISDICTIONS)**

PANEL 420 OF 575
(SEE MAP INDEX FOR FIRM PANEL LAYOUT)

<u>COMMUNITY</u>	<u>NUMBER</u>	<u>PANEL</u>	<u>SUFFI</u>
GROSSE ILE, TOWNSHIP OF	260227	0420	E
RIVERVIEW, CITY OF	260240	0420	E
TRENTON, CITY OF	260244	0420	E
WYANDOTTE, CITY OF	260246	0420	E

Notice to User: The **Map Number** shown below should be used when placing map orders; the **Community Number** shown above should be used on insurance applications for the subject community.



MAP NUMBER
26163C0420E

EFFECTIVE DATE
PRELIMINARY

Federal Emergency Management Agency